

1866

Jan 17 Petition rec. Witness app'd
Journal C p 605

Apr 6 1st reading of report
Journal C p 664

Apr 7 ordered opened
Journal A p 665

Road

Commencing at S D cor of N E 1/4 of 36 1/2
Sec 14 - 1 N R 42 E to Dry Creek

DIRECTIONS—Place papers on TOP OF RUBBER
Fold ends first then sides Throw the rubber cords
over the ends and package is complete

near Stunby grade thence 5 degrees N of N W
 26 Rods to a stake marked A 6 on Stunby grade
 thence along the grade 20 degrees N of W 62 Rods
 to a stake marked A 7 thence 7 degrees E of N -
~~40 Rods Rods~~ to a stake marked 2 Miles thence
 on same direction 60 Rods to a stake marked A 8
 still on grade thence 10 degrees W of N W 20 Rods
 to a stake marked A 9 on grade thence 20 degrees W of
 N 60 Rods to a stake marked A X on grade thence N
 40 Rods to stake marked A XI thence 20 degrees E
 of north to a stake on S W ^{corner of} R E 14 of S E 17
 Sec 1 T 1 N R 42 E 68 Rods marked A 12 thence E
 46 Rods at variation of 30 degrees to stake marked A 13
 thence 10 degrees E of N E 40 Rods to stake marked
 3 miles thence on same direction 54 Rods to stake
 marked A 14 intersecting Range Line of 42 & 43
 then N on Range Line to $\frac{1}{4}$ corner between Sec 18 & 6 44 Rods
 thence ^N 164 Rods to S E cor of Sec 36 on Range Line
 thence with Range Line 80 Rods N to a stake marked
 4 miles thence on Range Line $\frac{3}{4}$ of mile to N E cor
 Sec 36 thence N on Line $\frac{1}{4}$ mile to stake marked 50

thence $\frac{1}{4}$ mile To $\frac{1}{4}$ corner Between Sec 25 & 30 & 2 n
R 42 & 43 E thence $\frac{1}{2}$ mile on Range Line To N E corner
25 thence 70 Rods N on R Line To a Stake marked
A 15 thence 10 degrees E of N E 10 Rods To stake
marked 6 miles thence on same line 62 Rods To
stake marked A 16 thence 8 degrees W of N 170 Rods
To stake marked A 17 near head of Martins gulch
described in Petition thence N W down gulch 88 Rods To
a stake marked 7 M thence N W down gulch 68
Rods To stake marked A 18 thence N with Gulch
to Dry creek terminus of Road 92 Rods To Pine tree
on the Bank of creek 30 inches in Diameter marked
R.T. Total distance of Road 7 $\frac{1}{2}$ miles

I certify that the above is a correct Report
of survey of the above named Road
this March 2nd 1880

P. H. Swinford Surveyor

P.S. the enclosed Plot is a true Plot of survey

*Sumner
Rebark*

Filed APR 5 1886

at ... o'clock, ... mi...

R. A. Wilson
County

To The Honorable County Court of Union County
 State of Oregon We the undersigned
 petitioners Resident Household of
 Union County State of Oregon having
 within the necessity of the following
 proposed County Road, would respectfully
 ask your honorable Body at the January Term
 to locate a County Road as follows, and your
 petitioners will ever pray. Commencing at the
 SW corner of the NE 1/4 of the NE 1/4 of S 14 T 42 E W 3.
 thence East along said line to the SE corner of the
 NW 1/4 of the NE 1/4 of Section 13, 1 N 24 2 E. Thence north
 on the line between the NW 1/4 and the NE 1/4 of the
 NE 1/4 of S 13 1 N 24 2 E to the foot of the Hill
 thence in a northerly direction along the brow of the
 hill on the west side of the Gulch a distance
 of about four hundred yards to the foot of Stanley
 grade, thence along said grade and road
 bed to the SW corner of the NE 1/4 of the SE 1/4 of S 1-
 1 N - 24 2 E. Thence East on the line between the NE 1/4
 and the SE 1/4 of the SE 1/4 of S 1-1 N - 24 2 E a distance
 of about three hundred yards. Thence in an E direction
 to the Range line between R 4 1/2 and R 3 E. Thence
 north on said Range line a distance of two miles,
 thence northwardly following the divide on the
 most practicable route to the head of Martins
 Gulch. Thence down said gulch to dry
 creek, and thence terminate.

Memo

J. P. Masterson
 D. S. Moore
 L. J. Cole
 R. M. Gray
 J. W. Barton
 John Wilson
 W. J. Bennett
 W. L. Gray

Minutes

Wm. Main
 J. M. Lee
 J. A. Miller
 James Ford
 J. H. Stanley
 J. W. Gerber
 C. D. Boardman
 W. J. Alford

I Henry Gerber being first duly sworn
depose and say that on the 30th day of
November 1885 I posted notices of the
within described road according to
law as follows, One at the beginning
of said proposed road, One near
the terminus, And one about
the centre of said proposed road,
And on same date viz Nov. 30th 1885
I sent one notice ^{to} the County Clerk
of Union County, Oregon, to be
posted on Court House door

Henry Gerber

Subscribed and sworn to before
me this 2^d day of January 1886
Gas A Hunter
Justice of the Peace

State of Oregon }
County of Union }⁰⁰ I B. F. Wilson
being first duly sworn say
that I posted a notice which
is a true and correct copy
of the notice hereto attached
on the Court house door on
the 11th day of December A
D 1885 and that the same
has remained so posted for
the period of 30 days prior
hereto.

Subscribed & sworn }
to before me this }
12 day of Jan }
A.D. 1886 }

B. F. Wilson

A. C. Craig
Co. Judge

I hereby given that a petition will be presented at the January term 1886 of the County Court of Union County State of Oregon by the undersigned Citizens of Union County, asking the location of a County Road here after described, and that we are hereby authorizing in the vicinity of the proposed Road commencing at the SW corner of the NE 1/4 of the NE 1/4 of S 14 T 1 N R 42 E to the SE corner of the NE 1/4 of the NE 1/4 of S 14 T 1 N R 42 E Wm, thence east along said line to the SE corner of the NE 1/4 of the NE 1/4 of S 14 T 1 N R 42 E Wm, thence north on the line between the NE 1/4 and the NE 1/4 of the NE 1/4 of S 13 T 1 N R 42 E Wm, to the foot of the hill. Thence in a northwesterly direction, along the brow of the Hill on the west side of the gulch a distance of about four hundred yards to the foot of Gaudley's Gulch. Thence along said grade and road bed to the SW corner of the NE 1/4 of SE 1/4 of S 1 T 1 N R 42 E Wm, thence east on the line between NE 1/4 and SE 1/4 of the SE 1/4 of S 1 T 1 N R 42 E a distance of about three hundred yards. Thence in a north east direction to the

the junction between the said NE 1/4 and SE 1/4 of S 1 T 1 N R 42 E Wm, thence north on said line a distance of two miles. Thence northwesterly following the divide on the most practicable route to the head of Martine Gulch. Thence down said gulch to Dry Creek and thence terminate.

- | | | |
|----------------|---|----------------|
| James Moore | } | Wm Palmer |
| Wm Moore | | B. M. See |
| James J. Cook | | J. B. Miller |
| John Gray | | James Alford |
| R. M. Gray | | John A. Smith |
| P. W. Bartlett | | Lewis Barber |
| John Nelson | | E. D. Boardman |
| J. G. Stubbins | | W. S. Alford |
| W. M. Bennett | | |
| W. C. Gray | | |

Notice

Filed JAN 12 1886
at o'clock ^{PM}
R. A. Wilson
County Clerk

*Noted
L. Cooper*

Know all men by these presents
that we Henry Gerber and John C
Standley are held and firmly
bound unto Wasco County, Oregon
in the penal sum of One hundred
dollars.

The condition of the above bond is
such that if the County Court of
above named County and State
shall locate and establish the
within described County road
the petition for which, will be
presented to above named court
at the regular session in January
1886. Then this bond to be null
and void otherwise to have full
force and effect. Henry Gerber.
This Jan 2^d 1886 John C. Standley

Subscribed to in
presence of
J A Hunter

Filed JAN 7 1886
at ... o'clock, ... min. ... m.
R. F. McLeod
County Clerk:

Standings Run at March 3^d
We the undersigned being⁵⁶
appointed by the County
Court of Union County
State of Oregon on the petition
of J. A. Masterson et al. make
the following Report -

We met on the 25 day of
Feb 1886 as ordered by the
Court, and the Surveyor
not being present, we adjourned
until the 26th of Feb 1886 there
yet being no Surveyor, we met
and adjourned until the
first of March 1886 when
we met pursuant to adjournment
and after first being duly
qualified we in company
with the Surveyor, proceeded

to him, and lay out
the proposed County Road
according to the Petition
and no further.

Recommend the Road be granted
and ordered opened and
established, as it is on
good ground to build
a Road or, and of great
utility to this immediate
vicinity and all the Settlers
on or near the same, and
we further think the necessity
justifies all the expense
that would be necessary
for its opening.

L. W. Richardson

F. P. Krick

J. H. McCallin

Sworn to and subscribed

Before me March 2nd 1886

R. H. Saunders J. P.

Viewers Report

*Read parish line again
Th 6 1886*

Filed APR 5 1886

at ... o'clock, ... min. ... m.

R A Wilcox
County Clerk.

Sixth Judicial Day

Tuesday Jan-12-1886

in this Court for the appointment of said E. E. Cates Constable of said Union Precinct, Union County Oregon. And it appearing to the Court that there is only one Constable in said precinct and that said precinct is entitled to have two Constables and it further appearing that said E. E. Cates is a competent and fit person to be so appointed It is therefore hereby ordered that said E. E. Cates be and he is hereby appointed Constable in and for Union Precinct Union County Oregon and that he enter upon the discharge of his duties therein immediately upon his filing a good and sufficient bond with the Clerk of this Court and his taking the oath of office and that he serve as such Constable until successor is elected and qualified.

On the matter of a County road petitioned for by J. A. Masterson et al

now at this time this matter comes on to be heard upon the petition of J. A. Masterson and six teen others heretofore filed herein praying for the location of a County road as follows to-wit: commencing at the S. W. corner of the N. E. 1/4 of the N. E. 1/4 of Section 14 1 N. R. 42 E. N. W. thence East along said line to the S. E. corner of the N. W. 1/4 of the N. E. 1/4 of Section 13 1 N. R. 42 E. thence North on the line between the N. W. 1/4 and the N. E. 1/4 of the N. E. 1/4 of S 13 1 N. R. 42 E. to the foot of the hill; thence in a north only direction along the brow of the hill on the west side of the gulch a distance of about four hundred yards to the foot of Staudled's grade thence along said grade and road bed to the S. W. corner of the N. E. 1/4

Sixth Judicial Way

Tuesday Jan. 12-1886

of the S E $\frac{1}{4}$ of S. 1-1 N. R. 42 E. thence East on the line between the N E $\frac{1}{4}$ and the S E $\frac{1}{4}$ of the S E $\frac{1}{4}$ of Sec. 1-1 N. R. 42 E. a distance of about three hundred yards, thence in a N. E. direction to the Range line between R. 42 and 43 E. thence North on said Range line a distance of two miles thence Northerly following the divide on the most practicable route to the head of Martins Gulch, thence down said gulch to dry creek and there terminate. And it appearing to the Court that due and legal notice of the pendency of this proceeding had been given as by law required in such cases made and provided, that more than twelve of said petitioners are resident householders residing in the vicinity of the proposed road and that a good and sufficient bond has been filed herein. It is therefore hereby ordered that J. H. McCubbin, Geo. Richardson and F. P. Creek be and they are hereby appointed viewers and P. H. Saunders Surveyor to view survey and report upon said proposed road and it is further ordered that they meet at the residence of John L. Staudley on the 20th day of January 1886 at 10 O'clock A. M. and duly qualify before entering upon the discharge of their duties in this behalf.

On the matter of a
proposed County road
petitioned for by
Henry Miller et al

Now at this time this matter comes on to be heard upon the petition of Henry Miller and nineteen others filed herein praying for the location

First Judicial Day Monday Apr. 5 1886

Precinct Union County Oregon for the period of One year from this date.

therefore court adjourned till tomorrow morning at nine o'clock.

Second Judicial Day Tuesday Apr. 6 - 1886

Court met pursuant to adjournment present the same Judge and officers as on yesterday

Due proclamation of the opening of court having been made the journal of yesterday's proceedings was read and approved and is now here signed

County Judge

therefore the following proceedings were had to wit:

In the matter of the proposed road petitioned for by J. A. Masterson et al.

Now at this time comes on for hearing the views and surveyors reports heretofore filed here in which viewers and surveyor were heretofore appointed by this court to view survey and lay out said road and the said reports are read in open court for the first time and in accordance with the provisions of the statute in such cases made and provided. It is ordered that the said reports be

Second Judicial Day Tuesday April 6-1880

and they are hereby laid over for another reading on another day of this term.

Thereupon Court adjourned till tomorrow morning at nine o'clock

Third Judicial Day Wednesday Apr. 7-1880

Court met pursuant to adjournment present the same Judge and officers as on yesterday.

Due proclamation of the opening of Court having been made the Journal of yesterday's proceedings was read and approved and is now here signed

A. Blair
County Judge

Thereupon the following proceedings were had to wit:

In the matter of the
proposed county road }
petitioned for by J. N. }
Masterson et al }

Now at this time this matter comes on for hearing and for a second reading of the views and surveys reports which said reports are read in open Court the second time and it appearing to the Court that said reports have been read on two different days of this term of this Court and that the proceedings herein have been regular and according to law and that there has been no sufficient remonstrance filed herein it is therefore

third judicial day Wednesday Apr. 7 - 1886

herby ordered that the said views and
surveyors report be entered of record
and the said road established and
opened according to law.

Viewers report

We the undersigned viewers appointed by
the County Court of Union County State
of Oregon on the Petition of Jas. A.
Masterson et al make the following report
we met on the 25th day of February 1886
as ordered by the court and the surveyor
or not being present we adjourned
until the 26th of Feb 1886 there yet being
no surveyor we met and adjourned
until the first day of March 1886 when
we met pursuant to adjournment and
after first being duly sworn qualified
we in company with the surveyor proceed-
ed to view and lay out the proposed
county road according to the petition
and we do further recommend the
road be granted and ordered opened
and established, as it is on good ground
to build a road on and of great
utility to this immediate vicinity
and all the settlers on or near the same
and we further think the necessity
justifies all the expense that would
be necessary to its opening.

G. W. Richardson

F. P. Krick

J. H. McComb

sworn to and subscribed before
me March 12th 1886

P. H. Saunders J. P.

Surveyors report

Be it remembered that in accordance
with an order of the Union County Court
of the county of Union State of Oregon
that I P. H. Saunders appointed to survey

Third judicial Day

Wednesday April 7, 1886

a road petitioned for by James A. Mason did on the above named day begin survey of the said road as shown me by J. H. McCubbin, Geo. Richardson and J. P. Krick appointed reviewers by the above named court, they being duly sworn by me to faithfully perform the duties of reviewers and chain carriers flagman &c. and P. C. Rochester as marker commencing at the south west corner of the North East quarter of North East qr. of section 14 Township one north of Range 12 East at a stake duly marked R. and rounded, thence East one mile to a stake and ground duly marked 1 N. and N. 1. thence N. at 21. de v. 34 rods to a stake marked A. 11 thence 23 degrees E. of N. 26 rods to a stake marked A. 11. thence 8 degrees E. of N. 92 rods to a stake marked A. 4. thence 22 degrees W. of N. 32 rods to a stake marked A. 5 - near Stanley grade, thence 5 degrees W. of N. N. 26 rods to a stake marked A. 6 on Stanley grade, thence along the grade 20 degrees N. of W. 62 rods to a stake marked A. 7 thence 7 degrees E. of W. 48 rods to a stake marked two miles thence on same direction 60 rods to a stake marked A. 8 still on grade thence 10 degrees W. of N. N. 20 rods to a stake marked A. 9 low grade thence 26 degrees W. of W. 60 rods to a stake marked A. X on grade thence N. 46 rods to stake marked A. XI thence 26 degrees E. of north to a stake on S. W. Corner of N. E. quarter of S. E. quarter section 1 Township one north of R. 12 E. 68 rods marked A. 12, thence E. 46 rods at variation of 30 degrees to stake marked A. 13 thence 10 degrees East of North East 40 rods to stake marked 3 miles thence on same direction

Third judicial Day Wednesday Apr. 7-1886

34 rods to stake marked A. 14 intersecting Range line of 42 & 43 then North on Range line to $\frac{1}{4}$ corner between sec. one & six 144 rods thence N. 164 rods to S. E. Cor. of sec. 36 on Range line, thence with range line 80 rods N. to a stake marked 4 miles thence on Range line $\frac{3}{4}$ of mile to N. E. corner section 36 thence N. on line $\frac{1}{4}$ mile to stake marked 5 M. thence $\frac{1}{4}$ mile to $\frac{1}{4}$ corner between sections 25 and 30 Township two north of Range 42 and 43 East. thence $\frac{1}{2}$ mile off Range line to N. E. corner section 25. thence 70 rods North on R. line to a stake marked A. 15 thence 10 degrees E. of N. E. 10 rods to stake marked 6 miles thence on same line 62 rods to stake marked A. 16 thence 8 degrees W. of N. 170 rods to stake marked A. 17 near head of Martins gulch described in petition thence N. N. down gulch 85 rods to a stake marked 7 miles thence N. N. down gulch 68 rods to stake marked A. 18 thence N. with gulch to dry creek terminus of road 92 rods to Pine tree on the bank of creek 30 inches in diameter marked R. T. Total distance of road $7\frac{1}{2}$ miles.

I certify that the above is a correct report of survey of the above named road this March 27 1886

P. H. Saunders Surveyor

P.S. the enclosed plat is a true plat of survey

Third Judicial Day

Wednesday Apr. 7-1886

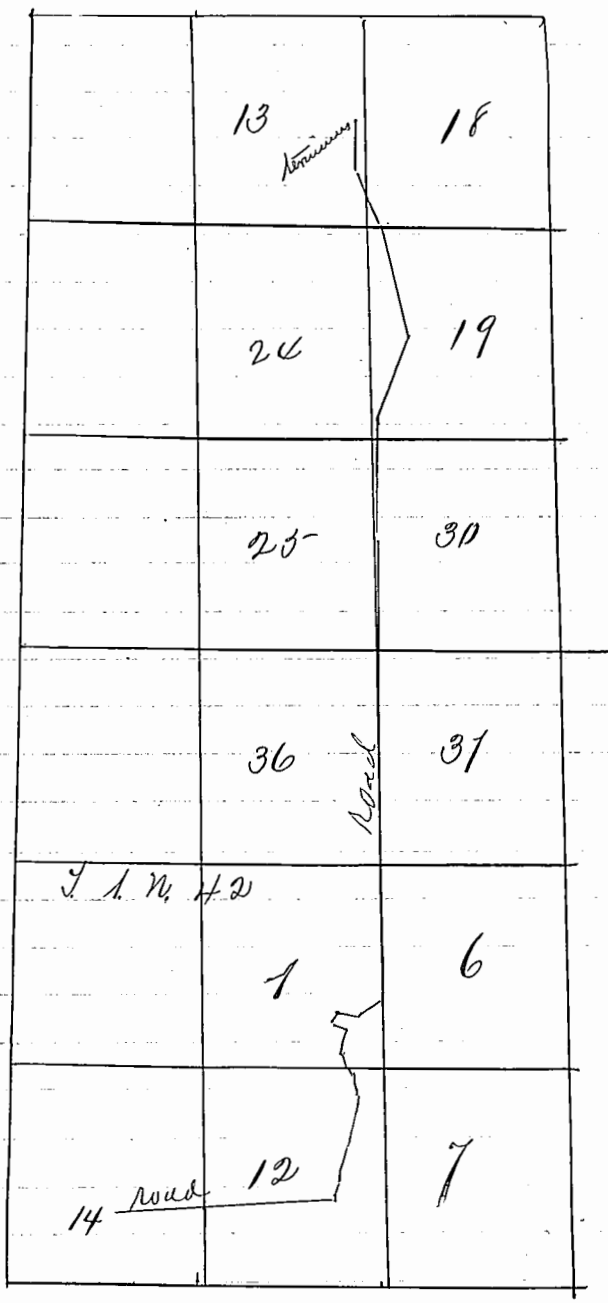

This is a true plot
P. N. Saunders

In the matter of the
Proposed county road
petitioned for by E. P.
Crawston et al-

now at this time
this matter comes on for hearing
upon the petition of E. P. Crawston and
others praying for the location of a
county road as follows to-wit:
Commencing at a point on the present
county road (aforesaid) S. 66° E. 50 rods