

No 16 E

Susan Williamson
no et al

S E Seal et al

POSTAGE WILL BE PAID BY ADDRESSEE
NO. 16 E
SUSAN WILLIAMSON
S E SEAL
ET AL

No 371

Petitioned for by
W D Arnold et al

Commencing at Crowell
Bridge ~~across~~ Grand Ronde
River and terminating at
Kamela Oregon

Petition Filed March
1891 - Viewers app Jul E

Page 328

Report of Viewers and Road
Ordered opened Jul E

Page 390

To the Hon. The County Court of the State of
Oregon for Union County.

Now comes John Predmore, and offers and tenders to the Court
for the benefit of the County, and the traveling public;
That for the consideration of the sum of Six Hundred dollars,
(\$600.00) in coin or its equivalent, he will sell and transfer
to the County by deed the right of way for a County road,
60 feet wide, the present grade to be the center of the 60 feet,
except where the said grade is within less than 30 feet of the
right of way of the O.R. & N.Co.'s railway, and at such places, the
said 60 feet to extend from the said right of way of the said
railway; beginning at the point where the present travelled
County road crosses the said railroad, on the land of the said Pr
Predmore on Grande Ronde River in this County, and extending thence
easterly along the line of the said right of way of the said
railway, on the South side of the said railway right of way,
on the line of, and including the Grade and road bed recently
constructed by the said Predmore, to the point where the same
will intersect the present travelled county road again at or
near the point where the same recrosses the said railway right
of way. And the said Predmore hereby guarantees that he is
the owner thereof, and has right to sell and convey the same,
and that ~~the~~ part of the said grade that has been recently,
prepared by him, and included in this offer is on the right of
way of the said ~~right of way of the said~~ railway.

Union, Oregon,
July 31st. 1892.

John Predmore

attest
R. E. Allen

A strip of land 100 feet wide being fifty feet in width on each side of and parallel with the center line of the main track of the C. & N. Company Railroad as the same is shown out and located over and across the lands of the said John Pedersen situated in Union County + + + The above conveyed lands for right of way within the cultivated fields on said lands shall be and is hereby limited to fifty feet entire width = Said Company also hereby agrees to rebuild the Road on said lands

James Owen
County Clerk

RECORDED

Continued for the term

In the matter of the Proposal of
John Redmore to sell to the County the
right of way and grade for County
road - through Grande Ronde Canyon.

This matter having been continued from
last term for further consideration and
the said grade and proposed right of
way having been examined and
found to be within the limits of
the right of way already conveyed
by said John Redmore to the O.R. & N.
Railway Company for its Railway
and grade - and the said Railway
Company having stipulated and agreed
as a part of the consideration for said
conveyance, to rebuild the road on
said Redmore's land - at its own
expense - Now therefore it is hereby
considered and ordered that the
proposition of John Redmore to sell to
the said grade and right of way for County
road along said Railway track together
with the petition of Taxpayers asking that
the County Court purchase the same, be
and the same is hereby dismissed

Quinn Co.
for \$600

J. Sanders
W. D. Arnold County
P. J. Brown

321

321

Field Notes of the survey of County Road from One Mile to Kanabel

Dona Mex 12th 1891

Commencing 1.25 Chs north of the Bridge at One Mile at a Rock
marked R and buried in the center of the Road

Thence	S 74° W	16	Chs to	A 1
"	48°	4	"	" 2
"	57°	4	"	" 3
"	86°	7	"	" 4
"	15°	10	"	" 5
"	11°	6	"	" 6
"	30°	5	"	" 7
"	49°	4	"	" 8
"	78°	6	"	" 9
"	S 57°	5	"	" 10
"	67°	8	"	" 11
"	56°	6.5	"	" 12
"	70°	8.5	"	1 Mile Station
"	70°	20	Chs to	A 13
"	72°	14	"	" 14
"	N 74°	15	"	" 15
"	46°	12	"	" 16
"	58°	11	"	" 17
"	S 73°	8	"	2 Mile Station
"	75°	9	"	A 18
"	68°	22	"	" 19
"	N 79°	6.5	"	" 20
"	15°	9	"	" 21
"	S 89°	9.5	"	" 22
"	N 63°	2.5	"	" 23
"	80°	2.5	"	" 24
"	41°	4	"	" 25
"	64°	10	"	" 26
"	76°	6	"	3 Mile Station
"	76°	2	"	A 27
"	N 60°	7	"	" 28
"	82°	5	"	" 29
"	74°	4	"	" 30
"	21°	29	"	" 31
"	84°	19	"	" 32
"	West 14°	"	"	4 Mile Station
"	"	1.3	"	A 33
"	N 74°	9	"	" 34
"	46°	10	"	" 35
"	S 87°	8	"	" 36
"	84°	12	"	" 37
"	68°	11	"	" 38
"	61°	11	"	" 39
"	25°	6	"	5 Mile Station
"	28°	25	"	A 40
"	63°	7	"	" 41
"	86°	7	"	" 42
"	45°	3	"	" 43
"	87°	21	"	" 44
"	80°	13	"	" 45
"	69°	4	"	6 Mile Station
"	60°	17	"	A 46
"	N 46°	8	"	" 47
"	S 86°	10	"	" 48
"	N 68°	5	"	" 49
"	34°	40	"	7 Mile Station
"	54°	4.5	"	A 50
"	26°	3	"	" 51
"	67°	13	"	" 52
"	47°	6.5	"	" 53
"	82°	5	"	" 54
"	S 68°	8	"	" 55
"	N 17°	40	"	8 Mile Station at the 1/4 Sec corner between Sec 25 in Range 36 and 30 in Range 37

Thence	N 22°	Chs to	A 57
"	S 57°	8	" " 58
"	N 60°	12	" " 59
"	S 52°	11	" " 60
"	N 60°	8	" " 61
"	41°	9	" " 62
"	S 66°	8	" " 63
"	N 58°	2	" " 9 Mile Station
"	58°	3	" " A 64
"	44°	19	" " 65
"	15°	9	" " 66 Crossing the meridian line between Secs 25 & 26
25 Chs south of the Sec corner between Secs 25, 24, 25, and 26			

1111711

880	M	9	Chs	To	A	67
20	"	2	"	"	"	68
90	E	7	"	"	"	69
68	M	7	"	"	"	70
66	"	7	"	"	"	71
26	"	5	"	"	"	72
79	"	4	"	"	"	73
160	"	3	"	"	"	74
20	E	9	"	"	"	75
600	M	7	"	"	"	76
380	"	6	"	"	"	77
610	"	8	"	"	"	78
290	"	8	"	"	"	79
440	"	42	"	"	"	80
11 Mile Station 14 Chs south of the Sec corner between Sec 14, 15, 22, 23						
440	"	14	"	"	"	81
390	"	39	"	"	"	82
630	"	15	"	"	"	83
710	"	12	"	"	"	84
710	"	17	"	"	"	84
12 Mile Station 2 Chs south of the 1/4 corner between Sec 15 and 16 in S. 2, S. Range 36						
610	M	30	"	"	"	85
160	"	6	"	"	"	86
620	"	19	"	"	"	87
400	"	8	"	"	"	88
840	"	21	"	"	"	88
760	"	7	"	"	"	89
570	"	19	"	"	"	90
680	"	6	"	"	"	91
820	"	7	"	"	"	92
410	"	7	"	"	"	93
130	"	11	"	"	"	94
130	"	9	"	"	"	94
14 Mile Station						
270	"	7	"	"	"	95
340	"	7	"	"	"	96
370	"	15	"	"	"	97
150	"	5	"	"	"	98
140	E	5	"	"	"	99
380	M	7	"	"	"	100
410	"	25	"	"	"	101
15 Mile Station						
410	"	17	"	"	"	102
740	"	6	"	"	"	103
350	"	12	"	"	"	104
460	"	20	"	"	"	105
560	"	12	"	"	"	106
740	"	13	"	"	"	107
740	"	9	"	"	"	107
840	"	4	"	"	"	108
830	"	3	"	"	"	109
580	"	3	"	"	"	110
570	"	3	"	"	"	111
550	"	7	"	"	"	112
560	"	4	"	"	"	113
860	"	4	"	"	"	114
560	"	4	"	"	"	115
800	"	5	"	"	"	116
850	"	6	"	"	"	117
700	"	2	"	"	"	118
870	"	3	"	"	"	119
870	"	6	"	"	"	120
810	"	3	"	"	"	121
580	"	4	"	"	"	122
700	"	5	"	"	"	122
17 Mile Station						
700	"	2	"	"	"	123
760	"	4	"	"	"	124
790	"	3	"	"	"	125
880	"	12	"	"	"	126
190	"	9	"	"	"	127
460	"	5	"	"	"	128
420	"	8	"	"	"	129
150	"	6	"	"	"	130
280	"	14	"	"	"	131
180	"	4	"	"	"	132
500	"	6	"	"	"	133
410	"	8	"	"	"	134
18 Mile Station						
410	"	4	"	"	"	134
500	"	10	"	"	"	135
580	"	28	"	"	"	135
The terminus of the Road at a Post set						

bearing South 75° E from the 1/4 Sec corner on the west side of Sec 36 T. 15. R. 35 East 1/4 M and distant 2 Chs from said 1/4 Sec corner

J. L. Curtis
Surveyor

Filed April 22nd 1871
James Oliver
Clerk

REPORT OF VIEWERS.



TO THE HONORABLE COUNTY COURT FOR UNION COUNTY, OREGON:

The undersigned viewers heretofore on the 4th day of March, 1891, appointed to view and lay out and alter the proposed County road, of which the survey hereto attached is a true and correct description, as petitioned for by W. D. Arnold, et al, beg leave to report that on the 12th day of March, 1891, in pursuance with said appointment and order, after being duly sworn to faithfully and impartially discharge the duties of said appointment, we proceeded to view out said proposed road for the whole distance thereof, and that in our opinion said proposed road should _____ be laid out _____ and _____ established as a public highway of UNION COUNTY, OREGON. That the same _____ is _____ practicable and would add much _____ to the convenience of the householders residing in the vicinity thereof, we therefore recommend that said proposed road be _____ laid out _____ and _____ declared a public highway of said county.

P. G. Strickland
J. N. Arnold

Filed March 30th 1911
James Oliver
Perk

Petition for County Road

TO THE HONORABLE COUNTY COURT FOR *Union* COUNTY OREGON

The undersigned householders of *Union* County Oregon residing in the vicinity where the

hereinafter described road is proposed to be respectfully petition your Honorable body to lay out alter and establish a County road within said County on the following line or route to wit

Commencing 1/20 Chas north of the bridge at Oro Bell ^{at a} Rock marked

R. buried in the center of the road, _x

<i>Thomas</i>	N	74	W	16	Chs to A1	
"	N	77	W	4	"	2
"	N	59	W	4	"	3
"	N	36	W	2	"	4
"	N			10	"	5
"	N	11	W	6	"	6
"	N	30		5	"	7
"	N	48		4	"	8
"	N	78	"	6	"	9
"	S	82	"	5	"	10
"	S	67	"	8	"	11
"	S	56	"	6	50	12
"	S	70	"	3	50	13
"	S	72	"	14		14
"	N	74		15		15
"	N	46		17		16
"	N	53		11		17
"	S	73				18
"	S	73		9		18
"	S	67		22		19
"	N	79		5	50	20
"	N	13		9		21
"	S	89	W	9	50	22
"	N	63	W	2	50	23
"	S	85	W	2	50	24
"	S	41	W	4	"	25
"	S	44	"	10	"	26
"	S	76	"	6	"	27
"	N	76		2	"	28
"	N	60	W	7	"	29
"	N	82	W	5	"	29
"	N	74		4	"	30
"	N	21		29	"	31
"	N	84		19	"	32
"				14		33
"				13		33
"	N	74		9	"	34
"				10	"	35
"	S	87		8	"	36
"				12	"	37
"				11	"	38
"				11	"	39
"				6	"	40
"				25	"	40
"				7	"	41
"				7	"	42
"				3	"	43
"				21	"	44
"				13	"	45

1 mile foot

2 mile foot

3 mile station

4 mile station

5 mile station

6 mile station

7 mile station

8 mile station

9 mile station

10 mile station

11 mile station

"				4	"	6 mile station
"				17	"	7
"	N	46		8	"	47
"	S	86		10	"	48
"	N	60		5	"	49
"		34		40	"	50
"				4	0	51
"		26		6	3	52
"		67	W	13		53
"		47		6	50	54
"		32		8		55
"	S	61		8		56
"	N	11		40		57

at the 1/4 Sec corner between Sec 25 and 26, 20 Chs north of the Sec corner

<i>Thomas</i>	S	59		8		57
"	N	60		12		58
"	S	52		11		59
"	N	60		8	"	60
"		40		9	"	61
"	S	66		8		62
"	N	51		2		63
"				3		64
"		44		19		65
"		10		4		66

line between Sec 25 and 26, 20 Chs north of the Sec corner

<i>Thomas</i>	N	81	W	9	Chs	67
"		20		2		68
"		9		1		69
"		68	W	7		70
"				7		71
"		66		5		72
"		26		5		73
"		19		4		74
"		16		3		75
"		2		6	9	76
"		60	W	7		77
"		38		6		78
"		61		8		79
"		29		3		80
"		44		42		81

FILED.

MAR 4 1891

James Oliver
County Clerk

Filed Mar 4. 1891
James Oliver Cook
By J. P. Oliver Deputy
Ct.

STATE OF OREGON,
County of Union. } ss.

I, *P. G. Strickland*

being first duly sworn, say that I posted three several notices, of which the notice hereunto attached is a true and correct copy, in three public places in said County in the vicinity of the proposed road therein described, to-wit: One *One on the Crodell Bridge across Grande Ronde River*, One *at Hilgard on the J.C. M. M. Co's store* and one *at Kamela on Russell's store*

thirty days previous to the presentation of the road petition therein mentioned, to-wit: On the *2* day of *Feb* 18 *91*, and that thereafter and thirty days previous to the presentation of said road petition therein mentioned, to-wit: On the _____ day of _____ 18____, I posted a true and correct copy of said notice at the place of holding Court for Union County, Oregon, to-wit: ~~On the front of the Court House door, in the City of Union, in said County and State, and that said notices remained posted thirty days previous to the presentation of said petition as I verily believe.~~

P. G. Strickland

Subscribed and sworn to before me this *4* day of *March* 18*91*.

James Oliver Clerk
J. A. Oliver Deputy

FILLED.

MAR 4 1891

James Oliver
County Clerk.

State of Oregon }
County of Union } 56

I J. R. Oliver being duly sworn say that on the 3 day of February 1891 I posted a true and correct copy of said notice at the place of holding Court for Union County Oregon, to wit: on the front of the Court House door in the City of Union, in said County and State, and that said notice remained posted thirty days previous to the presentation of said petition as I verily believe

J. R. Oliver
Subscribed and sworn to before me
this 4th day of March 1891
Turner Oliver
Clerk

Faint, mostly illegible handwritten text at the top of the page, possibly containing a date or reference number.

FILED.

MAR 4 1891

James Oliver
County Clerk.

Extremely faint and illegible handwritten text covering the lower two-thirds of the page.

Know All Men by these Presents;
That P. G. Strickland of the County of
Union and State of Oregon, am held and
firmly bound unto the said County of Union in
the sum of One Hundred Dollars, the payment
of which well and truly to be made, I bind my-
self, my heirs, executors and administrators
firmly by these presents;

Signed this 4th day of March 1891
Now the condition of the above obligations
is such, that whereas, if the County Road peti-
tioned for by U R Collins and others and
presented at the March Term 1891 of the
County Court of said Union County
the road described in the notice of petition
hereto attached be located and established
then this obligation to be void, otherwise to
remain in full force and virtue in law
P. G. Strickland

State of Oregon } ss
County of Union }

I P. G. Strickland do hereby certify
self that I am worth the sum of \$200 Two
Hundred dollars over and above all liabilities and
property exempt from execution, and that I am
a resident and householder in said County and State
Subscribed and sworn to before me this P. G. Strickland
4th day of March 1891

Turner Oliver Clerk

Shirley, Tenn. March 11th 1891

Dear Mr. [Name]

I have your letter of the 10th and am glad to hear

from you and hope you are well.

I have not had time to write you more fully

but will do so as soon as possible.

Very truly yours,

FILED.

MAR 4 1891

James Oliver
County Clerk.

10th March 1891

Received of [Name] the sum of [Amount]

for [Purpose]

and the receipt is hereby acknowledged.

Witness my hand and seal this 4th day of March 1891.

James Oliver

County Clerk.

Subscribed and sworn to before me this 4th day of March 1891.

[Signature]

Notary Public.

My commission expires [Date]

Witness my hand and seal this 4th day of March 1891.

[Signature]

Notary Public.

My commission expires [Date]

Witness my hand and seal this 4th day of March 1891.

[Signature]

Notary Public.

My commission expires [Date]

Witness my hand and seal this 4th day of March 1891.

[Signature]

Notary Public.

My commission expires [Date]

79°	16	13	1	74-	10 s of station
20	20	9	1	76-	
60	20	7	1	77-	
30	30	6	1	78-	
65	30	8	1	79-	
29	40	8	1	80-	
44	44	42	1	11	1/4 mile station 14

Ch. S. of Sec corner between Secs 22 and 23
 Thence N 44 W 14 chs to A 81

39	39	82			
63	40	83			
71	12	84			12 mile station
71	17	85			A 84 to 1/4 mile station

of the 1/4 sec corner between Secs 15 and 16 in Range 36 E
 Thence N 61 W 30 chs to A 85

16	6	86			
62	19	87			
40	8	88			13 mile station
34	21	89			A 19

76	7	90			
37	19	91			
68	6	92			
82	7	93			
41	9	94			

13	11	95			14 mile station
13	9	96			A 95
27	7	97			96
34	7	98			97

37	15	99			
15	5	100			19
14	5	101			100
33	7	102			101

46	20	103			15 mile station
41	17	104			A 102
74	6	105			104
31	12	106			105

46	20	106			
74	13	107			16 mile station

Cross south line of Sec 31 in Range 36 East 3 Chs East of
 the 1/4 sec corner
 Thence N 14 W 9 chs to A 107

84	4	108			
53	13	109			
58	3	110			
51	3	111			
35	7	112			
56	4	113			
86	4	114			
56	4	115			
80	5	116			
80	6	117			
70	7	118			
57	3	119			
57	6	120			
81	3	121			
81	3	122			
81	3	123			
70	5	124			17 mile station
76	2	125			A 1
76	4	126			37
79	3	127			20
58	12	128			126
19	9	129			17
26	5	130			127
26	5	131			19
70	5	132			130
81	4	133			131
81	4	134			132
81	4	135			133

of the Road at a stake set bearing S 75° East
 from the 1/4 sec corner on the west side of Sec 36
 in Range 36 East 1/4 mile and
 distant 2 chs from said 1/4 sec corner.

Names: R. R. Collins

Names

R R Collins

J M Lafferty

J. C. Collins

D H Mc Watters

~~W. G. Lawrence~~

Frank Childers

William Orr

A. Matthews

J. A. Shaper

J. J. Thompson

W. G. Lawrence

C. C. Lewis

J. M. Lafferty

J. H. Russell

A. C. Hall

W. D. Smith

Alex Thompson

W. M. Smith

W. M. Smith

Names

J. H. Russell
J. M. Lafferty

Mr J. H. Orr County Clerk

Please post & oblige

J. G. Jackson

F. L. H. D. A.

MAR 4 1891

James Oliver

County Clerk

FILLED

MAR 4 1951

James O'Brien
County Clerk

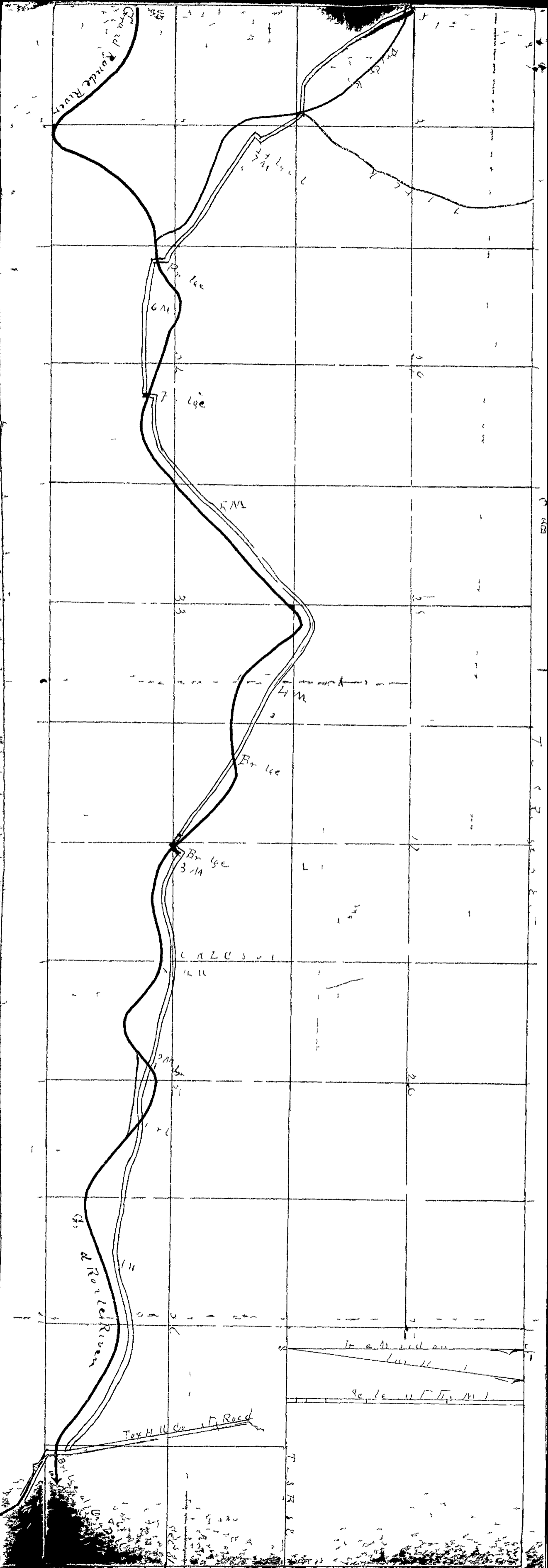

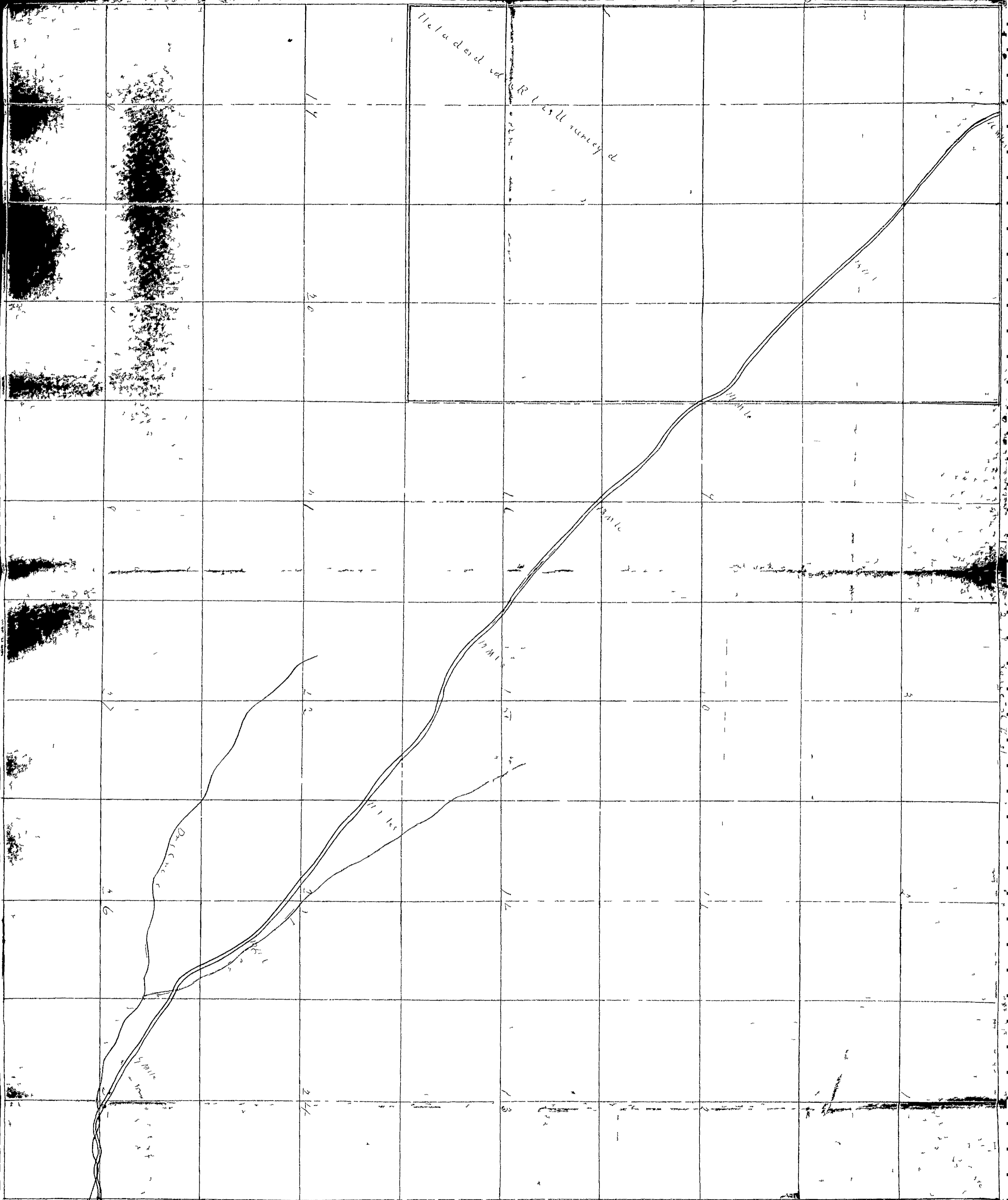

The land was
R. L. L. survey d

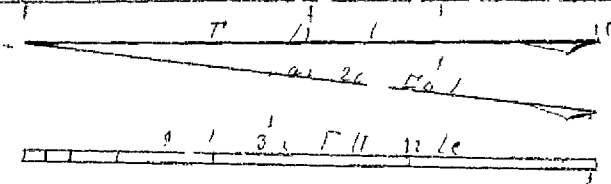

8 miles

4 6

Dr. L. L. L.

5 miles

2 1/4

2 2

2 1

2 0

1 4

1 1/4 mile

1 1/2 mile

1 1/4 mile

1 1/2 mile

1

3

2

7

8

9

First Judicial Day Wednesday March 4th 1891

eration would be made to this Court at the present session of this Court; and that the notices so posted were in due form and duly signed by the petitioners, and that a bond for the cost of this proceeding has been duly given.

It is therefore ordered, that James H. Morton, James Graham Jr. and John Elliott be appointed Viewers of said road, and that J. L. Curtis be appointed surveyor of said road, and that they meet at Elgin on the 16th day of March 1891 at the hour of 10 o'clock A.M. and after qualifying, to view, survey and lay out said road according to law.

In the Matter of County }
Road petitioned for by }
W. D. Arnold et al }

Comes now W. D. Arnold one of the petitioners for the above named proposed County road, and presents to the Court the petition of himself and others praying for the location and establishment of a County road described as follows to wit:

Commencing 1.25 chs north of the bridge at Cro Dell at a rock marked R. buried in the center of the road

Thence	S	74° W	16 Chs	to a	1
"	N	82° "	4 "	" "	2
"	N	59° "	4 "	" "	3
"	N	36° "	2 "	" "	4
"	"	"	10 "	" "	5
"	"	11° W	6 "	" "	6
"	"	30° "	5 "	" "	7
"	"	48° "	4 "	" "	8
"	"	78° "	6 "	" "	9
"	S	82° "	5 "	" "	10
"	S	67° "	8 "	" "	11
"	"	56° "	6.50 "	" "	12
"	"	70° "	3.50 "	" "	1 mile post
"	"	70° "	20 "	" "	a 13
"	"	72° "	14 "	" "	" 14
"	N	74° "	15 "	" "	" 15
"	"	46° "	12 "	" "	" 16
"	"	53° "	11 "	" "	" 17
"	S	73° "	8 "	" "	to mile post

First Judicial Day

Wednesday March 4th 1891

Thence	S	73°	W	9	ch	to	a	18
"	"	68°	"	22	"	"	"	19
"	N	79°	"	550	"	"	"	20
"	"	15°	E	9	"	"	"	21
"	S	89°	W	950	"	"	"	22
"	N	63°	"	250	"	"	"	23
"	S	85°	"	250	"	"	"	24
"	"	41°	"	4	"	"	"	25
"	"	44°	"	10	"	"	"	26
"	"	76°	"	6	"	"	"	3 mile station
"	"	76°	"	2	"	"	"	a 27
"	N	60°	"	7	"	"	"	28
"	"	82°	"	5	"	"	"	29
"	"	74°	"	4	"	"	"	30
"	"	21°	"	39	"	"	"	31
"	"	84°	"	19	"	"	"	32
"	"		West	14	"	"	"	4 mile station
"	N	74°	"	13	"	"	"	a 33
"	"	46°	"	9	"	"	"	34
"	"	46°	"	10	"	"	"	35
"	S	87°	"	8	"	"	"	36
"	"	54°	"	12	"	"	"	37
"	"	68°	"	11	"	"	"	38
"	"	61°	"	11	"	"	"	39
"	"	25°	"	6	"	"	"	5 mile station
"	"	25°	"	25	"	"	"	a 40
"	"	63°	"	7	"	"	"	41
"	"	86°	"	7	"	"	"	42
"	"	45°	"	3	"	"	"	43
"	"	87°	"	21	"	"	"	44
"	"	80°	"	13	"	"	"	45
"	"	69°	"	4	"	"	"	6 mile station
"	"	69°	"	17	"	"	"	a 46
"	N	46°	"	8	"	"	"	47
"	S	86°	"	10	"	"	"	48
"	N	63°	"	5	"	"	"	49
"	"	34°	"	40	"	"	"	7 mile station
"	"	34°	"	450	"	"	"	a 50
"	"	26°	E	3	"	"	"	51
"	"	67°	W	13	"	"	"	52
"	"	47°	"	650	"	"	"	53
"	"	32°	"	5	"	"	"	54
"	S	68°	"	8	"	"	"	55

at the 1/4 Sec corner between Sec 25 in Range 36 & 30 in Range 37

Thence			West	22	ch	to	a	57
"	S	59°	"	8	"	"	"	58
"	N	60°	"	12	"	"	"	59
"	S	52°	"	11	"	"	"	60
"	N	60°	"	8	"	"	"	61
"	"	40°	"	9	"	"	"	62
"	S	66°	"	8	"	"	"	63
"	N	58°	"	2	"	"	"	9 mile station
"	"		"	3	"	"	"	a 64
"	"	44°	"	19	"	"	"	65
"	"	15°	"	9	"	"	"	66 cross the meridian line

between Secs 25 & 26, 25 ch south of the Sec corner between Secs 23 24, 25 and 26

Thence	N	88°	W	9	ch	to	a	67
"	"	20°	"	2	"	"	"	68
"	"	90°	E	7	"	"	"	69
"	"	68°	W	7	"	"	"	70
"	"		"	7	"	"	"	71
"	"	66°	"	5	"	"	"	72

First Judicial Day

Wednesday March 4th 1891

Thence N	26°	W	5	chs	to	a	73
"	"	79°	"	4	"	"	74
"	"	16°	"	3	"	"	75 = 10 mile station
"	"	2°	E	9	"	"	76
"	"	60°	W	7	"	"	77
"	"	38°	"	6	"	"	78
"	"	61°	"	8	"	"	79
"	"	29°	"	8	"	"	80
the Sec Cor between Secs 14, 15, 22 and 23							
Thence N	44°	W	14	chs	to	a	81
"	"	39°	"	39	"	"	82
"	"	63°	"	15	"	"	83
"	"	71°	"	12	"	"	12 mile station
1/4 Sec corner between Secs 15, 16 & 21 Range 36 E							
Thence N	61°	W	30	chs	to	a	85
"	"	16°	"	6	"	"	86
"	"	62°	"	19	"	"	87
"	"	"	"	"	"	"	88
"	"	40°	"	8	"	"	13 mile station
"	"	34°	"	21	"	"	a 89
"	"	76°	"	7	"	"	90
"	"	57°	"	19	"	"	91
"	"	68°	"	6	"	"	92
"	"	82°	"	7	"	"	93
"	"	41°	"	9	"	"	94
"	"	13°	"	11	"	"	14 mile station
"	"	13°	"	9	"	"	a 95
"	"	27°	"	7	"	"	96
"	"	34°	"	7	"	"	97
"	"	37°	"	15	"	"	98
"	"	15°	"	5	"	"	99
"	"	14°	E	5	"	"	100
"	"	33°	W	7	"	"	101
"	"	41°	"	25	"	"	15 mile station
"	"	41°	"	17	"	"	a 102
"	"	74°	"	6	"	"	103
"	"	35°	"	12	"	"	104
"	"	46°	"	20	"	"	105
"	"	56°	"	12	"	"	106
of Sec 31 N 1 S Range 36 East 3							
Thence N	74°	W	9	chs	to	a	107
"	S	84°	"	4	"	"	108
"	N	83°	"	3	"	"	109
"	"	58°	"	3	"	"	110
"	"	51°	"	3	"	"	111
"	"	35°	"	7	"	"	112
"	"	56°	"	4	"	"	113
"	"	86°	"	4	"	"	114
"	S	56°	"	4	"	"	115
"	"	80°	"	5	"	"	116
"	N	85°	"	6	"	"	117
"	"	70°	"	7	"	"	118
"	"	87°	"	3	"	"	119
"	"	57°	"	6	"	"	120
"	"	81°	"	3	"	"	121
"	"	58°	"	4	"	"	122
"	"	70°	"	5	"	"	17 mile station
"	"	70°	"	2	"	"	a 123
"	"	76°	"	4	"	"	124
"	"	79°	"	5	"	"	125
"	"	58°	"	12	"	"	126

First Judicial Day Wednesday March 4th 1891

Thence	S 58° W	12	chs	to	a	126
"	" 19° "	9	"	"	"	127
"	" 46° "	5	"	"	"	128
"	" 42° "	8	"	"	"	129
"	N 87° "	5	"	"	"	130
"	" 56° "	14	"	"	"	131
"	" 88° "	4	"	"	"	132
"	" 81° "	6	"	"	"	133
"	" 61° "	8	"	"	"	18 mile station
"	" 61° "	4	"	"	"	134
"	" 50° "	10	"	"	"	135
"	" 38° "	28	"	"	"	the terminus of the road

at a stake set bearing south 75° East from the $\frac{1}{4}$ sec corner on the West side of Sec 36 in T 1 S Range 35 East Will. Mer. and distant 2 chs from said $\frac{1}{4}$ sec corner.

And it appearing to the Court that said petition is signed by more than twelve householders of this County residing in the vicinity of said proposed road, and that said petition properly specifies the place of beginning, intermediate points and place of termination of said road, and it satisfactorily appearing to the Court that notice has been given by advertisement posted at the place of holding Court to wit: at the front of the Court House door in County of Union State of Oregon and also in three public places in the vicinity of said proposed road, to wit: One on the Oro Dell Bridge across Grande Ronde River, One at Hilgard on the J. C. M. M. Co's store and One at Kamela on Russells Store for more than thirty days immediately prior to the presentation of said petition to this Court notifying all persons concerned that application would be made to this Court at the present session of this Court, and that notices so posted were in due form and duly signed by the petitioners and that a bond for the cost of this proceeding has been duly given.

It is therefore ordered that Fred N. Arnold, Wm. Sherod and O. H. Strickland be appointed Viewers of said road, and that J. C. Curtis be appointed Surveyor of said road, and that they meet at Hilgard Oregon on the 12th day of March 1891 at the hour

First Judicial Day

Wednesday March 4th 1891

of 10 o'clock A.M. and after qualifying, to view, survey and lay out said road according to law

In the Matter of the Proposed
County Road petitioned for
By J. C. Oliver et al.

Comes now J. C. Oliver one of the petitioners for the above named proposed County road, and presents to the Court the petition of himself and others, praying for the location and establishment of a County road described as follows to wit:

Commencing at the Union and Summerville road at the S.E. corner of the NW of the NE¹ of Sec 4 T 2 S R. 39 E N M and running West one mile to the SW corner of the NE¹ of the NE¹ of S 8 T 2 S R. 39 E thence West 30 $\frac{1}{2}$ rods to a point on the South line of the NW¹ of the NE¹ of S 8; thence South 80 rods to a point on the line between the N and S halves of S. 8; thence West 129 $\frac{1}{2}$ rods and terminating at the County road at the SW corner of the SE¹ of the NW¹ of S 8 T 2 S R 39 E N M

And it appearing to the Court that said petition is signed by more than twelve householders of this County residing in the vicinity of said proposed road and that said petition properly specifies the place of beginning, intermediate points and place of termination of said road, and it satisfactorily appearing to the Court that notice had been given by advertisement posted at the place of holding County Court, to wit: at the front of the Court House door in County of Union State of Oregon and also in three public places in the vicinity of said proposed road, to wit: One at the beginning of the road nailed on a board nailed to the fence, One at the terminus of the road nailed to a board on the fence and one on the Summerville and Union road near the residence of Samuel Cochran for

First Judicial Day

Wednesday April 8th 1891

of Mrs B Sargent are true, no evidence to the contrary having been filed. It is therefore ordered that the Clerk draw a warrant on the Treasurer in favor of Mrs B Sargent for the said amount, to wit: \$-40

In the Matter of the Road }
petitioned for by W.D. Arnold et al }

This Matter came on to be heard at this time on the report of Viewers and Surveyor heretofore filed herein and said report having been read in open Court as required by law. It is ordered that said report be held for a second reading on some other day of this term of Court.

In the Matter of a Change in }
the Co Road petitioned for by }
Albert Good et al }

Comes now Mrs Lou Mahaffey and presents to the Court a petition for a change in the County Road across her own land at her own expense, to wit: across the NW⁴ of Sec 25 Tps 2 S R 37 E N M. That the present County road running from the South East corner of said North West quarter in a North Westerly direction across said land is a great detriment to her, That the petitioner desires to change said road across said land at her own expense as follows, to wit: Commencing at or near the South East corner of the NW⁴ of Sec 25, thence running in a Northerly direction and intersecting said county road about one quarter of a mile North of the point of commencement proposed and there terminate, The distance would not be materially changed and the change would be a public benefit and no injury to the petitioner. And it appearing to the Court that a good and sufficient Bond for all expenses incurred herein by reason of view or review of said road has been filed. It is therefore ordered that George Ackley, J. R. Killlogg and J. Smith be appointed Viewers of said road and J. L. Curtis be appointed Surveyor of said

Second Judicial Day

Thursday April 9th 1891

same road is practicable and would add much to the convenience of the householders residing in the vicinity thereof, we therefore recommend that said proposed road be laid out and declared a public highway of said county

James Wenderhott
E. P. McDaniel

Jonathan Gephart ^{viewers}

And said report of the viewers and the report of the surveyors having been now publicly read in open court, on two several days of the present term of the court and it appearing to the court that said viewers report favorably thereon, and recommend that said proposed road be established as a County road and be declared a public highway of Union County, Oregon, and all the proceedings herein having been regular, and according to law, and no remonstrance or claim for damages having been filed herein and there having been no cause shown why this proposed road should not be declared a public highway according to law, and the court being satisfied from the report of the viewers that such road will be of public utility, it is therefore considered and ordered by the court that said reports of the viewers and surveyor be approved and adopted by the court and that said proposed road be declared a public highway of Union Co., Oregon and ordered opened up and placed in repair for travel according to law. It is further ordered that the report of the viewers be placed on record in this journal, and that the surveyor's plat of the proposed road and his field notes of the survey thereof, be placed on record in the book of Plate of County roads of Union County, Oregon, and that H. L. Daugherty Road Supervisor of road District, No 6 the same being the road district in which said road is located be furnished with a copy of the petition herein and a copy of this decree and ordered to open up said road and place the same in repair for travel.

In the Matter of the proposed
County Road petitioned for by W. D.
Arnold et al

This Matter came on to be heard at this

Second Judicial Day

Thursday April 9th 1891

time on the reports of the Viewers and Surveyor heretofore appointed, herein for a second reading as provided by law, and the Report of Viewers being in words following, to wit:

Report of Viewers

To the Honorable County Court for Union County, Oregon;

The undersigned viewers heretofore on the 4th day of March 1891 appointed to view and lay out and alter the proposed County road, of which the survey hereto attached is a true and correct description as petitioned for by W. D. Arnold et al, beg leave to report that on the 12 day of March 1891, in pursuance with said appointment and order, after being duly sworn to faithfully and impartially discharge the duties of said appointment, we proceed to view out said proposed road for the whole distance thereof, and that in our opinion said proposed road should be laid out and established as a public highway of Union County, Oregon. That the same is practicable and would add much to the convenience of the householders residing in the vicinity thereof, we therefore recommend that said proposed road be laid out and declared a public highway of said county.

O. H. Strickland
J. N. Arnold

And said report of the viewers and the report of the surveyors having been now publicly read in open court, on two several days of the present term of the court, and it appearing to the court that said viewers report favorably thereon, and recommend that said proposed road be established as a County road and be declared a public highway of Union County, Oregon, and all the proceedings herein having been regular, and according to law, and no remonstrance or claim for damages having been filed herein and there having been no cause shown why this proposed road should not be declared a public highway and ordered open according to law, and the court being satisfied from the report of the viewers that such road will be of public utility it is therefore considered and ordered by the court that said reports of the viewers and surveyor

Second Judicial Day

Thursday April 9th 1891

be approved and adopted by the court, and that said proposed road be declared a public highway of Union Co. Oregon, and ordered opened up and placed in repair for travel according to law. It is further ordered that the report of the viewers be placed on record in this journal, and that the surveyor's plat of the proposed road and his field notes of the survey thereof, be placed on record in the book of Plats of County roads of Union County, Oregon, and that O. B. Strickland, Road Supervisor of road District, No. 40 the same being the road district in which said road is located be furnished with a copy of the petition herein, and a copy of this decree and ordered to open up said road and place the same in repair for travel.

In the Matter of the proposed
County Road petitioned for by
D. M. Tartar et al

This Matter came on to be heard at this time on the reports of the Viewers and Surveyor heretofore appointed, herein for a second reading as provided by law, and the Report of Viewers being in words following, to wit

Report of Viewers

To the Honorable County Court for Union County, Oregon.

The undersigned viewers heretofore on the 4 day of March 1891 appointed to view and lay out and alter the proposed County road of which the survey hereto attached is a true and correct description as petitioned for by D. M. Tartar et al by leave to report that on the 20 day of March 1891 in pursuance with said appointment and order, after being duly sworn to faithfully and impartially discharge the duties of said appointment, we proceeded to view out said proposed road for the whole distance thereof, and that in our opinions said proposed road should be laid out and established as a public highway of Union County Oregon, that the same is practicable and would add materially to the convenience of the householders residing in the vicinity thereof, we therefore recommend that said proposed road be laid out and declared a public highway of