

ARNOLD & DRAY'S ADDITION,

to the Town of

La Grande.

Situated on the N.E. 1/4 of S.E. 1/4 of Sect. 7, T. 3. S. R. 38. E.
and a portion in the N.W. 1/4 S.E. 1/4 Sec. 7, T. 3. S. R. 38. E.

Daniel Chaplain, Surveyor.

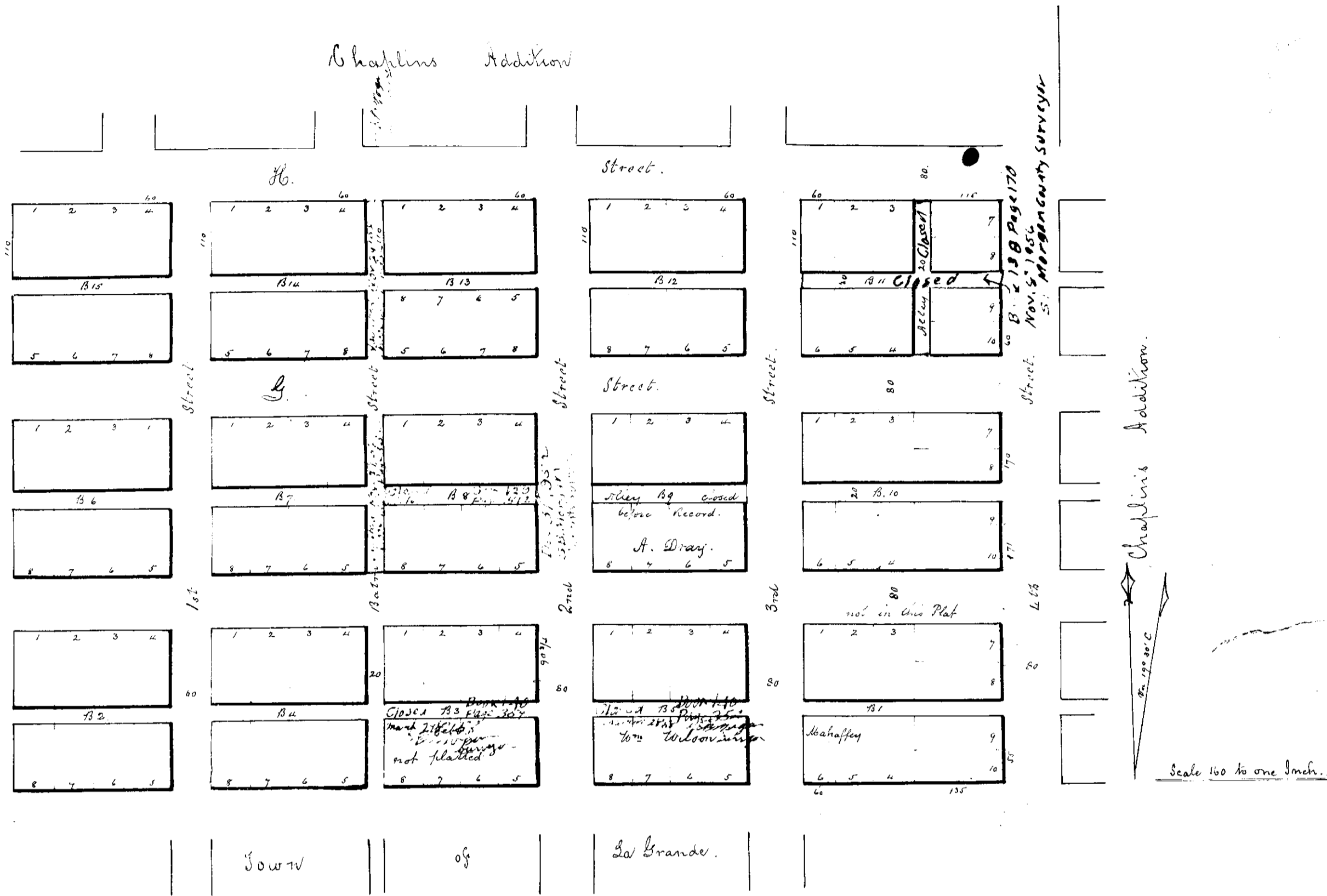

I hereby certify that I Recorded the above Plat
this the 9th day of Nov. 1874.

O. S. Cates, County Clerk.

State of Oregon
Union County. This is to certify that on this 14th day of October A. D. 1879 before me a County Clerk in and for
said County, came the above named A. Dray who is known to be the person who caused the above Town site to
be surveyed and flatted and acknowledged to me that he caused the same to be flatted for the purpose of selling the
same as town property. Witness my hand and Official Seal this 14th 1879.

Recorded Oct 14/79.

Willis Skiff, Clerk
By Ellis E. Cates, Df.



Willis Skiff, Co Clerk
By Ellis E. Cates, Df.

As reported from Book B, Records of Deeds Page 396
this 27th day of August A. D. 1891.

John L. Elliott, Recorder
By W. G. Bill, Deputy.