

MAP OF

RYNEARSON'S,

Addition to
La Grande, Union County, Oregon.

J. L. Heidenreich - A.S.T.

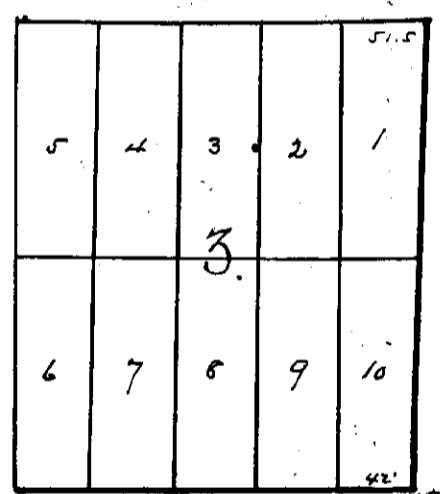
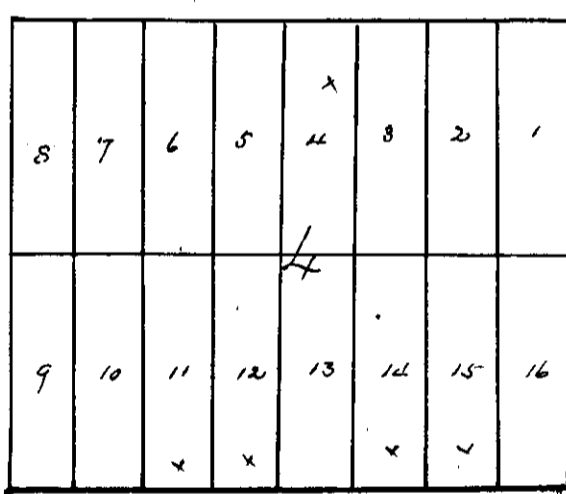
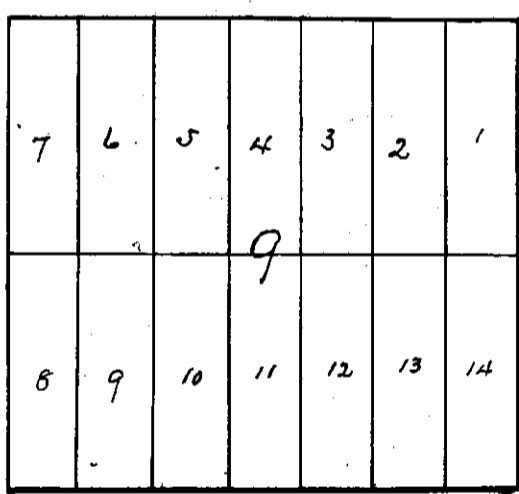
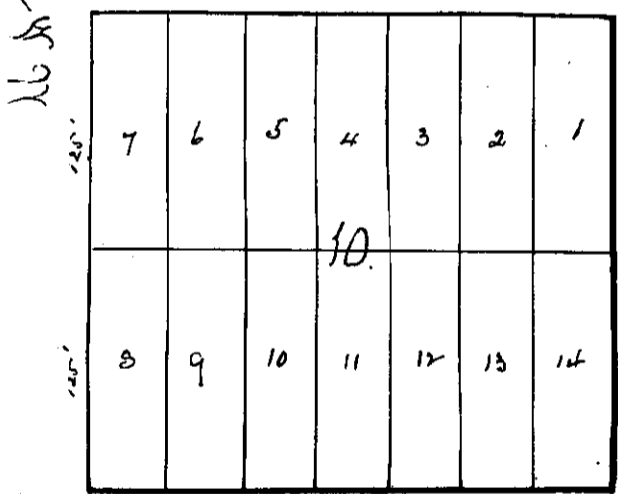
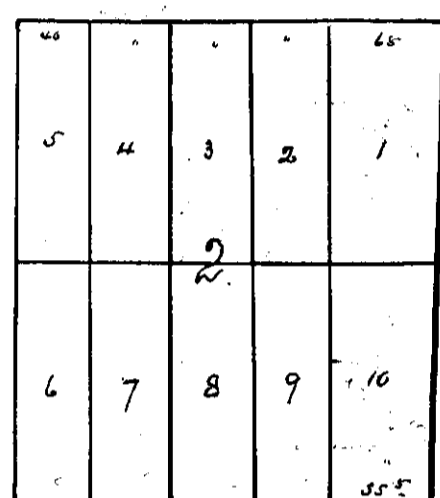
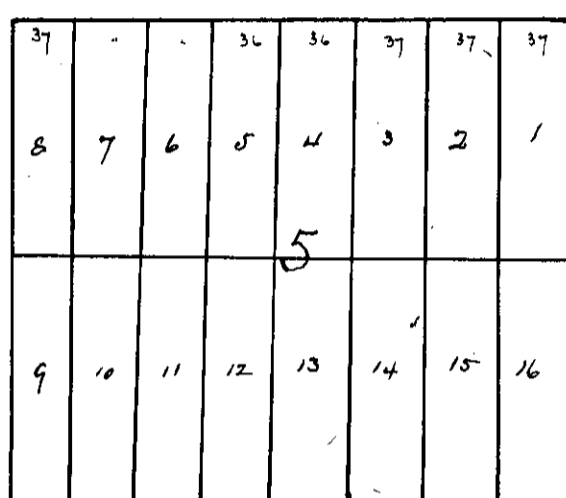
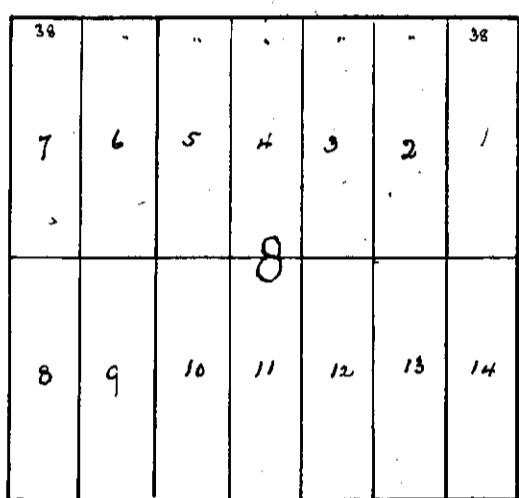
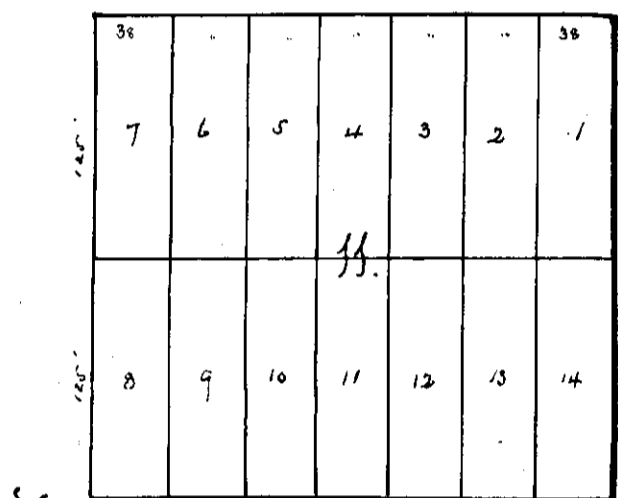
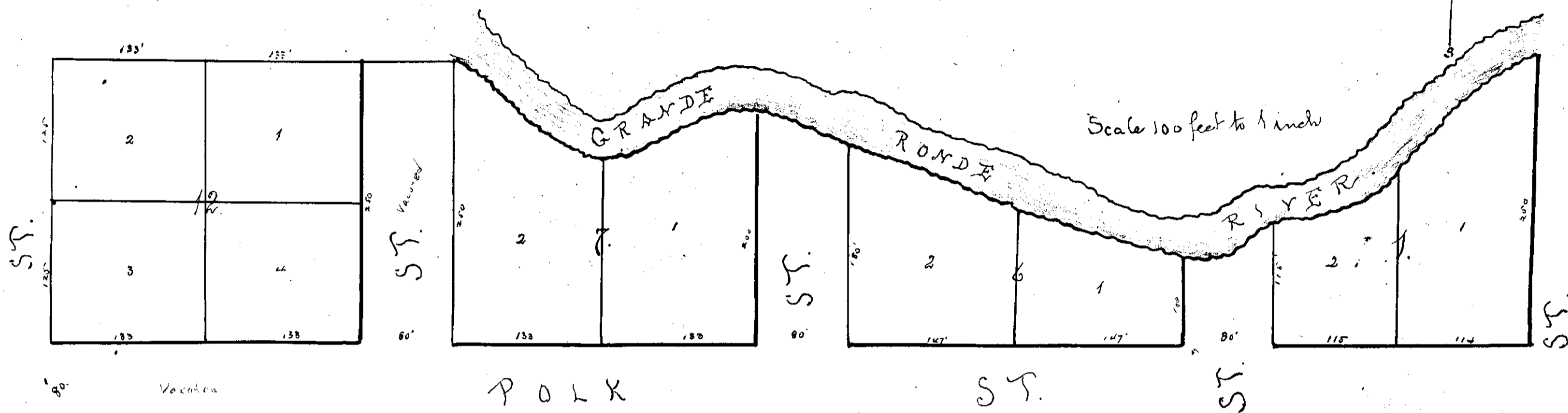
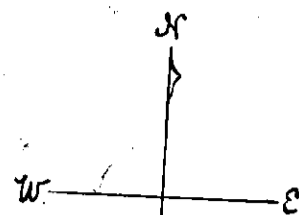

WARRIOR ST. POLK ST. ST. ST. ST.

FIRST LAKES SECOND THIRD FOURTH DIVISION ST.

VACATED
 Rec. 5-7-85
 NF 114931
 Posted 2-18-86
 Stone Monument
 G. LANGRISH, Dea. Co. Surveyor

State of Oregon
 County of Union

Personally appeared before the undersigned J. L. Heidenreich
 Notary Public for Oregon on this 28th day of November A.D. 1890
 A. H. Ryneason and Mollie M. Ryneason his wife personally

known to me and who acknowledged to me that they surveyed laid out and platted
 all that piece of land lying and situated in the S.E. 1/4 of S.E. 1/4 of Section 31, T. 2. S.
 R. 25 E. Willamette Meridian in lots Blocks and Sheets and that the plot upon which
 this acknowledgment and certificate is placed is the original and true plat of said
 survey and land so laid out that they hereby dedicate the sheets thereon referenced
 as required by law and that the same is their voluntary act and deed which
 acknowledgment of Mollie M. Ryneason the wife was made separate and apart
 from her husband A. H. Ryneason

Edw. Misener
 J. L. Heidenreich

A. H. Ryneason
 Mollie M. Ryneason

In witness whereof I have hereunto set my hand and seal
 this 28th day of November 1890

(Signature)
 Seal

J. L. Heidenreich
 Notary Public for Oregon

Recorded Nov. 29. 1890 e 1 of P. M.

John S. Elliott, Recorder
 By P. P. W. Deputy.