

# SECOND ADDITION UNION CEMETERY

UNION OREGON

Scale 1"=30'

Drawn by R. Neal.

324 feet.

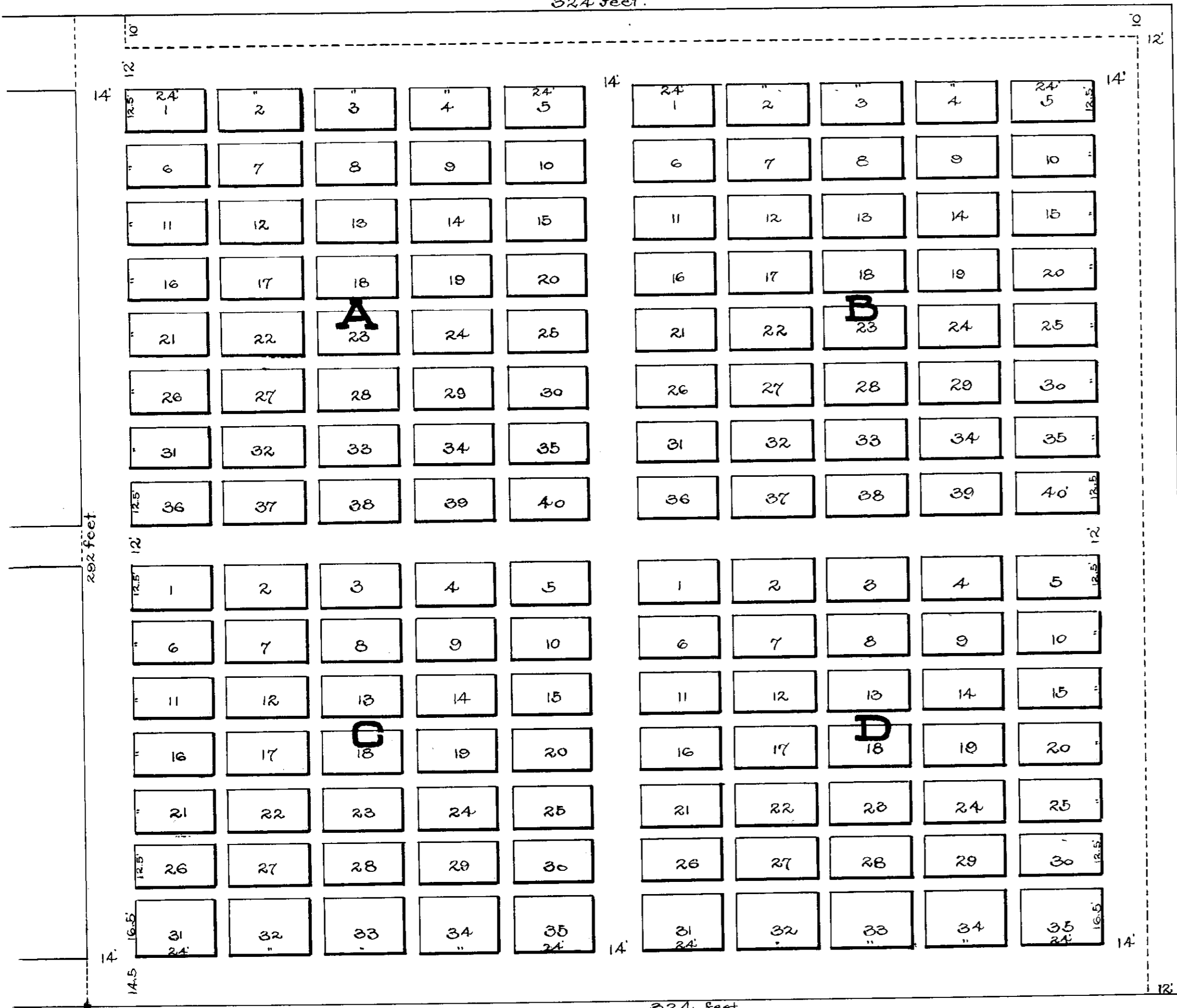

Initial point 2 inch galvanized pipe 36 inches long.

Detail of Block Sub-division

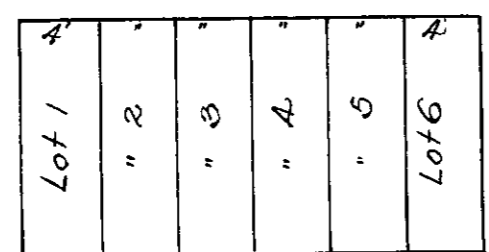

Note: All blocks are 12½ feet by 24 feet except blocks 31, 32, 33, 34, and 35 in Sections "C" and "D" which are 16½ feet by 24 feet. All blocks are subdivided into six lots 4 feet wide. All alleys are 4 feet wide.

Know All Men By These Presents: School District Number Five of Union County, State of Oregon, owner of the land shown on this plat, a part of the Southwest Quarter of the Northeast Quarter of Section Nineteen in Township Four South, Range Forty East of the Willamette Meridian, has caused said land to be sub-divided into Sections, Blocks, Lots, Streets, and Alleys, as shown by the words, lines, and figures, which appear on this plat, which hereafter shall be known as Second Addition to Union Cemetery and the Streets and Alleys as shown are hereby set aside and dedicated to the Public for perpetual use. In witness whereof we have hereunto set our hands and Seals this 4 day of Jan 1928.

Chairman J. Caduzze Seal  
Clerk Paul H. Jot Seal.

State of Oregon } s.s.  
County of Union } This is to certify that J. Caduzze and Paul H. Jot personally appeared before me the undersigned Notary Public in and for said County and State on this the 4 day of Jan 1928, and acknowledged to me they signed the foregoing dedication freely and voluntarily. In Testimony Whereof, I have hereunto set my hand and Notarial Seal the day and year last above written. W. J. Shaw Notary Public for Oregon. My Commission Expires Jan 1 1931.

State of Oregon } s.s.  
County of Union } I, Roscoe Neal, do hereby certify that I surveyed the following described land, beginning at the initial point which is South 670 feet and East 314.5 feet from the N.W. corner of the S.W.¼ of the N.E.¼ of Section 19 in Tp. 4 S. R. 40 E. of W.M., and running thence South 324 feet; thence East 292 feet; thence North 324 feet; thence West 292 feet to the place of beginning. Roscoe Neal County Surveyor.

The foregoing plat is hereby approved. W. G. Gunch County Judge. W. W. Stevens County Commissioner. J. K. Reddick County Commissioner.

FILED  
JAN 10 1928  
W. M. Connick  
COUNTY CLERK

