



# WESTVIEW HEIGHTS

Microfilm No. 20035892T  
Plat Cabinet No. C 706-707

A subdivision of a portion of Parcel 3 of Minor Partition Number 2000-09,  
Situating in the South half of Section 10  
Township 3 South, Range 40 East of the Willamette Meridian

## SURVEYOR'S CERTIFICATE

I, Rick G. Robinson, Registered Professional Land Surveyor, hereby certify that I have surveyed and platted the land within the annexed subdivision, in accordance with the provisions of O.R.S. Chapter 92, said subdivision being a portion of Parcel 3 of minor partition plat number 2000-09, situated in the South half of Section 10, Township 3 South, Range 40 East of the Willamette Meridian, Union County, Oregon, the exterior of which being more particularly described as follows,

Beginning at the West 1/16th corner between Sections 10 and 15 of said Township and Range,

- Thence; North 0°21'32" West, along the West line of the Southeast quarter of the Southwest quarter of said Section 10, a distance of 281.38 feet,
- Thence; North 89°41'13" East, parallel with the North line of the Southeast quarter of the Southwest quarter of said Section 10, a distance of 500.00 feet,
- Thence; North 0°21'32" West, parallel with the West line of the Southeast quarter of the Southwest quarter of said Section 10, a distance of 1050.00 feet to the North line of the South half of the South half of said Section 10,
- Thence; North 89°41'13" East, along said North line, a distance of 60.00 feet,
- Thence; South 0°21'32" East, parallel with the West line of the Southeast quarter of the Southwest quarter of said Section 10, a distance of 525.00 feet,
- Thence; North 89°41'13" East, parallel with the North line of the Southeast quarter of the Southwest quarter of said Section 10, a distance of 365.00 feet,
- Thence; North 0°21'32" West, parallel with the West line of said Southeast quarter of the Southwest quarter of said Section 10, a distance of 262.19 feet to the Southwest corner of Parcel 1 of Minor Partition plat number 2000-09, as filed in the plat records of Union County,
- Thence; North 89°48'49" East, along the South line of Parcels 1 and 2 of said partition plat, a distance of 365.13 feet, to the Southeast corner of said Parcel 2,
- Thence; North 0°14'57" West, along the East line of said Parcel 2, a distance of 263.61 feet, to the Northeast corner thereof, said point being on the North line of the South half of the South half of said Section 10, said line also being the North line of Parcel 3 of Minor Partition plat number 2000-09,
- Thence; North 89°41'13" East, along said North line, and the North line of the Southwest quarter of the Southeast quarter of said Section 10, a distance of 60.00 feet,
- Thence; South 0°14'57" East, a distance of 357.57 feet,
- Thence; North 89°41'13" East, a distance of 312.48 feet, to the West line of Parcel 1 of Minor Partition Plat Number 1997-23,
- Thence; South 0°13'18" East, along the West line of said Parcel 1, and its Southerly prolongation, said line being the East line of the West quarter of the Southwest quarter of the Southeast quarter of said Section 10, a distance of 970.53 feet, to the Southeast corner of Parcel 3 of said Minor Partition plat number 2000-09,
- Thence; South 89°34'25" West, along the South line of said Parcel 3, said line also being the South line of said Section 10, a distance of 1660.10 feet, to the Point of Beginning of this description.

Parcel subject to the rights of the public in Union County Road Number 120 over and across the North line of said parcel as shown on the annexed map.

Said parcel containing 29.50 Acres (including County roadway)  
Said parcel containing 29.43 Acres (Excluding County roadway)

Rick G. Robinson  
Rick G. Robinson, OPLS 2219  
Baggett, Griffith and Blackman  
2006 Adams Avenue  
LaGrande, Oregon 97850

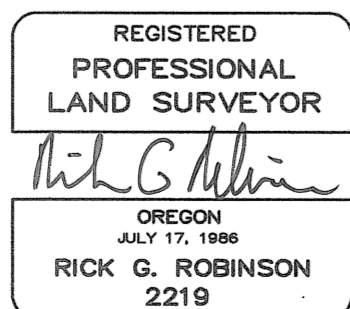

Renewal Date: Dec. 31, 2004

## DEDICATION

Know all people by these presents that RON MORRIS and THOMASINE A. MORRIS are the owners of the land represented on the annexed map, and being more particularly described in the annexed Surveyor's Certificate, and have caused the same to be surveyed and subdivided into the lots shown on the annexed map, and for ourselves, our heirs and assigns, hereby dedicate to public use forever, the area shown as Squire Loop on the annexed map, in accordance with the provisions of O.R.S. Chapter 92.

Ron Morris  
Ron Morris

Thomasine A. Morris  
Thomasine A. Morris

## ACKNOWLEDGMENT

State of Oregon  
County of Union

Know all these people by these presents, on this 8 day of JANUARY, 2002, <sup>3</sup>PM before me a Notary Public in and for said State and County, personally appeared RON MORRIS and THOMASINE A. MORRIS, who being duly sworn did say that they are the identical persons named in the foregoing instrument, and that said instrument was executed freely and voluntarily.

Marcia L. Ryneason  
Notary Public for  
the State of Oregon

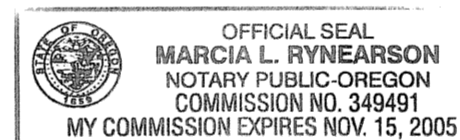

Notarial Seal

## SURVEYOR'S EXACT COPY STATEMENT

I, Rick G. Robinson, registered Oregon Surveyor No. 2219, do hereby certify that I am the Surveyor who prepared the Plat of WESTVIEW HEIGHTS Subdivision and that the annexed tracing is an exact copy of said Subdivision Plat as the same is on file in UNION COUNTY Cabinet Number C 706-707 of the Plat Records of UNION COUNTY, and said exact copy is submitted as per O.R.S. 92.070.

Rick G. Robinson  
Rick G. Robinson, OPLS 2219

## APPROVALS

### Union County Assessor / Tax Collector

I hereby certify that pursuant to O.R.S. 92.095, all ad valorem taxes and all special assessments, fees and other charges required by law to be placed upon the ~~2002-2003~~ tax roll which became a lien on the land within this subdivision, or will become a lien during the tax year but not certified to the tax collector for collection have been paid.

by Patty Gooderham Date: 8/12/03  
Patty Gooderham, Union County Assessor/Tax Collector

### Union County Surveyor

Approved this 19<sup>th</sup> day of DECEMBER, 2002.

by Wallowa County Surveyor Jack W. Burris  
Jack W. Burris

### Union County Planning Commission

Approved this 3<sup>rd</sup> day of September, 2003.

Hanley Jenkins II  
Hanley Jenkins II  
Union County Planning Director

### Union County Commission

Approved this 3<sup>rd</sup> day of September, 2003.

Colleen MacLeod  
Steve McClure  
John E. Lamoreau  
John E. Lamoreau

## FILING STATEMENT

### Union County Clerk

State of Oregon SS  
County of Union

I do hereby certify that the attached subdivision plat was received for record on the 3<sup>rd</sup> day of September, 2003, at 9:45 o'clock A.M., and recorded in Plat Cabinet No. C 706-707 Union County records. Microfilm Number 20035892T

R. Nellie Bogue Hibbert,  
Union County Clerk by R. Church, deputy