

Minor Partition Plat Number 200700037

A Partition of a portion of Lot 11 of Block B of NEW HAVEN ADDITION to the City of La Grande, situated in the Northwest quarter of Section 5, Township 3 South, Range 38 East, Willamette Meridian

Microfilm Number 200708627
Plat Cabinet Number C864, C865

BASIS OF BEARING

Forward bearing as published by the U.S.C. and G.S. from Δ COLLEGE to Δ VALLEY Dated 1946.

SCALE: 1"=40'

LEGEND

- Found Brass cap in valve box as per Union County monumentation records.
- Found 3/4" pipe as per Survey number 18-89, set by 1922 remonumentation..
- Position only nothing found or set.
- Found 5/8" iron rebar with yellow plastic cap marked "BGA SURVEY MARKER". set by Survey number 33-83.
- Found 1/2" iron pin, set by Survey number 75-73.
- Set 5/8"x 30" iron rebar with yellow plastic cap marked "BGB SURVEY MARKER".
- Record information from Original plat of NEW HAVEN ADDITION.
- Record information from Survey Number 33-83.
- Record information from Survey Number 13-80.
- Record information from 1922 Remonumentation of La Grande Survey 18-89.
- Centerline of road
- Easement Line
- Fence Line

NARRATIVE

This partition was done at the request of Richard and Lisa Jensen in order to partition their existing property into three separate parcels. I based my partition on survey number 13-80, which located Block B of NEW HAVEN ADDITION. I recovered monuments set and found by survey number 33-83, I use these monuments along with the record distances from the original plat of NEW HAVEN ADDITION to place the lot lines accordingly. At the direction of the Jensens I divide there ownership into three parcels and set monuments at the corners. I find no unusual conditions with this partition.

REFERENCE MATERIAL

- Union County monumentation records
- Plat of NEW HAVEN ADDITION
- 1922 Remonumentation of La Grande (Survey number 18-89)
- Survey number 33-83
- Survey number 13-80
- Survey number 75-73
- Deeds
- Microfilm No. 20044038
- Eastern Oregon Title Inc. Title report No.06-17701

SURVEYOR'S EXACT COPY STATEMENT

I, Rick G. Robinson, registered Oregon Surveyor No. 2219, do hereby certify that I am the Surveyor who prepared the Partition Plat No. 200700037 and that the annexed tracing is an exact copy of said Partition Plat as the same is on file in UNION COUNTY Cabinet Number C864, C865 of the Plat Records of UNION COUNTY, and said exact copy is submitted as per O.R.S. 92.070.

Rick G. Robinson
Rick G. Robinson, OPLS 2219

REGISTERED
PROFESSIONAL
LAND SURVEYOR

Rick G. Robinson
OREGON
JULY 17, 1986
RICK G. ROBINSON
2219

Renewal Date: Dec. 31, 2008

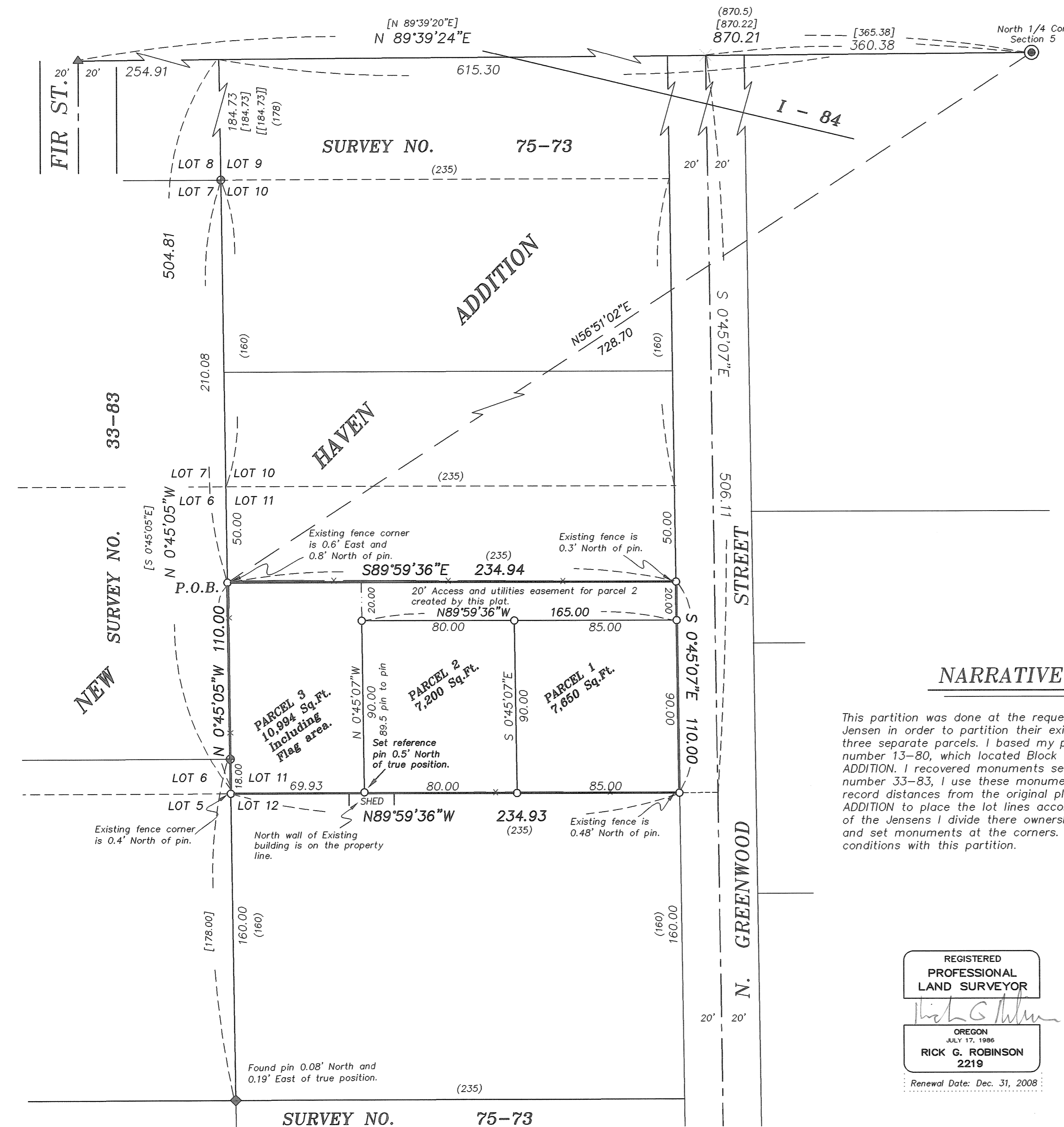

Minor Partition Plat Number 20070003T

Microfilm Number 20070862T
Plat Cabinet Number C864, C865

A Partition of a portion of Lot 11 of Block B of NEW HAVEN ADDITION to the City of La Grande, situated in the Northwest quarter of Section 5, Township 3 South, Range 38 East, Willamette Meridian

SURVEYOR'S CERTIFICATE

I Rick G. Robinson, Registered Professional Land Surveyor, hereby certify that I have surveyed and platted the land within this Partition, being a portion of Lot 11 Block B of NEW HAVEN ADDITION to La Grande, Union County Oregon, being more particularly described as follows;

Beginning at a point on the West line of Lot 11 Block B of NEW HAVEN ADDITION to the city of La Grande, being S 56°51'02"W, a distance of 728.70 feet from the North quarter corner of Section 5, Township 3 South, Range 38 East of the Willamette Meridian;

Thence; S 89°59'36" E, a distance of 234.94 feet, to the West right of way line of North Greenwood Street also being the East line of Lot 11 Block B of NEW HAVEN ADDITION;

Thence; S 0°45'07" E, along the East line of said Lot 11, a distance of 110.00 feet to the Southeast corner of Lot 11;

Thence; N 89°59'36" W, along South line of said Lot 11, a distance of 234.93 feet to the Southwest lot corner;

Thence; N 0°45'05" W, along the West line of said Lot 11, a distance of 110.00 feet to the point of beginning of this description.

Said parcel containing 25,840 Sq. Ft. (0.59 Acres)

I further certify that I made this survey and plat by order of and under the direction of the owners thereof, and that all parcel corners and boundary corners are marked with monuments as indicated on the annexed plat in accordance with O.R.S. 92.050 and 92.060.

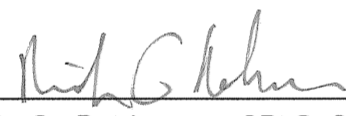

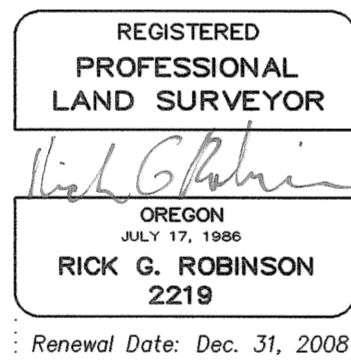
Rick G. Robinson OPLS 2219
Bagett, Griffith and Blackman
2006 Adams Avenue
LaGrande, OR 97850

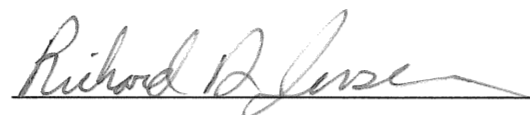

DECLARATION

Know all people by these presents that RICHARD D. JENSEN and LISA C. JENSEN are the owners of the land within this this partition, being more particularly described in the accompanying Surveyor's Certificate, and has caused the same to be surveyed and platted as shown on the annexed plat, and we do hereby create the 20 foot wide access and utility easement to Parcel 2 as shown on the annexed plat, all in accordance with the provisions of O.R.S. Chapter 92.

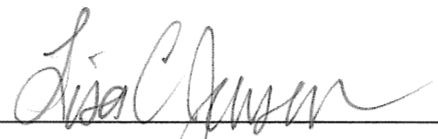

RICHARD D. JENSEN

LISA C. JENSEN

APPROVALS

City of LaGrande City Surveyor

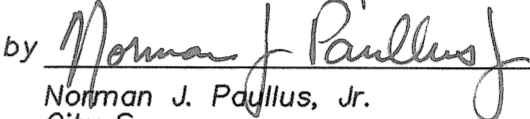
Examined and recommended for approval as per O.R.S. Chapter 92 this 20th day of February, 2007.

by 
Norman J. Paullus, Jr.
City Surveyor

City of LaGrande Planner

Approved this 20th day of February, 2007.

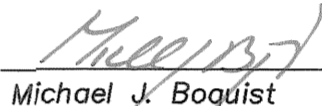
Michael J. Boquist
City Planner

Union County Assessor / Tax Collector

I hereby certify that pursuant to O.R.S. 92.095, all ad valorem taxes and all special assessments, fees and other charges required by law to be placed upon the 2006-2007 tax roll which became a lien on the land within this partition, or will become a lien during the tax year but not certified to the tax collector for collection have been paid.

by  Date: 2/9/07
Linda L. Hill, Union County Assessor/Tax Collector

ACKNOWLEDGMENTS

State of Oregon SS
County of Union

Know all people by these presents, on this 8th day of February, 2007, before me a Notary Public in and for said County and State, personally appeared RICHARD D. JENSEN and LISA C. JENSEN, known to me to be the identical person named in the foregoing instrument, and that said instrument was executed freely and voluntarily.

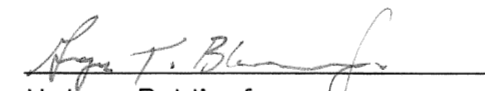

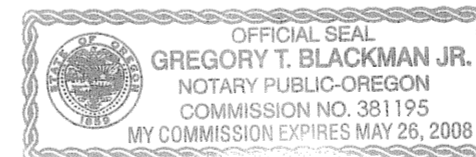
Notary Public for
the State of Oregon



Notarial Seal

SURVEYOR'S EXACT COPY STATEMENT

I, Rick G. Robinson, registered Oregon Surveyor No. 2219, do hereby certify that I am the Surveyor who prepared the Partition Plat No. 20070003T and that the annexed tracing is an exact copy of said Partition Plat as the same is on file in UNION COUNTY Cabinet Number C864, C865 of the Plat Records of UNION COUNTY, and said exact copy is submitted as per O.R.S. 92.070.

Rick G. Robinson, OPLS 2219

FILING STATEMENT

UNION COUNTY CLERK

State of Oregon SS
County of Union

I do hereby certify that the attached partition plat was received for record on the 20th day of Feb, 2007, at 9:22 o'clock A.M., and filed in Plat Cabinet No. C864, C865 Union County records. Microfilm No. 20070862T.

Union County Clerk by 