

**CERTIFIED RECORD OF LAND CORNER MONUMENTATION**

**HISTORY OF ORIGINAL CORNER ESTABLISHED:**

Not previously Established.

T 1 N R 38 E A-24

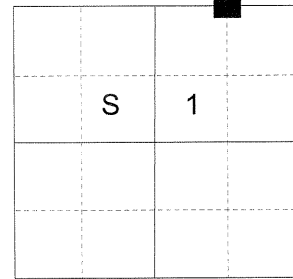

**DESCRIPTION OF CORNER EVIDENCE FOUND:**

Existing Valsetz Lumber Co. Location tag on Southwest bearing tree

See Survey 015-2020

**DESCRIPTION OF MONUMENT AND ACCESSORIES I**

**ESTABLISHED TO MONUMENT THE LOCATION OF THIS CORNER:**

At position determined by survey I set a 5/8" x 30" iron pin, 26" in the ground, with 2 1/2" aluminum cap marked as shown below, from which:

**NEW BEARING OBJECTS:**

An 8" Douglas Fir bears North 39° East a dist. of 27.60 ft., marked E 1/16 S36 BT.  
A 23" White Fir bears South 15° West a dist. of 13.55 ft., marked E 1/16 S1 BT.

Set fence post approx. 1 ft. West

I hereby certify that the corner was monumented on May 8, 2020.

Witness: Kyle A. Tucker

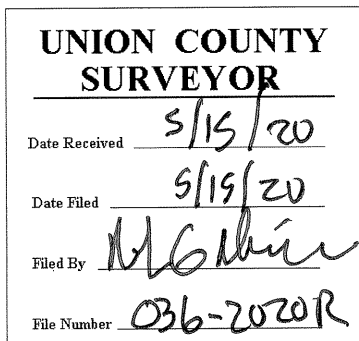
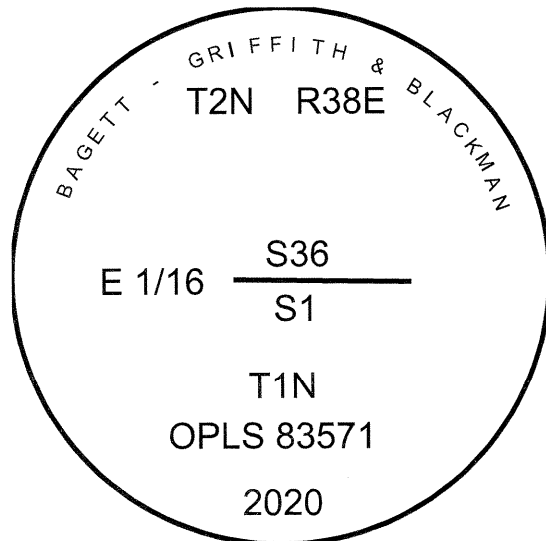

I used a steel tape and magnetic compass in the establishment of the new accessories. I used 14° East declination, the distances are to a 60d spike driven into the right side of the root crown of the bearing trees. A brass washer marked OPLS 83571 is attached to the BT blaze of the new bearing trees.