

CERTIFIED RECORD OF LAND CORNER MONUMENTATION

HISTORY OF ORIGINAL CORNER ESTABLISHED:

Corner originally established by Joseph Gray under GLO contract number 120 dated May 27, 1867. Surveyor General field notes state:

Set quarter section cor. post,
from which:
A pine 20 in. diam. bears South 14 lks.
A pine 24 in. diam. bears N50°W 47 lks.

Union County Surveys 020-2016 and 008-2019 both found no evidence of the original corner and used a proportionate position.

T 1 N R 38 E J-19

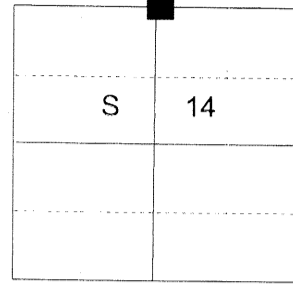

DESCRIPTION OF CORNER EVIDENCE FOUND:

None. The area has been logged multiple times.

See Survey 011-2020

DESCRIPTION OF MONUMENT AND ACCESSORIES I ESTABLISHED TO MONUMENT THE ORIGINAL LOCATION OF THIS CORNER:

At proportionate position I set a 2 1/2" x 30" aluminum pipe, 30" in the ground with 3" aluminum cap marked as shown below, in a collar of stone 1.5 ft. diam., from which:

NEW BEARING OBJECTS:

A 6" Douglas Fir bears North 17° East a dist. of 16.95 ft., marked 1/4 S11 BT.
A 7" Douglas Fir bears South 1° East a dist. of 16.45 ft., marked 1/4 S14 BT.
A 9" Ponderosa Pine bears West a dist. of 35.10 ft., marked 1/4 S14 BT.
A 16" Ponderosa Pine bears North 27° West a dist. of 52.10 ft., marked 1/4 S11 BT.

Set steel fence post approx. 1 ft East.

An East/West fence bears approx. 15 ft. North

I hereby certify that the corner was monumented on April 06, 2020.

Witness: Kyle A. Tucker

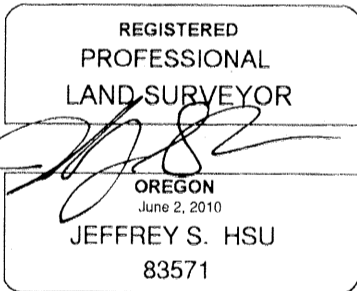
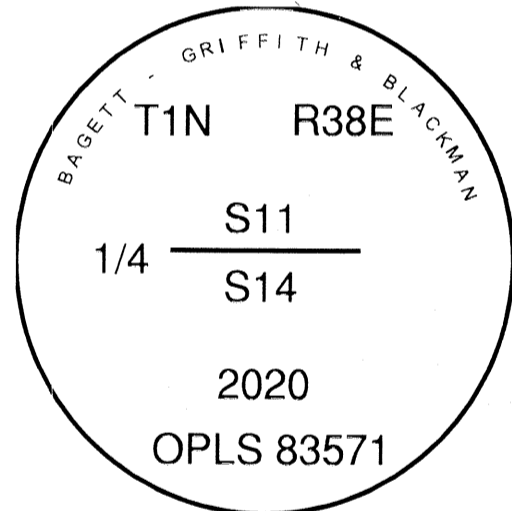

Renewal Date: June 30, 2021

UNION COUNTY SURVEYOR
Date Received 4/9/20
Date Filed 4/9/20
Filed By [Signature]
File Number 016-2020R

I used a steel tape and magnetic compass in the establishment of the new accessories. I used 14° East declination, the distances are to a 60d spike driven into the right side of the root crown of the bearing trees. A brass washer marked OPLS 83571 is attached to the BT blaze of the new bearing trees.