

CERTIFIED RECORD OF LAND CORNER MONUMENTATION

HISTORY OF ORIGINAL CORNER ESTABLISHMENT:

Corner originally established by John W. Kimbrell under GLO Contract Number 579, dated June 22, 1891. Surveyor General field notes state:

Set post 4 feet long, 4 ins. square, 24 ins. in the ground for corner to Sec 16-17-20 and 21, from which:

A fir, 14 ins. diam., brs. S 65° W, 13 lks. dist., marked T1N R38E S20 BT.

A fir, 5 ins. dia., brs. S 62° E, 20 lks. dist., marked T1N R38E S21 BT.

A fir, 14 ins. dia. brs. N 49° E, 48 lks. dist., marked T1N R38E S16 BT.

A fir, 6 ins. dia. brs. N 6° W., 15 lks. dist., marked T1N R38E S17 BT.

T 1 N R 38 E N-09

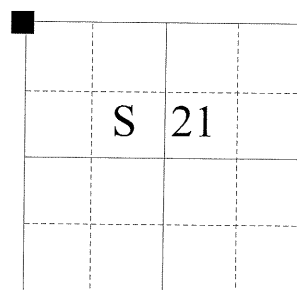

DESCRIPTION OF CORNER EVIDENCE FOUND:

None.

SEE SURVEY NUMBER 018-2014

DESCRIPTION OF MONUMENT AND ACCESSORIES I ESTABLISHED

TO PERPETUATE THE ORIGINAL LOCATION OF THIS CORNER:

At proportionate distance, I set a 2 1/2"x30" aluminum pipe with 2 1/2" aluminum cap, marked as shown below, 26 inches in the ground, from which:

- A 9 inch White Fir bears North 55° East, a distance of 32.90 feet, marked T1N R38E S16 BT.
- An 11 inch White Fir bears South 59° East, a distance of 16.45 feet, marked T1N R38E S21 BT.
- An 8 inch White Fir bears South 27° West, a distance of 49.25 feet, marked T1N R38E S20 BT.
- An 8 inch White Fir bears North 22° West, a distance of 22.45 feet, marked T1N R38E S17 BT.

I set a steel fencepost approximately 1 foot North of corner monument.
I hereby certify that the corner was monumented on June 28, 2014.

REGISTERED
PROFESSIONAL
LAND SURVEYOR

Jeffrey S. Hsu
OREGON
June 2, 2010
JEFFREY S. HSU
83571

Renewal Date: June 30, 2015

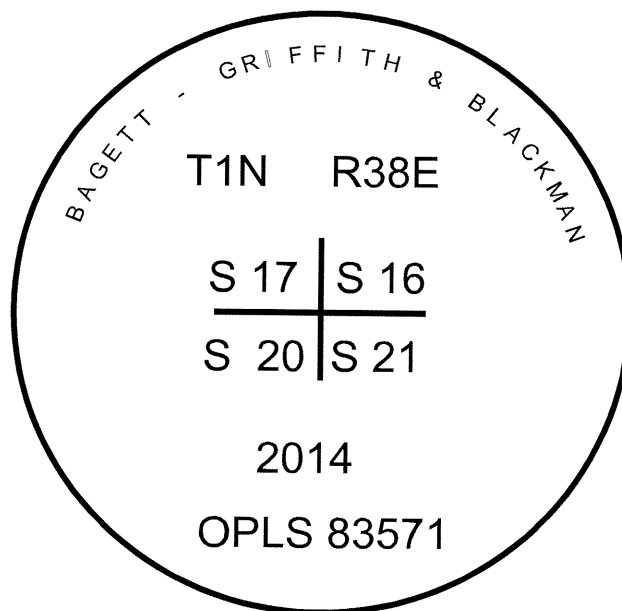

UNION COUNTY SURVEYOR

Date Received 7/11/14

Date Filed 7/11/14

Filed By M. G. Muir

File Number 025-2014R

I used a steel tape and magnetic compass in the establishment of the new accessories. I used 16° East declination, the distances are to a 60d spike in the right hand side of the bearing trees. Bearings are to a washer marked OPLS 83571 set in the upper portion of the BT blaze.

HORIZONTAL CONTROL DATA

UNION COUNTY, OREGON

OREGON STATE PLANE, NORTH ZONE (3601)

STA NAME: 201525

SECTION CORNER COMMON TO SECTIONS 16, 17, 20 AND 21

TWP. 1 N. RGE. 38 E.

GEODETIC COORD: NAD 83(91)

DATE TIED: August 27, 2015

LAT: 45 ° 33 ' 32.68624 " N

SURVEYOR: RICK G. ROBINSON
OPLS 2219

LONG: 118 ° 4 ' 36.45996 " W

FIRM: BAGETT, GRIFFITH, & BLACKMAN
2006 ADAMS AVENUE
LAGRANDE, OR 97850
(541) 963-6092

SP. COOR: NAD 83(91)

N: 699235.086 INT FT.

E: 8822673.753 INT FT.

TYPE: GPS

THETA: 1 ° 43 ' 6.61261184 "

ORDER: SECOND CLASS: 1

SCALE FACTOR: 0.9999177651

ELEV: 3216.35 US FT.

ELEV: DATUM: NGVD 29

COMMENTS:

2 1/2" aluminum cap monument marked
as shown

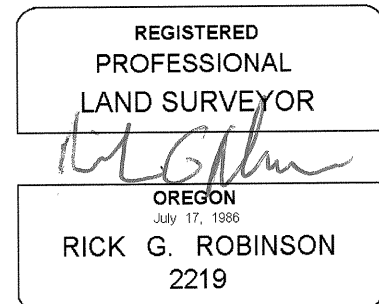
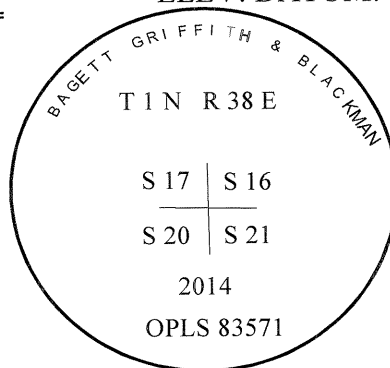

Renewal Date: December 31, 2016

1 METER = 3.2808333333... US FEET = 39.37 INCHES

1 METER = 3.280839895 INT'L FEET OR 1 INCH = 2.54 CM

TO CALCULATE ELEVATION FACTOR (IN THE NORTH AMERICAN CONTINENT)

DIVIDE 20,906,000 BY (20,906,000 + ELLIPSOID ELEV. IN FEET)