

CERTIFIED RECORD OF LAND CORNER MONUMENTATION

HISTORY OF ORIGINAL CORNER

ESTABLISHED:

Corner not previously established.

T 1 N R 38 E P-06

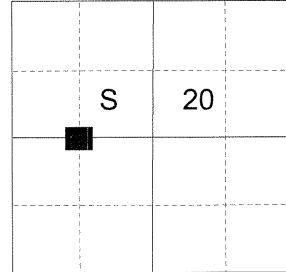

DESCRIPTION OF CORNER EVIDENCE FOUND:

None.

SEE SURVEY NUMBER 031-2018

DESCRIPTION OF MONUMENT AND ACCESSORIES I ESTABLISHED TO PERPETUATE THE ORIGINAL LOCATION OF THIS CORNER:

At position determined by survey, I set a 5/8"x30" iron pin with a 2 1/2" aluminum cap marked as shown below, 25" in the ground, in a collar of stone 2 ft. diam., from which:

NEW BEARING TREES:

A 16" Western Larch bears North 58° East a dist. of 76.80 ft., marked "CW 1/16 S20 BT".

A 11" White Fir bears South 89° West a dist. of 73.20 ft., marked "CW 1/16 S20 BT".

The marker is set approximately 175 feet East of the end of the forest road.

Set a steel post approximately 1 ft. north of the monument.

I hereby certify that the corner was monumented on July 31, 2018.

Witness: Kyle A. Tucker, Ryan Skeen



Renewal Date: June 30, 2019

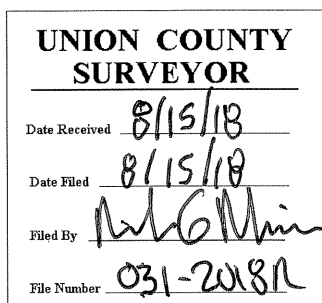
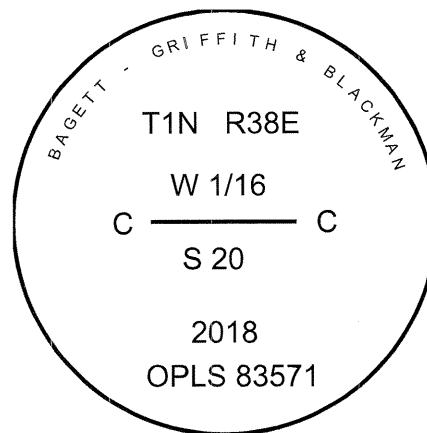

I used a steel tape and magnetic compass in the establishment of the new accessories. I used 13° East declination, the distances are to a 60d spike driven into the right side of the root crown of the bearing trees. A brass washer marked OPLS 83571 is attached to the BT blaze of the new bearing trees.