

CERTIFIED RECORD OF LAND CORNER MONUMENTATION

HISTORY OF ORIGINAL CORNER ESTABLISHED:

Corner not previously established.

T 1 N R 38 E Q-11

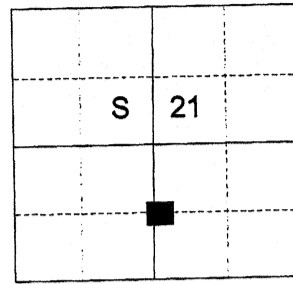

DESCRIPTION OF CORNER EVIDENCE FOUND:

None.

SEE SURVEY NUMBER 012-2023

DESCRIPTION OF MONUMENT AND ACCESSORIES I ESTABLISHED TO MONUMENT THE ORIGINAL LOCATION OF THIS CORNER:

At position by survey, I set a 5/8" x 30" iron pin, 29" in the ground, with 2 1/2" aluminum cap marked as shown below and 1 foot diameter collar of stone, from which:

NEW BEARING OBJECTS:

A 30" Douglas Fir bears South 38° East, a distance of 77.65 feet, marked CS 1/16 S21 BT.

An 11" Douglas Fir bears South 46° West, a distance of 52.50 feet, marked CS 1/16 S21 BT.

Set steel fence post approx. 0.5 feet South

East/West fenceline bears approx. 18 feet South

I hereby certify that the corner was monumented on June 1, 2023.

Witness: Kyle Tucker

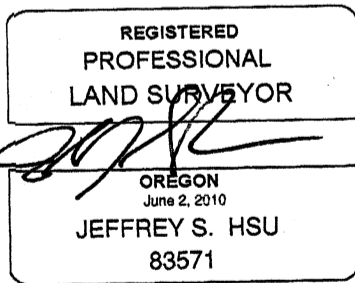
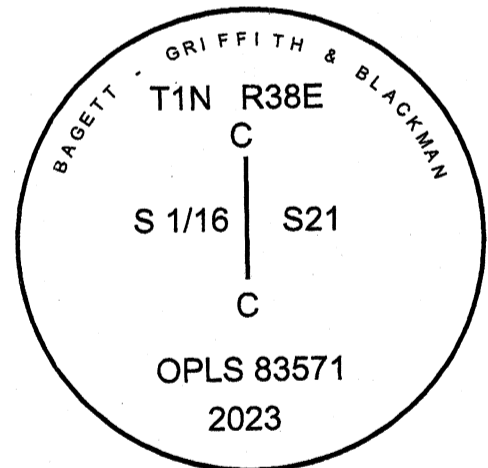

Renewal Date: June 30, 2025

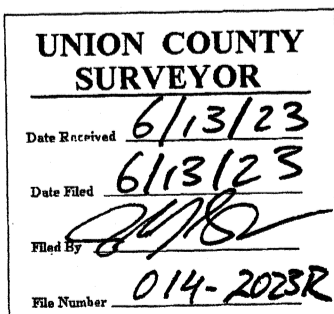

I used 14° East declination in the establishment of the new accessories. Bearings are measured to a brass washer tacked to the scribe of the tree and distances are measured to a 60D nail in the right side of the tree.