

UNION COUNTY SURVEYOR

CERTIFIED RECORD OF LAND CORNER MONUMENTATION

HISTORY OF ORIGINAL CORNER ESTABLISHMENT:

Corner originally established by Timothy W. Davenport under GLO Contract No. 102, dated July 20, 1863, GLO Record States: Set post for corner to sections. 2, 3, 34, and 35, made mound of earth and buried charred stakes as per instructions.

T1 N R 39 E A-17

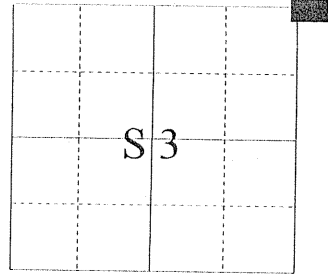

W. Arthur Graham found MOUND OF SOIL, and added bearing tree. A 31" Pine bears S 38°13' W, 1.143 chains from corner. See Survey 18-62, Union County Surveyors Office.

See Union County Survey 006-2005.

DESCRIPTION OF CORNER EVIDENCE FOUND:

FOUND SOUTHWEST BEARING TREE. TREE IS NOW A 40" PONDEROSA PINE, BLAZES EVIDENT, ALIVE AND VIGEROUS. DID NOT OPEN TREE FOR SCRIBES, (ONLY TREE AT CORNER)

DESCRIPTION OF MONUMENT AND ACCESSORIES I ESTABLISHED

TO PERPETUATE THE ORIGINAL LOCATION OF THIS CORNER: At the position determined by bearing and distance from the bearing tree, I set a 2½ x 30" Aluminum pipe with cap marked as shown below, 38 inches in the ground. From Which:

A 5/8"x30" Rebar with 1" Aluminum cap Marked Union County Surveyor, NE RP, bears N 38°13'E, a distance of 24.70 feet, (at fence corner)

A 5/8"x30" Rebar with 1" aluminum cap Marked Union County Surveyor, SE RP, bears S 31°E, a distance of 14.25 feet;

A 40 inch Ponderosa Pine (Graham Survey) bears S 38°13 W, a distance of 75.44 feet, (1.143 ch), blazes evident from Graham

A 5/8"x30" rebar with 1" aluminum cap marked Union County Surveyor, NW RP, bears N 40° W, a distance of 25.10 feet, (sets in East-West Fence).

Corner set 4/12/05, Witnesses: Gregory Blackman, Jr.

REGISTERED
PROFESSIONAL
LAND SURVEYOR

Gregory T. Blackman
OREGON
JULY 13, 1973
GREGORY T. BLACKMAN
991

Renewal Date: December 31, 2005

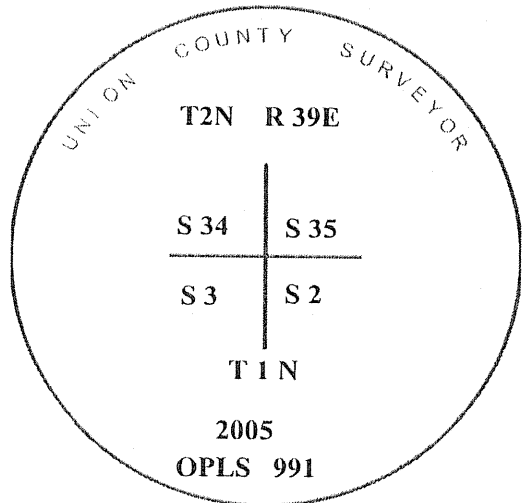

**UNION COUNTY
SURVEYOR**
Date Received 5/10/05
Date Filed 5/12/05
Filed By R. Robinson, Deputy
File Number 002-2005R

I used a Leica 530 GPS receiver in the establishment of the new accessories. The distance to the bearing tree is to the center of the tree. Did not drive spike at root crown, nor did I set a brass washer at the tree.

HORIZONTAL CONTROL DATA
UNION COUNTY, OREGON
OREGON STATE PLANE, NORTH ZONE (3601)

STA NAME: 201419

SECTION CORNER COMMON TO SECTIONS 2, 3, 34 AND 35

TWP. 1 and 2 N RGE. 39 E.

GEODETIC COORD: NAD 83(91)

DATE TIED: August 22, 2014

LAT: 45 ° 36 ' 7.01601 " N

SURVEYOR: RICK G. ROBINSON
OPLS 2219

LONG: 117 ° 54 ' 41.46098 " W

FIRM: BAGETT, GRIFFITH, & BLACKMAN
2006 ADAMS AVENUE
LAGRANDE, OR 97850
(541) 963-6092

SP. COOR: NAD 83(91)

N: 716170.648 INT FT.

E: 8864485.976 INT FT.

TYPE: GPS

THETA: 1 ° 50 ' 8.57757372 "

ORDER: SECOND CLASS: 1

SCALE FACTOR: 0.999923144

ELEV: 2761.46 US FT.

ELEV: DATUM: NGVD 29

COMMENTS:

Corner monument is set 6" below ground
in farm field with fence post 1+/- ft. North

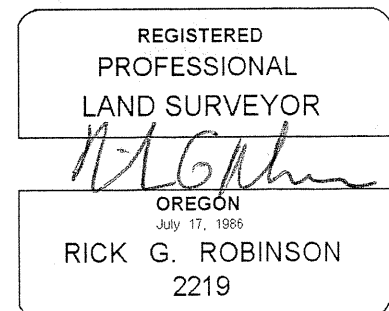
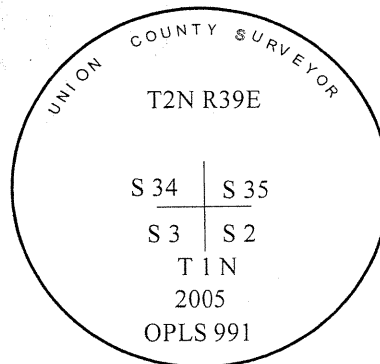

Renewal Date: December 31, 2014

1 METER = 3.280833333... US FEET = 39.37 INCHES

1 METER = 3.280839895 INT'L FEET OR 1 INCH = 2.54 CM

TO CALCULATE ELEVATION FACTOR (IN THE NORTH AMERICAN CONTINENT)

DIVIDE 20,906,000 BY (20,906,000 + ELLIPSOID ELEV. IN FEET)