

UNION COUNTY SURVEYOR

CERTIFIED RECORD OF LAND CORNER MONUMENTATION

HISTORY OF ORIGINAL CORNER ESTABLISHMENT:

Corner originally established by Rufus S. Moore under GLO contract Number 382, dated March 23, 1881. GLO record states:

Set post for 1/4 Sec. Cor. from which:

A Pine 6 in Diam bears N 30° E 256 lks dist
A Pine 24 in Diam bear S 57° W 275 lks dist

T 2 N R 40 E R-11

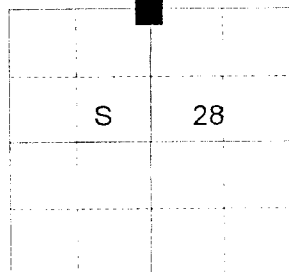

No record of further monumentation found in Union County survey records.

DESCRIPTION OF CORNER EVIDENCE FOUND:

NONE

See Survey Number 023-1998

DESCRIPTION OF MONUMENT AND ACCESSORIES I ESTABLISHED TO PERPETUATE THE ORIGINAL LOCATION OF THIS CORNER:

At surveyed position, I set a 5/8" x 24" Copper Clad with 2 1/2" Brass Cap as shown, 28 inches in the ground from which:

NEW BEARING OBJECTS AND TREES:

A 5/8" x 30" Iron Rebar with 1 1/2" Aluminum Cap bears N 16° E, a distance of 29.05 feet, marked NE RP.

A P.K. nail in Power Pole 3.00 feet off ground bears S 72° E, a distance of 92.31 feet, Power Pole # 018215100

A 5/8" x 30" Iron Rebar with 1 1/2" Aluminum Cap bears S 14° W, a distance of 36.92 feet, marked SW RP

A 5/8" x 30" Iron Rebar with 1 1/2" Aluminum Cap bears N 27° W, a distance of 28.83 feet, marked NW RP

I hereby certify that the corner was monumented on June 15, 1998.
Witness: Jeff Madsen and Greg Blackman Jr.

REGISTERED
PROFESSIONAL
LAND SURVEYOR

Gregory T. Blackman

OREGON
JULY 13, 1973
GREGORY T. BLACKMAN
991

Renewal Date: December, 31 1999

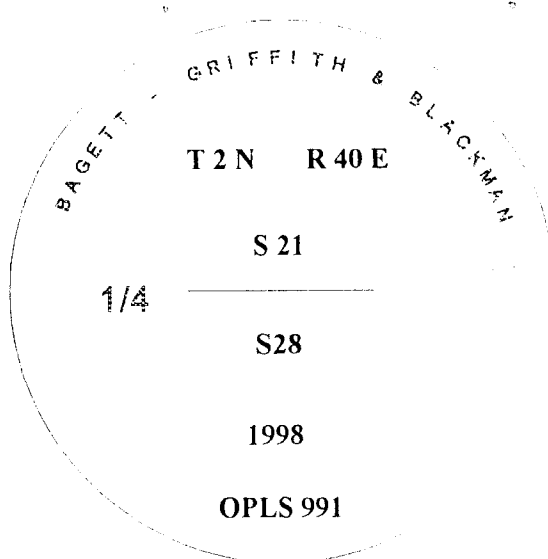

UNION COUNTY SURVEYOR

Date Received 7/20/98

Date Filed 8/29/98

Filed By R. ROBINSON, DEPUTY

File Number 033-1998R

I used a steel tape and magnetic compass in the establishment of the new accessories. I used 18° East declination, the distances are to the center of the reference object.

HORIZONTAL CONTROL DATA
UNION COUNTY, OREGON
OREGON STATE PLANE, NORTH ZONE (3601)

STA NAME: 200532

1/4 SECTION CORNER COMMON TO SECTIONS 21 and 28

TWP. 2 N. RGE. 40 E.

GEODETIC COORD: NAD 83(91)

DATE TIED: August 18, 2005

LAT: 45 ° 37 ' 54.71215 " N

SURVEYOR: RICK G. ROBINSON
OPLS 2219

LONG: 117 ° 49 ' 6.726878 " W

FIRM: BAGETT, GRIFFITH, & BLACKMAN
2006 Adams Avenue
La Grande, OR 97850
(541) 963-6092

SP. COOR: NAD 83(91)

N: 727848.423 INT FT.

E: 8887909.205 INT FT.

TYPE: GPS

THETA: 1 ° 54 ' 5.96631517 "

ORDER: SECOND CLASS: 1

SCALE FACTOR: 0.9999272307

ELEV: 3314.49 US FT.

ELEV: DATUM: NGVD 29

COMMENTS:

30" copper clad iron pin with
2 1/2" brass cap monument marked:

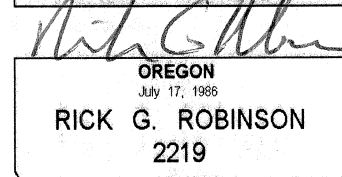
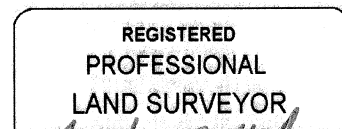
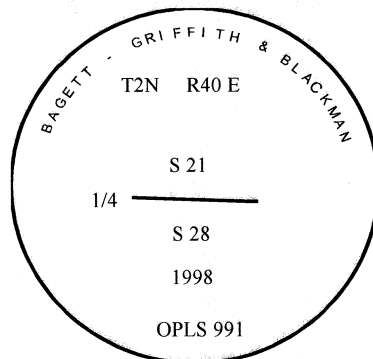

Renewal Date: December 31, 2006

1 METER = 3.2808333333... US FEET = 39.37 INCHES

1 METER = 3.280839895 INT'L FEET OR 1 INCH = 2.54 CM

TO CALCULATE ELEVATION FACTOR (IN THE NORTH AMERICAN CONTINENT)

DIVIDE 20,906,000 BY (20,906,000 + ELLIPSOID ELEV. IN FEET)