

**CERTIFIED RECORD OF LAND CORNER MONUMENTATION**

**HISTORY OF ORIGINAL CORNER ESTABLISHMENT:**

Corner established by David P. Thompson under GLO Contract number 103, dated September 3, 1863. Surveyor General record states: Set post in edge of timber for cor to secs 8,9,16,17 from which: A larch 15 in dia bears N53W 31 lks, A larch 15 in dia bears N38E 33 lks, A larch 15 in dia bears S40E 36 lks, A larch 15 in dia bears S6W 20 lks. Corner visited by Henry Meldrum under GLO Contract number 450, dated June 11, 1882. Surveyor General record states: Removed marks on post and trees referring to secs 16 and 17

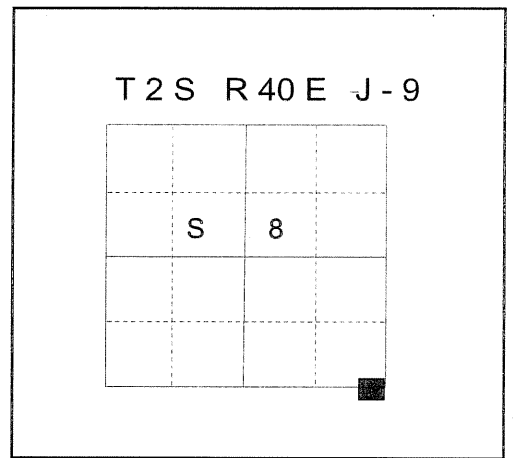

No record of subsequent monumentation found in UNION COUNTY survey records.

**DESCRIPTION OF CORNER EVIDENCE FOUND:**

Found stone 20x11x6 inches, firmly set 8 inches in the ground with chisel marks on West face. Accepted as the best available evidence of the original corner position.

**DESCRIPTION OF MONUMENT AND ACCESSORIES I ESTABLISHED**

**TO PERPETUATE THE ORIGINAL LOCATION OF THIS CORNER:**

At position of the stone, I set a 2 1/2" x 30" monument with aluminum cap marked as shown below, 28" in the ground, from which:

**NEW BEARING TREES:**

A 16" diameter White Fir bears N51°E, a distance of 8.06 feet, marked "S9 BT"  
A 10" diameter White Fir bears S84°W, a distance of 19.35 feet, marked "T2S R40E S17 BT"  
A 12" diameter White Fir bears N76°W, a distance of 13.33 feet, marked "T2S R40E S8 BT"  
An 8" diameter White Fir bears N32°W, a distance of 31.20 feet, marked "X BT"

Buried the found stone West and alongside of monument.

I hereby certify that the corner was monumented on July 6, 2004.

Witness: Mike Spicer

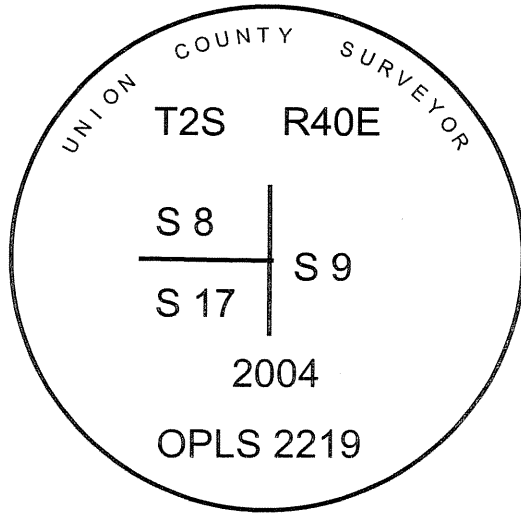
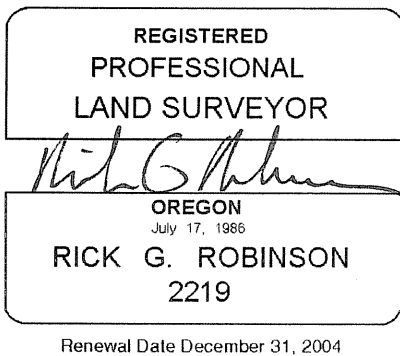

**UNION COUNTY SURVEYOR**  
Date Received 7/17/04  
Date Filed 7/17/04  
Filed By [Signature]  
File Number 037-2004R

I used a steel tape and magnetic compass in the establishment of new bearing trees. The magnetic declination used was 18° East. The distance to the bearing tree is to a 50d spike driven on the right side of the tree at the root crown. I attached a brass washer marked OPLS 2219 to the BT blaze.

**HORIZONTAL CONTROL DATA**  
**UNION COUNTY, OREGON**  
**OREGON STATE PLANE, NORTH ZONE (3601)**

STA NAME: 200411

SECTION CORNER COMMON TO SECTIONS 8 AND 17 ONLY

TWP. 2 S. RGE. 40 E.

GEODETIC COORD: NAD 83(91)

DATE TIED: JULY, 2004

LAT: 45 ° 23 ' 55.30896 " N

SURVEYOR: RICK G. ROBINSON  
OPLS 2219

LONG: 117 ° 49 ' 45.72509 " W

FIRM: BAGETT, GRIFFITH, & BLACKMAN  
2006 ADAMS AVENUE  
LAGRANDE, OR 97850  
(541) 963-6092

SP. COOR: NAD 83(91)

N: 642788.554 INT FT.

E: 8887949.355 INT FT.

TYPE: GPS

THETA: 1 ° 53 ' 38.3093251 "

ORDER: SECOND CLASS: 1

SCALE FACTOR: 0.999902621

ELEV: 4512.89 US FT.

ELEV: DATUM: NGVD 29

**COMMENTS:**

Corner is 2 1/2" aluminum monument  
Approximately 500 feet West of Road  
Near Fence corner North-East

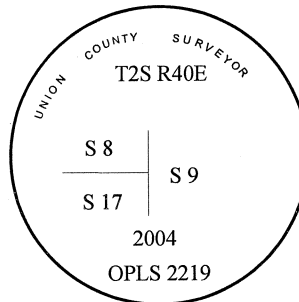

Renewal Date December 31, 2004

1 METER = 3.2808333333... US FEET = 39.37 INCHES

1 METER = 3.280839895 INT'L FEET OR 1 INCH = 2.54 CM

TO CALCULATE ELEVATION FACTOR ( IN THE NORTH AMERICAN CONTINENT)

DIVIDE 20,906,000 BY (20,906,000 + ELLIPSOID ELEV. IN FEET)