

History of original corner establishment:

Corner originally established by John A. Hurlburt under GLO contract number 201 dated August 5, 1873. Surveyor General record states:

Set tamarack post 4 ft long 4 ins square 2 ft in ground for cor to secs 11-12-13 and 14 from which:

- A tamarack 15 in dia S60°W 18 lks
- A pine 34 in dia S24°E 78 lks
- A pine 18 in dia N62°E 44 lks
- A tamarack 15 in dia N69°W 58 lks

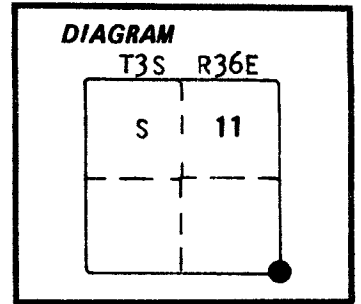

No record of subsequent remonumentation found

Description of corner evidence found:

Found 32 inch diameter tamarack N69°W 58 lks with blaze evident, I opened and found scribing. The tree is alive, but with a dead top

No evidence of any other original BTs or the original post

The corner falls in the traveled portion of County Road number 2

Description of monument and accessories I established to perpetuate the original location of this corner: At record bearing and distance from the found BT, I set a 2 1/2"x30" aluminum pipe with aluminum cap marked as shown, with the top of the cap 6 inches below the roadway, from which:

New BTs

- A 19 inch diameter Tamarack bears N10°E 132.45 feet marked T3S R36E S12 BT
- A 20 inch diameter P.Pine bears S6°E 125.38 feet marked T3S R36E S13 BT
- A 19 inch diameter P.Pine bears S30°W 91.11 feet marked T3S R36E S14 BT
- A 15 inch diameter P.Pine bears N55°W 61.63 feet marked T3SR36ES11BT

Corner remonumented May 1, 1986

Witnesses: Greg Blackman and Rick Robinson

I used a steel tape and magnetic compass in the establishment of these accessories. I used 20° East magnetic declination and the distances to the new BTs are to a 50d spike driven into the root crown of the right side of the tree. The distance to the existing BT is to the chaining notch. I attached a brass washer marked OPLS 644 to the BT blaze of the new BTs.

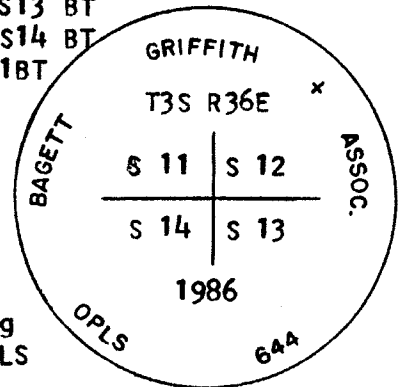

REGISTERED PROFESSIONAL LAND SURVEYOR

Handwritten signature of Duane I. Griffith

OREGON JULY 10, 1984 DUANE I. GRIFFITH 644

UNION COUNTY SURVEYOR

Date Received 5-5-86

Date Filed 5-5-86

By G. LANGLITZ DEPUTY

File No. 34-86 R

Office of..... County of.....

State of..... I hereby certify that the within instrument was filed in this office

for record on the..... day of....., 19.....

..... by

(COUNTY OFFICIAL) (DEPUTY)

HORIZONTAL CONTROL DATA

UNION COUNTY, OREGON

OREGON STATE PLANE, NORTH ZONE (3601)

STA NAME: 201524

SECTION CORNER COMMON TO SECTIONS 11, 12, 13 AND 14

TWP. 3 S. RGE. 36 E.

GEODETIC COORD: NAD 83(91)

DATE TIED: August 24, 2015

LAT: 45 ° 18 ' 40.06405 " N

SURVEYOR: RICK G. ROBINSON
OPLS 2219

LONG: 118 ° 15 ' 45.50343 " W

FIRM: BAGETT, GRIFFITH, & BLACKMAN
2006 ADAMS AVENUE
LAGRANDE, OR 97850
(541) 963-6092

SP. COOR: NAD 83(91)

N: 607494.349 INT FT.

E: 8777595.321 INT FT.

TYPE: GPS

THETA: 1 ° 35 ' 12.1363408 "

ORDER: SECOND CLASS: 1

SCALE FACTOR: 0.9998976632

ELEV: 3212.85 US FT.

ELEV: DATUM: NGVD 29

COMMENTS:

2 ½" aluminum cap monument marked
as shown in centerline of County Road
12" below road surface

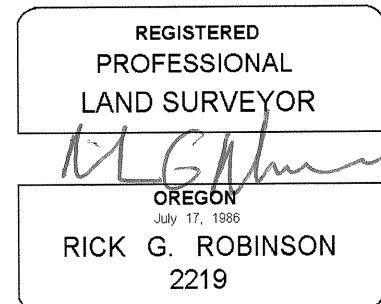
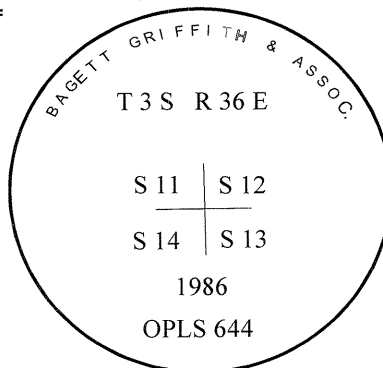

Renewal Date: December 31, 2016

1 METER = 3.2808333333... US FEET = 39.37 INCHES

1 METER = 3.280839895 INT'L FEET OR 1 INCH = 2.54 CM

TO CALCULATE ELEVATION FACTOR (IN THE NORTH AMERICAN CONTINENT)

DIVIDE 20,906,000 BY (20,906,000 + ELLIPSOID ELEV. IN FEET)