

Index
 File No. R11 CORNER RECORD (SEARCH) (Ref. FSM 7151.4) Tract or Survey No. _____ Cor. N $\frac{1}{4}$ Cor No. Sec 28
 T 3S R. 36E R.D. La Grande County Union
 Merid. Willamette N.F. W-W State Oregon

CORNER DIAGRAM

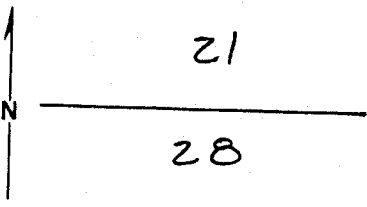

DESCRIBE CORNER MONUMENT FOUND

Basalt stone 20 x 12 x 6 inches, 6 inches above the ground in good condition with $\frac{1}{4}$ on N. face. This stone was in small mound of stone. I streightened it up and built a fairly large stone collar around the corner stone.

DESCRIBE BEARING TREES OR OTHER OFFICIAL ACCESSORIES FOUND

Root hole of a 18" PP bears N. $45\frac{1}{2}^{\circ}$ E 180 lks.

PHOTO IDENTIFICATION DATA

Photo No. _____
 Filed At. _____
 Object Ident. _____
 Ident. By _____

DESCRIBE CORNER LOCATION RELATIVE TO NEAR-BY FEATURES, ALSO HOW TO REACH CORNER

Corner point is loated at lower(West) toe of old log road. Also about $1\frac{1}{2}$ chains west of usable jeep trail and visable from same, that is, my posters are.

PLANE COORDINATE POSITION DATA

State _____ Zone _____
 X _____
 Y _____
 Estab. By _____
 Agency _____

Signature
 John Mitchel

Title _____ Division _____ Headquarters _____

Date 9/7/76 7100-52-(3,68)

UNION COUNTY SURVEYOR	
Date Received _____	
Date Filed <u>12-21-87</u>	
By <u>G. LANGLITZ, Deputy</u>	
File No. <u>265-87R</u>	

R-11

CERTIFIED RECORD OF LAND CORNER MONUMENTATION

History of original corner establishment:

Corner originally established by John A. Hurlburt under GLO contract number 201, dated August 5, 1873. Surveyor General record states:

Set basalt stone 18x12x6 8 in in ground and made stone mound 2 ft high for 1/4 sec cor

Pine 15 in dia N45 1/2°E 180 lks
No other near.

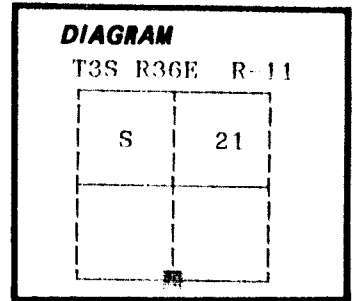

No record of subsequent monumentation found in Union County survey records.

Description of corner evidence found:

Found a stone 18x12x6 inches marked 1/4

Found a stump hole N45 1/2°E, 180 lks

See Union County Survey Number 25-89

Description of monument and accessories I established to perpetuate the

original location of this corner: In place of the found original corner stone, I set a 2 1/2" x 30" aluminum pipe with aluminum cap marked as shown, 10 inches in the ground, from which;

New Bearing Trees;

A 21 inch diameter Ponderosa Pine bears S36°E, 344.41 feet marked 1/4 S28 BT

A 18 inch diameter Ponderosa Pine bears N19°W, 112.88 feet marked 1/4 S21 BT (nail on left)

Raised a mound of stone around monument, 4 ft. base to top of cap.
Buried the original corner stone North and alongside monument.

Painted a 6 inch red band around all BTs and attached Bearing Tree and Land Survey Monument signs.

Set a steel fencepost approximately 5 feet North with 54-9 sign attached.

I hereby certify that the above corner point was perpetuated as hereon described on August 29, 1989.

Witness: Jeff Petersen

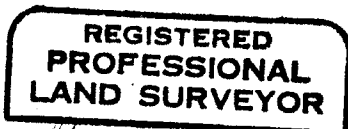
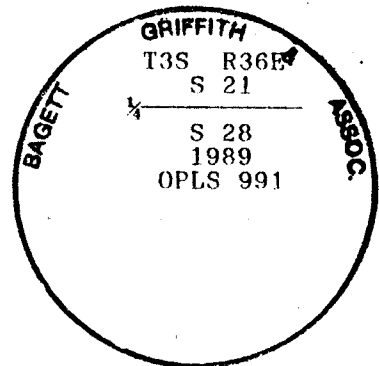

Gregory T. Blackman

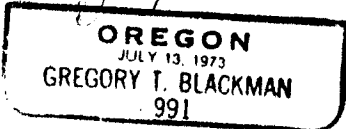

I used a steel tape and magnetic compass in the establishment of new accessories. I used 17° magnetic declination. The distances are to a 50d spike driven in the right side of the root crown. I attached a brass washer marked OPLS 991 to the BT blaze.

Office of..... County of.....
State of..... I hereby certify that the within instrument was filed in this office
for record on the..... day of.....

(COUNTY OFFICIAL)

(DEPUTY)

UNION COUNTY SURVEYOR

Date Received 11-14-89

Date Filed 11-14-89

By R. ROBINSON, DEPUTY

File No. 221-89R

Form R6-7100-57 (9/71)

*GPO-591-971, 1988