

Index File No. V 7

**CORNER RECORD (SEARCH)** (Ref. FSM 7151.4) Tract or Survey No. \_\_\_\_\_ Cor. No. S 14 Cor Sec 29

T 3S R. 36E R.D. La Grande County Union

Merid. Willamette N.F. W-W State Oregon

CORNER DIAGRAM

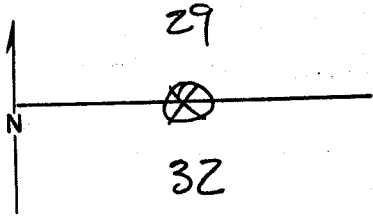

DESCRIBE CORNER MONUMENT FOUND

None

DESCRIBE BEARING TREES OR OTHER OFFICIAL ACCESSORIES FOUND

22" green Western Larch bears N. 17° E. 25 lks. dist. with healed blaze

14" down and decayed Western Larch bears S. 31° E. 52 lks. dist. with full scribing on slab on N side of close to ground

PHOTO IDENTIFICATION DATA

Photo No. \_\_\_\_\_

Filed At. \_\_\_\_\_

Object Ident. \_\_\_\_\_

Ident. By \_\_\_\_\_

Signature

PLANE COORDINATE POSITION DATA

State \_\_\_\_\_ Zone \_\_\_\_\_

X \_\_\_\_\_

Y \_\_\_\_\_

Estab. By \_\_\_\_\_

Agency

Signature  
John Mitchel

Title

Division

Headquarters

Date  
9/2/76

7100-52-(3,68)

**UNION COUNTY SURVEYOR**

---

Date Received \_\_\_\_\_

Date Filed 12-21-87

By G. LANGLITZ, DEPUTY

File No. 268-87R

V-7