

**UNION COUNTY SURVEYOR**

**CERTIFIED RECORD OF LAND CORNER MONUMENTATION**

**HISTORY OF ORIGINAL CORNER ESTABLISHMENT:**

Corner originally established by Timothy W. Davenport under GLO contract Number 102, dated July 20, 1863. Surveyor General record states: Set post, in mound of stone from which: A Pine 24" dia. bears S85°E, 168lks.

No record of subsequent monumentation found in Union County survey records.

**DESCRIPTION OF CORNER EVIDENCE FOUND:**

NONE

See Union County Survey 009-1996

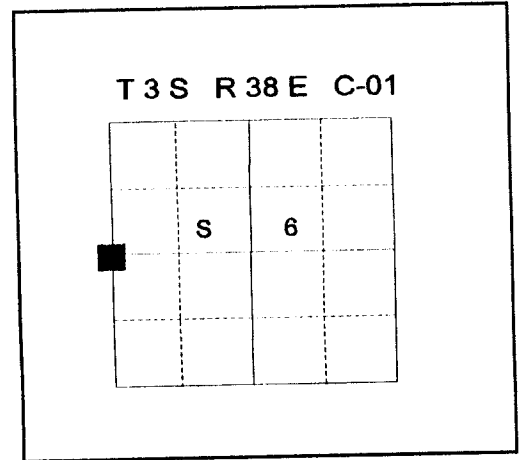

**DESCRIPTION OF MONUMENT AND ACCESSORIES I ESTABLISHED TO PERPETUATE THE ORIGINAL LOCATION OF THIS CORNER:**

At position determined by survey I set a 2½" x 30" aluminum pipe with 2½" cap marked as shown below, 27" in the ground, with a ring of stone, from which:

- A 8" Ponderosa Pine bears N16°E, 51.65 feet, marked 1/4 S6 R38 BT.
- A 9" Ponderosa Pine bears S76°E, 65.45 feet, marked 1/4 S6 BT.
- A 17" Ponderosa Pine bears S16°W, 88.50 feet, marked 1/4 S1 R37 BT.
- A 18" Ponderosa Pine bears N75°W, 88.68 feet, marked 1/4 S1 BT.

Placed steel fence post approximately 5 feet north with land survey monument sign attached.

I hereby certify that the corner was monumented on March 4, 1996.  
Witness: Mark Durbin, Pete Elder

REGISTERED  
PROFESSIONAL  
LAND SURVEYOR

*Jeffery P. Petersen*

OREGON  
JULY 20, 1993  
JEFFERY P. PETERSEN  
2625

Renewal Date: December, 31 1996

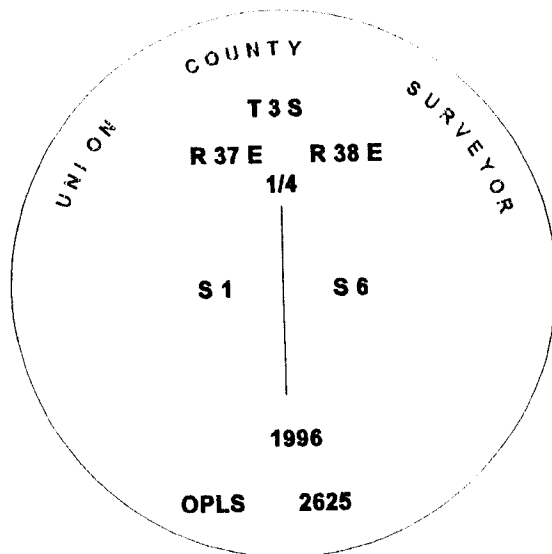

**UNION COUNTY SURVEYOR**

Date Received 3-19-96

Date Filed 3-20-96

Filed By *Gwyn T. Clark*

File Number 032-1996 R

I used a steel tape and magnetic compass in the establishment of the new accessories. I used 17° East declination, the distances are to a 60d spike driven into the root crown at the right side of the bearing trees. Attached brass washer to BT blaze.

C-01

# HORIZONTAL CONTROL DATA

OREGON STATE PLANE, NORTH ZONE (3601)

LaGRANDE & ISLAND CITY, UNION COUNTY OREGON

STA. NAME: 9619

QUARTER CORNER TO: 1 & 6

TWP.3S, RGE.37 & 38E, W.M.

DATE FD.: MARCH, 1996

SURVEYOR: WALTER L. CASWELL  
PLS 737

FIRM: EAGLE GPS SURVEY CORP  
6110 S.W. LOMBARD AVE.  
BEAVERTON, OR. 97008  
(503) 643-1073

TYPE: GPS

ORDER: SECOND CLASS: 2

GEODETIC COOR: NAD 83(91)

LAT: 45°19'58.51942" N

LONG: 118°06'59.66852" W

SP. COOR: NAD 83(91)

N: 616510.855 INT.FT.

E: 8814921.408 INT.FT.

THETA: 1°41'25.051"

SCALE FACTOR: 0.999898679

ELEV: 3456.676 US.FT.

ELEV. DATUM: NGVD 29

\*\*\*\*\*  
DIRECTIONS "TO REACH"

REGISTERED  
PROFESSIONAL  
LAND SURVEYOR



OREGON  
JULY 8, 1966  
WALTER L. CASWELL  
737

EXPIRES 12/31/97

1 meter = 3.280833... U.S. Feet = 39.37 inches exactly  
1 meter = 3.280839895 Intl. Feet or 1 inch = 2.54cm. exactly  
To Calculate Elevation Factor (in the North American Continent)  
Divide 20,906,000 by (20,906,000 + Ellipsoid Elev. in Feet)

JOB 96-007  
SHEET 33 OF 66