

CERTIFIED RECORD OF LAND CORNER MONUMENTATION

HISTORY OF ORIGINAL CORNER ESTABLISHMENT:
Corner not previously established

T 3 S R 38 E E - 18

DESCRIPTION OF CORNER EVIDENCE FOUND:
None

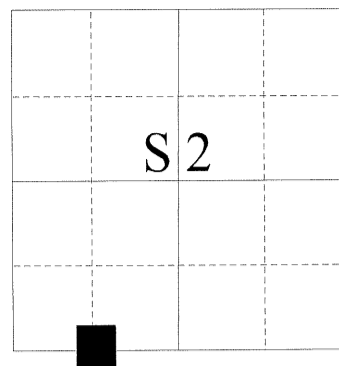

See Survey Number 009-2010

DESCRIPTION OF MONUMENT AND ACCESSORIES I ESTABLISHED TO PERPETUATE THE ORIGINAL LOCATION OF THIS CORNER:

At position determined by survey, I set a 5/8" x 30" iron pin with 2 1/2" Aluminum cap marked as shown, 30" in the ground, from which:

NEW ACCESSORIES:

A 5/8" x 30" iron pin bears North 0°24'17" East, a distance of 4.35 feet, with plastic cap marked BGB SURVEY MARKER.

A 5/8" x 30" iron pin bears North 72°18'08" East, a distance of 94.03 feet, with plastic cap marked BGB SURVEY MARKER.

I hereby certify that the above corner point was monumented as hereon described on April 19, 2010.

Witness: Jeff Hsu, Gregory T. Blackman, Jr.

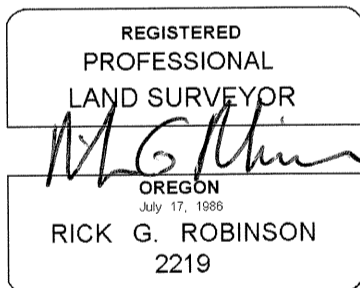

Renewal Date: December 31, 2010

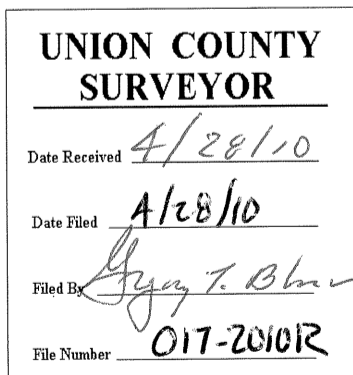
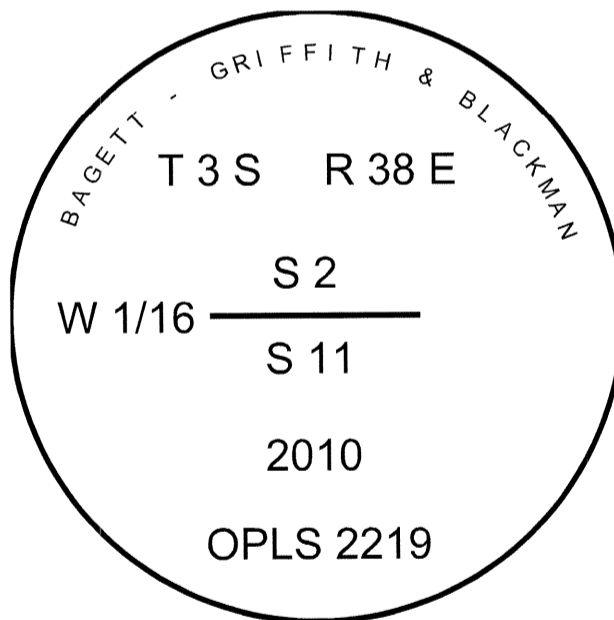

I used a Leica 1200 RTK GPS in the establishment of the accessories. The bearings and distances are to the center of plastic cap. Basis of Bearing is the same as Union County Survey Number 009-2010.