

CERTIFIED RECORD OF LAND CORNER MONUMENTATION

HISTORY OF ORIGINAL CORNER ESTABLISHMENT:

Corner originally established by David P. Thompson under GLO contract number 103, dated September 3, 1863 Surveyor General record states:

Set post for 1/4 cor in mound of earth with charred stake.

No record of subsequent monumentation found in Union County survey records.

DESCRIPTION OF CORNER EVIDENCE FOUND:

None.

See Survey No. 005-2009

DESCRIPTION OF MONUMENT AND ACCESSORIES I ESTABLISHED

TO PERPETUATE THE ORIGINAL LOCATION OF THIS CORNER:

At proportionate position as determined by Survey No. 005-2009 I set a 2½" x 30" aluminum pipe with aluminum cap marked as shown, 25 inches in the ground, from which:

A 5/8" X 30" rebar bears North 37°10'43" East, 38.94 feet, with 1 ½" aluminum cap marked "BGB SURVEY MARKER NE RP"

A 5/8" X 30" rebar bears South 63°49'42" East, 31.55 feet, with 1 ½" aluminum cap marked "BGB SURVEY MARKER SE RP"

A 5/8" X 30" rebar bears South 43°17'25" West, 18.99 feet, with 1 ½" aluminum cap marked "BGB SURVEY MARKER SW RP"

A 5/8" X 30" rebar bears North 45°30'05" West, 49.37 feet, with 1 ½" aluminum cap marked "BGB SURVEY MARKER NW RP"

Set a steel fencepost with bearing tree tag attached South 2 feet.

I hereby certify that the above corner point was monumented as hereon described on March 11, 2009.

Witnesses: Jeff Hsu & Rick Robinson

T 3 S R 38 E J - 11

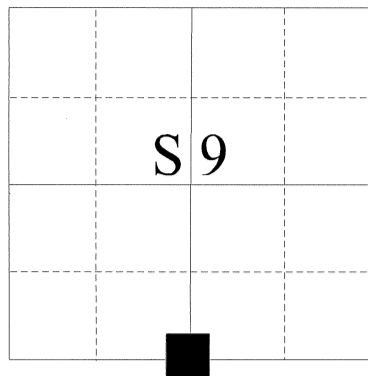

REGISTERED
PROFESSIONAL
LAND SURVEYOR

G. T. Blackman
OREGON
JULY 13, 1973
GREGORY T. BLACKMAN
991

Renewal Date: Dec. 31, 2007

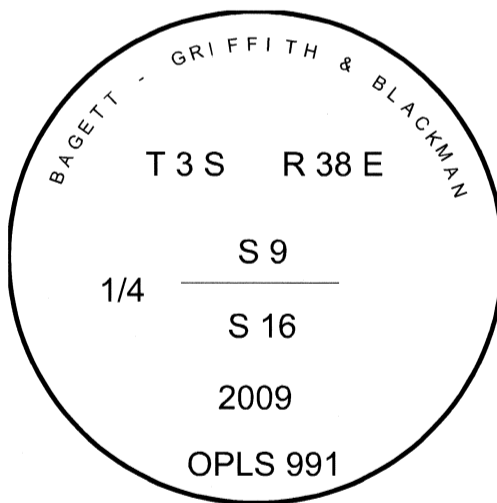

UNION COUNTY
SURVEYOR

Date Received 3/31/09

Date Filed 3/31/09

Filed By R. Robinson Deputy

File Number 004-700912

The bearing and distance to the iron pins were determined by a GPS observation using a Leica 1200 base and receiver. The basis of bearing is that of Survey number CS 005-2009. The distances are to the center of the aluminum caps.

HORIZONTAL CONTROL DATA

UNION COUNTY, OREGON

OREGON STATE PLANE, NORTH ZONE (3601)

STA NAME: 200908

QUARTER CORNER BETWEEN SECTIONS 9 AND 16

TWP. 3 S RGE. 38 E.

GEODETIC COORD: NAD 83(91)

DATE TIED: March 12, 2009

LAT: 45 ° 18 ' 40.62266 " N

SURVEYOR: RICK ROBINSON
OPLS 2219

LONG: 118 ° 3 ' 57.23559 " W

FIRM: BAGETT, GRIFFITH, & BLACKMAN
2006 ADAMS AVENUE
LAGRANDE, OR 97850
(541) 963-6092

SP. COOR: NAD 83(91)

N: 609013.936 INT FT.

E: 8828184.815 INT FT.

TYPE: GPS

THETA: 1 ° 43 ' 34.4 "

ORDER: SECOND CLASS: 1

SCALE FACTOR: 0.99989767

ELEV: 2742.72 US FT.

ELEV: DATUM: NGVD 29

COMMENTS:

2 1/2" Aluminum cap located North of driveway entrance off of Gekeler Rd to the UPS building.

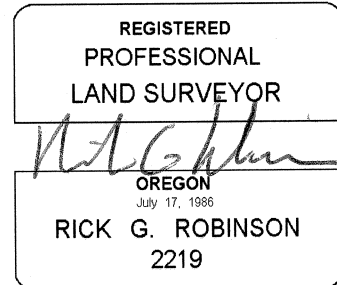
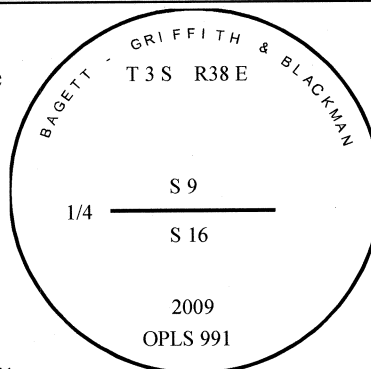

Renewal Date: December 31, 2010

1 METER = 3.2808333333... US FEET = 39.37 INCHES

1 METER = 3.280839895 INT'L FEET OR 1 INCH = 2.54 CM

TO CALCULATE ELEVATION FACTOR (IN THE NORTH AMERICAN CONTINENT)

DIVIDE 20,906,000 BY (20,906,000 + ELLIPSOID ELEV. IN FEET)