

CORNER RECORD

Town of _____ County of _____ Union _____, Oregon

Brief Legal Description Center-North 1/16 corner of Section 5, Township 4 South, Range 39 East, Willamette Meridian.

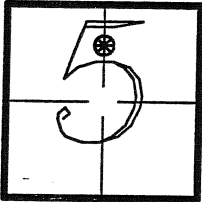

CORNER TYPE

Government Corner Control
Meander Property
D.L.C. Other
Date of Survey _____

COORDINATES (Optional)

N. 587291.75
E. 8855332.26
Zone OR N NAD27 NAD83

Meas. Units: Metric Imperial

Corner - Left as found Found and tagged Established Reestablished Rebuilt

Identification and type of corner found: Evidence used to identify or procedure used to establish or reestablish the corner:
Set 5/8" rod with red plastic cap stamped "NORTHSTAR PLS 1823" at the center-north 1/16 corner, established by proportionate measurements between the N and S 1/4 corners. of said Section 5. See map of survey No. 006-2013

A description of the physical condition of the monument as found and as set or reset: At a position set by survey, I set a 5/8" x 30" rebar with red plastic cap stamped "NORTHSTAR PLS 1823" which;

A 5/8" x 30" rebar bears S 89°43'00" W at 494.33 feet, with a red plastic cap stamped "NORTHSTAR PLS 1823"

A 5/8" x 30" rebar bears N 89°54'23" E at 436.39 feet, with a red plastic cap stamped "NORTHSTAR PLS 1823"

SURVEYOR'S STATEMENT

This Corner Record was prepared by me or under my direction,

on _____ 20 ____

Signed _____ P.L.S. No. 1823

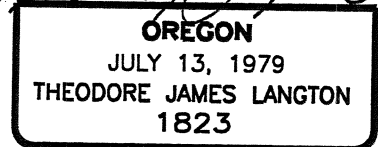
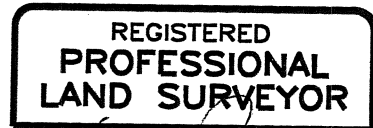

RENEWS: 12/31/2014

UNION COUNTY SURVEYOR

Date Received 2/28/13

Date Filed 3/1/13

By [Signature]

File No. 007-2013R