

CERTIFIED RECORD OF LAND CORNER MONUMENTATION

HISTORY OF ORIGINAL CORNER ESTABLISHMENT:

Corner originally established by Timothy W. Davenport under GLO contract Number 102, dated July 20th, 1863. Surveyor General record states: "Set post corner to secs 1, 6, 31, 36 and Townships 3+4 South Ranges 39+40 East made mound of earth and drove charred stake as per inst"

Old Book Survey 4 Page 7 dated April 7th, 1887 by J.W. Kimbrell states, "I commenced at...a stone said to be placed by Willis Staff a former county surveyor..."

Oregon State Highway Dept. DRG. No. 6B-19-2, dated February 1946 states, "Split county road for corner"

No record of subsequent monumentation found in Union County Survey Records.

DESCRIPTION OF CORNER EVIDENCE FOUND:

NONE

See Survey No. 003-2003

DESCRIPTION OF MONUMENT AND ACCESSORIES I ESTABLISHED

TO PERPETUATE THE ORIGINAL LOCATION OF THIS CORNER:

At the intersection of Woodruff Road and a North-South fence I set a 2 1/2"x30" copper clad monument 34" in the ground, in a water valve box, from which;

NEW BEARING OBJECTS:

- A 5/8"x30" iron pin with 1 1/2" aluminum cap in a fence line bears North 40° East, a distance of 32.65 feet, marked UNION COUNTY SURVEYOR NE RM
- A 5/8"x30" iron pin with 1 1/2" aluminum cap in a fence line bears South 65° East, a distance of 35.32 feet, marked UNION COUNTY SURVEYOR SE RM
- A 5/8"x30" iron pin with 1 1/2" aluminum cap in a fence line bears South 48° West, a distance of 27.80 feet, marked UNION COUNTY SURVEYOR SW RM
- A 5/8"x30" iron pin with 1 1/2" aluminum cap in a fence line bears North 51° West, a distance of 34.12 feet, marked UNION COUNTY SURVEYOR NW RM

I hereby certify that the corner was monumented on December 11, 2002.

Witness: Norbert Volny, Gregory T. Blackman Jr., Greg Zollman

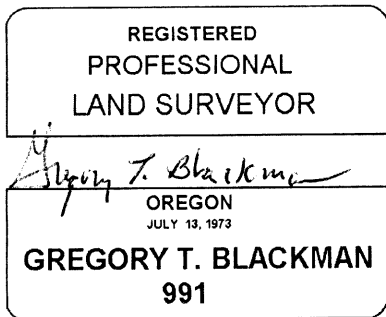
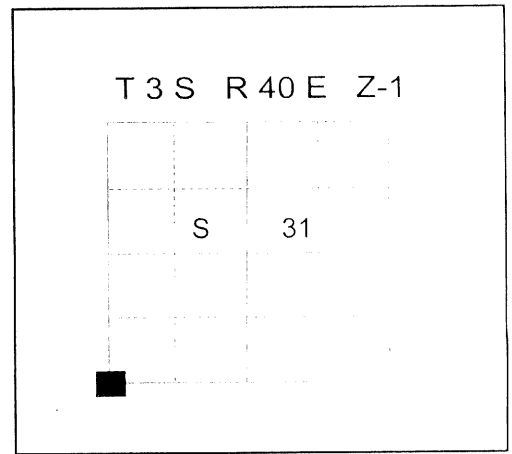

Renewal Date: December 31, 2003

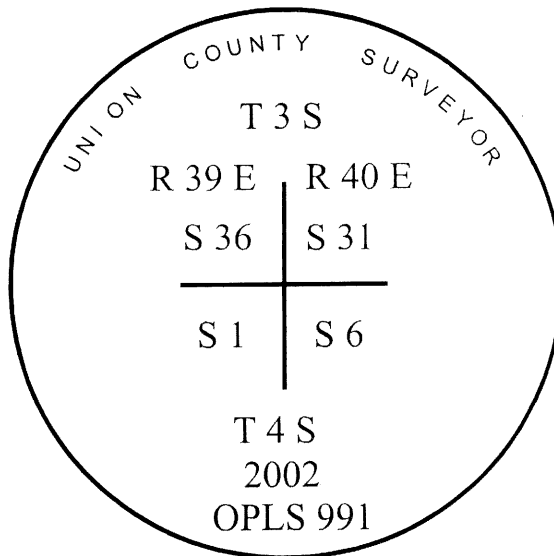

UNION COUNTY SURVEYOR

Date Received 2/18/03

Date Filed 2/18/03

Filed By R. Robinson, DEPUTY

File Number 009-2003 R

I used a steel tape and magnetic compass in the establishment of the new accessories. I used 18° East declination. The distances to the accessories are to the center of the aluminum cap.

HORIZONTAL CONTROL DATA

UNION COUNTY, OREGON

OREGON STATE PLANE, NORTH ZONE (3601)

STA NAME: 200201

CORNER COMMON TO: 1,6,31,36

TWP. 3&4 S. RGE. 39&40 E.

GEODETIC COORD: NAD 83(91)

DATE TIED: DEC. 2002

LAT: 45 ° 15 ' 11.88577 " N

SURVEYOR: GREGORY T. BLACKMAN
OPLS 991

LONG: 117 ° 52 ' 14.01290 " W

FIRM: BAGETT, GRIFFITH, & BLACKMAN
2006 ADAMS AVENUE
LAGRANDE, OR 97850
(541) 963-6092

SP. COOR: NAD 83(91)

N: 589460.033 INT FT.

E: 8879099.732 INT FT.

TYPE: GPS

THETA: 1 ° 51 ' 53.1456899 "

ORDER: SECOND CLASS: 1

SCALE FACTOR: 0.9998956688

ELEV: 2712.60 US FT.

ELEV: DATUM: NGVD 29

COMMENTS:

Corner is a 2 1/2" copper clad monument in water valve box at the intersection of centerline of Woodruff Lane and a fence to the North.

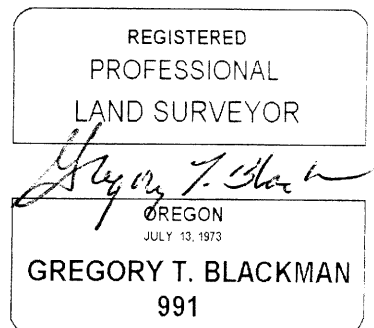
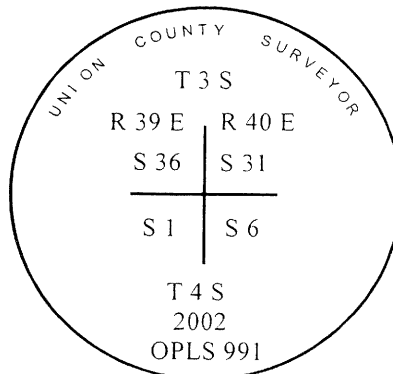

Renewal Date: December 31, 2003

1 METER = 3.2808333333... US FEET = 39.37 INCHES

1 METER = 3.280839895 INT'L FEET OR 1 INCH = 2.54 CM

TO CALCULATE ELEVATION FACTOR (IN THE NORTH AMERICAN CONTINENT)

DIVIDE 20,906,000 BY (20,906,000 + ELLIPSOID ELEV. IN FEET)