

**CERTIFIED RECORD OF LAND CORNER MONUMENTATION**

**HISTORY OF ORIGINAL CORNER ESTABLISHED:**

Corner not previously established

T 4 S R 41 E F-01

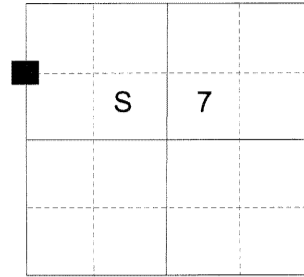

**DESCRIPTION OF CORNER EVIDENCE FOUND:**

None

See Survey Number 052-2015

**DESCRIPTION OF MONUMENT AND ACCESSORIES I ESTABLISHED TO PERPETUATE THE ORIGINAL LOCATION OF THIS CORNER:**

At the position determined by survey, I set a 5/8" x 30" iron rod with a 2 1/2" aluminum cap marked as shown below, 27" in the ground. From which:

**NEW BEARING OBJECTS:**

A 6" Ponderosa Pine bears South 74° East, a distance of 34.45 feet, marked N 1/16 S7 BT.  
A 5" Ponderosa Pine bears South 80° West, a distance of 13.95 feet, marked N 1/16 S12 BT.

I set a steel fencepost approximately 0.5 foot North of corner monument.

I hereby certify that the corner was monumented on August 28, 2015.

Witness: Thomas J. Kopp



Renewal Date: June 30, 2017

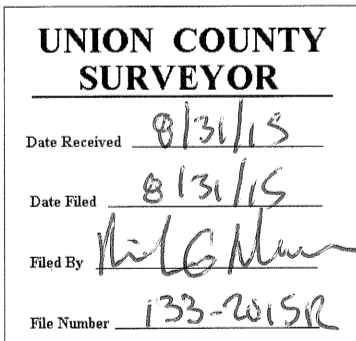
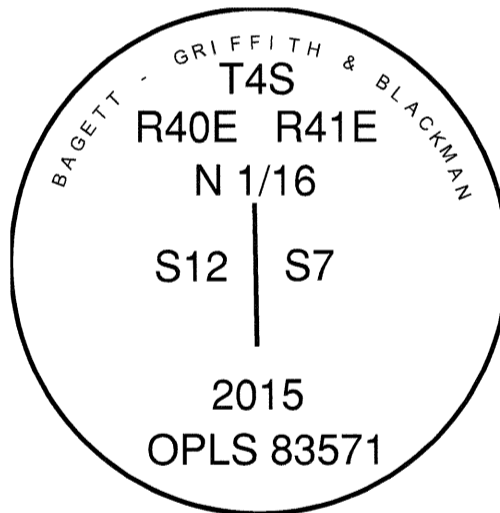

I used a steel tape and magnetic compass in the establishment of the new accessories. I used 15° East declination, the distances are to a 60d spike driven into the right side of the root crown of the bearing trees. A brass washer marked OPLS 83571 is attached to the BT blaze of the new bearing trees.