

CERTIFIED RECORD OF LAND CORNER MONUMENTATION

History of original corner establishment:

Corner originally established by Timothy W. Davenport under GLO contract number 102, dated July 20, 1863. Surveyor General record states:

Set qr sec post made mound of earth and drove charred stake as per inst.

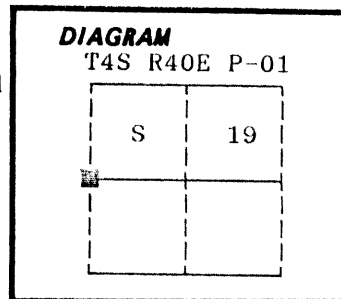

No record of subsequent monumentation found in Union County survey records.

Description of corner evidence found:

Found no evidence of the corner monument originally set by Davenport.

Found a 4 inch square concrete post. After discussions with people residing in the area, and survey locations of the existing fencelines and improvements, I accept this as being the quarter corner position.

See Union County survey number 29-89.

Description of monument and accessories I established to perpetuate the original location of this corner:

At the position of the found concrete monument, I set a 2½"x30" aluminum pipe with aluminum cap marked as shown, 30 inches in the ground.

I hereby certify that the above corner point was perpetuated as hereon described on September 21, 1989.

Witness: Rick Robinson

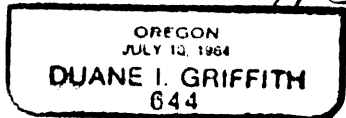
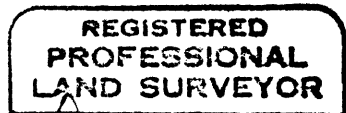
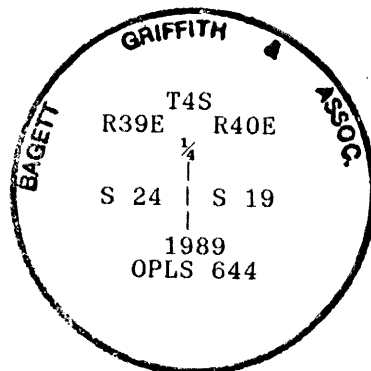

UNION COUNTY SURVEYOR

Date Received 10-16-89

Date Filed 10-24-89

By G. LANGLITZ

File No. 198-89R

Office of..... County of.....
 State of....., I hereby certify that the within instrument was filed in this office
 for record on the..... day of....., 19.....
 by
 (COUNTY OFFICIAL) (DEPUTY)

HORIZONTAL CONTROL DATA

UNION COUNTY, OREGON
OREGON STATE PLANE, NORTH ZONE (3601)

STA. NAME: 9306

QUARTER CORNER: 24 / 19

TWP. 4 S. RGE. 39 & 40 E.

DATE SET: OCT. 1993

SURVEYOR: WALTER L. CASWELL
PLS 737

FIRM: EAGLE GPS SURVEY CORP
13545 NW SCIENCE PARK DR
PORTLAND, OR. 97229
(503) 643-1073

TYPE: GPS

ORDER: SECOND CLASS: 1

GEODETTIC COOR: NAD 83(91)

LAT: 45°12'08.50148" N

LONG: 117°52'14.12044" W

SP. COOR: NAD 83(91)

N: 570897.784 INT.FT.

E: 8879696.373 INT.FT.

THETA: 1°51'53.069"

SCALE FACTOR: 0.999894754

ELEV: 2769.24 US.FT.

ELEV. DATUM: NGVD 29

DIRECTIONS "TO REACH": FROM MAIN STREET AND W. JEFFERSON STREET
ON THE SOUTH SIDE OF UNION, HEAD WEST ON W. JEFFERSON STREET TO
AN INTERSECTION WITH S. FOURTH STREET, NOTING THE HOUSE IN THE SW
CORNER OF THE INTERSECTION. CONTINUE WEST UNTIL YOU ARE ALONGSIDE
THE BACKYARD OF THE HOUSE. THE STATION IS THE AZIMUTH POINT TO
THE WEST QUARTER CORNER OF SECTION 19 AND IS A 60 PENNY SPIKE
IN A STUMP ABOUT 30 FEET SW OF THE 1/4 CORNER
MONUMENT.

REGISTERED
PROFESSIONAL
LAND SURVEYOR

Walter L. Caswell

OREGON
JULY 8, 1966
WALTER L. CASWELL
737

EXPIRES 12/31/95

1 METER = 3.280833333333... U.S. FEET = 39.37 INCHES
1 METER = 3.280839895 INT'L FEET OR 1 INCH = 2.54 CM.
TO CALCULATE ELEVATION FACTOR (IN THE NORTH AMERICAN CONTINENT)
DIVIDE 20,906,000 BY (20,906,000 + ELLIPSOID ELEV. IN FEET)
SHEET 7 OF 37

GEODETTIC CONTROL DATA

**OREGON STATE PLANE, NORTH ZONE (3601)
UNION COUNTY, OREGON**

STA. NAME: 9306

QUARTER CORNER
SEC. 24 | 19
T4S, R39E | T4S, R40E
UNION COUNTY, OREGON
DATE TIED: JULY, 1999

*THIS OBSERVATION
IS AN ECCENTRIC
TO THIS CORNER*

GEODETTIC COOR: NAD 83(91)
LAT: 45:12'08.84889" N
LONG: 117:52'14.00585" W

SURVEYOR: WALTER L. CASWELL
PLS 737

SP. COOR: NAD 83(91)
N: 570933.215 INT.FT

FIRM: EAGLE GPS SURVEY CORP
6110 SW LOMBARD AVE.
BEAVERTON, OR. 97008-4736
(503) 643-1073

E: 8879703.428 INT.FT.
THETA: 1:51'53.150"

TYPE: GPS

SCALE FACTOR: 0.999894755

ORDER: SECOND CLASS: 1

ELEV: 2769.41 U.S.FT.

ELEV. DATUM: NGVD 1929(1947)

DIRECTIONS "TO REACH":

*SEE
200137*

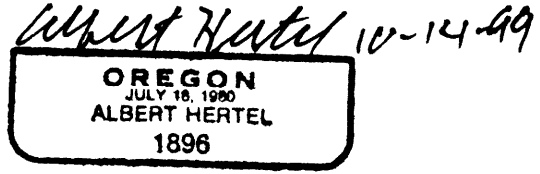
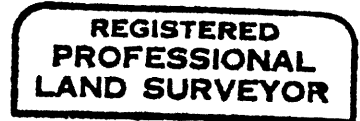

EXPIRES: 06/30/01
1 METER = 3.280833... U.S. FEET = 39.37 INCHES EXACTLY
1 METER = 3.280839895 INTL. FEET OR 1 INCH = 2.54CM. EXACTLY
TO CALCULATE ELEVATION FACTOR (IN THE NORTH AMERICAN CONTINENT)
DIVIDE 20,906,000 BY (20,906,000 + ELLIPSOID ELEV. IN FEET)

HORIZONTAL CONTROL DATA

UNION COUNTY, OREGON

OREGON STATE PLANE, NORTH ZONE (3601)

STA NAME: 200137

QUARTER CORNER COMMON TO: 24 & 19

| | |
|--|-------------------------------|
| TWP. 4 S. RGE. 39&40 E. | GEODETIC COORD: NAD 83(91) |
| DATE TIED: 11 DECEMBER 1993 | LAT: 45 ° 12 ' 8.84925 " N |
| SURVEYOR: WALTER L. CASWELL PLS 737 | LONG: 117 ° 52 ' 14.00665 " W |
| FIRM: EAGLE GPS SURVEY CORP 6110 SW LOMBARD AVE. BEAVERTON, OR. 97008-4736 (503) 643-1073 | SP. COOR: NAD 83(91) |
| | N: 570933.250 INT FT. |
| | E: 8879703.370 INT FT. |
| TYPE: TERRESTRIAL | THETA: 1 ° 51 ' 53.1501225 " |
| ORDER: SECOND CLASS: 1 | SCALE FACTOR: 0.9998947553 |
| | ELEV: 2769.37 US FT. |

ELEV: DATUM: NGVD 29

COMMENTS:

This is the true corner tied from the eccentric number 9306. Corner is against a railroad tie fence post. Tripod set-up not possible.

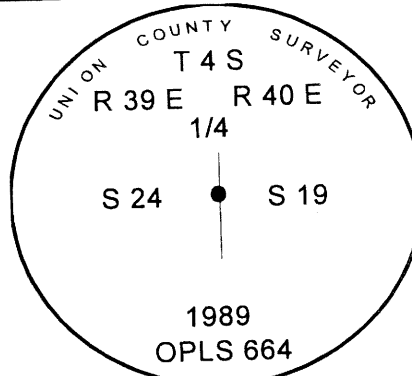

REGISTERED
PROFESSIONAL
LAND SURVEYOR

Gregory T. Blackman

OREGON
JULY 13, 1973

GREGORY T. BLACKMAN
991

Renewal Date: Dec. 31, 2001

1 METER = 3.2808333333... US FEET = 39.37 INCHES
 1 METER = 3.280839895 INT'L FEET OR 1 INCH = 2.54 CM
 TO CALCULATE ELEVATION FACTOR (IN THE NORTH AMERICAN CONTINENT)
 DIVIDE 20,906,000 BY (20,906,000 + ELLIPSOID ELEV. IN FEET)