

**CERTIFIED RECORD OF LAND CORNER MONUMENTATION**

**HISTORY OF ORIGINAL CORNER ESTABLISHMENT:**

No record of the establishment of a corner monument at this position.

Survey number 10-60 calls finding a marked stone for the center 1/4 corner.

Subsequent surveys have called finding the marked stone or "monument of record" at this position. Those surveys numbers are:

19-73	53-78	99-78	113-78	16-79
19-79	31-79	66-79	27-80	52-80
79-81	7-82	12-82	23-84	23-89

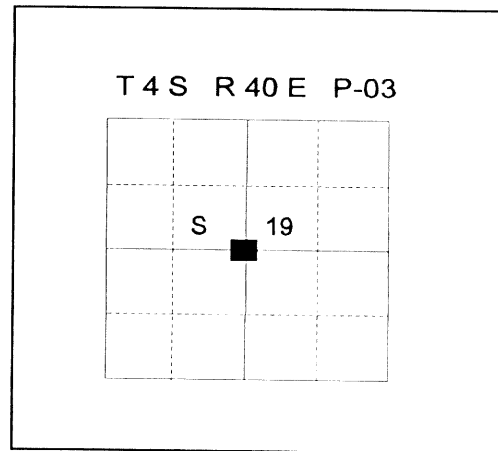

No record of subsequent monumentation found in UNION COUNTY survey records.

**DESCRIPTION OF CORNER EVIDENCE FOUND:**

At the corner position called in the above stated surveys, I found a stone 3"x8"x22" marked with a cross on top and 1/4 on the West face. Stone was firmly set with 3" of the stone exposed. Corner position falls 1 ft. North of an existing East-West fence.

See Survey Number 004-1997.

**DESCRIPTION OF MONUMENT AND ACCESSORIES I ESTABLISHED TO PERPETUATE THE ORIGINAL LOCATION OF THIS CORNER:**

In place of the stone, I set a 2 1/2" x 30" aluminum pipe with 2 1/2" aluminum cap marked as shown below, 30" in the ground.

**NEW BEARING OBJECTS:**

- A 5/8" x 30" iron pin with 1 1/2" aluminum cap bears N 2°09'W, 10.71 feet marked UNION COUNTY SURVEYOR NORTH RP.
- A 5/8" x 30" iron pin with 1 1/2" aluminum cap bears S 87°56'E, 8.32 feet marked UNION COUNTY SURVEYOR EAST RP. (Set in East-West fence)
- A 5/8" x 30" iron pin with 1 1/2" aluminum cap bears S 0°47'W, 12.78 feet marked UNION COUNTY SURVEYOR SOUTH RP.
- A 5/8" x 30" iron pin with 1 1/2" aluminum cap bears S 84°07'W, 7.19 feet marked UNION COUNTY SURVEYOR WEST RP. (Set in East-West fence)

Buried the found corner stone East and alongside aluminum monument. I hereby certify that the corner was monumented on January 20, 1997. Witnesses: Rick Robinson and Greg Blackman Jr.

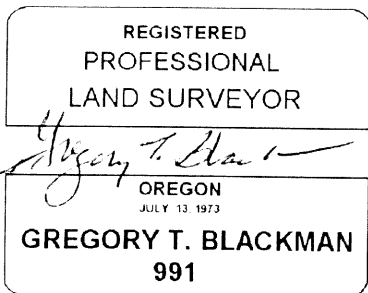

Renewal Date: December, 31 1997

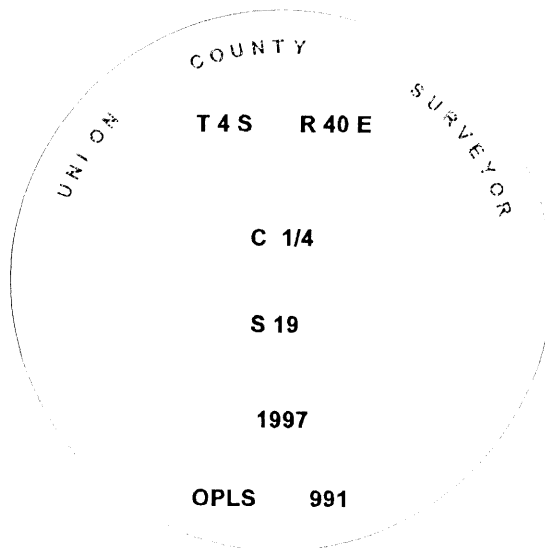

**UNION COUNTY SURVEYOR**

Date Received 1-29-97

Date Filed 1-29-97

Filed By R. Robinson, Deputy

File Number 001-1997R

I used a total station instrument in the establishment of the new accessories. I used the same solar observation as survey number 004-1997 as the basis of bearing.

**GEODETTIC CONTROL DATA**

**OREGON STATE PLANE, NORTH ZONE (3601)  
UNION COUNTY, OREGON**

\*\*\*\*\*

STA. NAME: 9935

CENTER OF SECTION

GEODETTIC COOR: NAD 83(91)

SEC.19 TWP.4 S. RGE.40 E  
UNION COUNTY, OREGON

LAT: 45:12'08.66695" N

DATE TIED: JULY, 1999

LONG: 117:51'37.16312" W

SURVEYOR: WALTER L. CASWELL  
PLS 737

SP. COOR: NAD 83(91)

FIRM: EAGLE GPS SURVEY CORP  
6110 SW LOMBARD AVE.  
BEAVERTON, OR. 97008-4736  
(503) 643-1073

N: 571000.801 INT.FT

E: 8882340.405 INT.FT.

THETA: 1:52'19.279"

TYPE: GPS

SCALE FACTOR: 0.999894755

ORDER: SECOND CLASS: 1

ELEV: 2793.13 U.S.FT.

ELEV. DATUM: NGVD 1929(1947)

\*\*\*\*\*

DIRECTIONS "TO REACH":

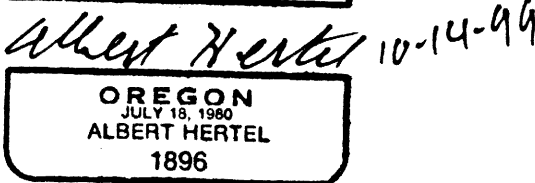
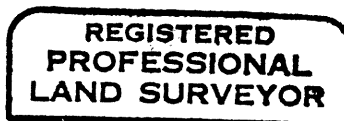

EXPIRES: 06/30/01

1 METER = 3.280833... U.S. FEET = 39.37 INCHES EXACTLY  
1 METER = 3.280839895 INTL. FEET OR 1 INCH = 2.54CM. EXACTLY  
TO CALCULATE ELEVATION FACTOR (IN THE NORTH AMERICAN CONTINENT)  
DIVIDE 20,906,000 BY (20,906,000 + ELLIPSOID ELEV. IN FEET)

JOB 99-005

SHEET 52 OF 63