

**CERTIFIED RECORD OF LAND CORNER MONUMENTATION**

**HISTORY OF ORIGINAL CORNER ESTABLISHMENT:**

Corner originally established by David P. Thompson. GLO contract number 103, dated September 3, 1882. Surveyor General Record states:

Set a wooden post in mound of stone.

No subsequent monumentation found in Union County survey records.

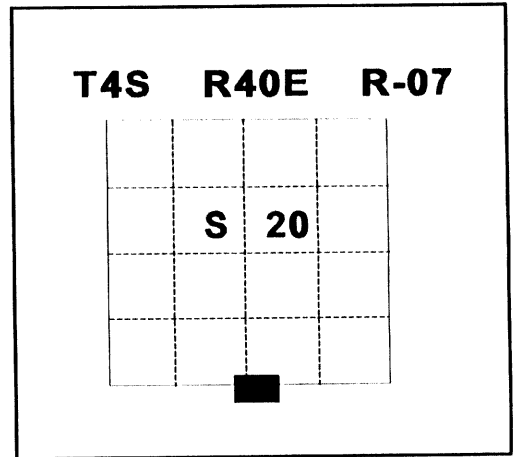

**DESCRIPTION OF CORNER EVIDENCE FOUND:**

Ancient rock jack fence corner.

See Union County Survey Number 017-1997.

**DESCRIPTION OF MONUMENT AND ACCESSORIES I ESTABLISHED**

**TO PERPETUATE THE ORIGINAL LOCATION OF THIS CORNER:**

At position of ancient rock jack fence corner I chiseled a 4" X on a 8'x6' boulder, from which:

**NEW BEARING OBJECTS:**

A 5/8" x 30" rebar bears S58°E, 19.50 feet, with 1½" aluminum cap marked UNION COUNTY SURVEYOR SE RP.

A 2½" x 30" aluminum pipe with aluminum cap marked as shown below, bears S78°W, 10.50 feet.

A chiseled 3" X BO on 15" high x 6' long rock outcrop bears N78°W, 11.15 feet.

A chiseled 3" X BO on 5' high x 20" wide rock outcrop bears N36°E, 9.10 feet.

I hereby certify that the corner was monumented on June 19, 1997

Witness: Jeff Madsen, Gregory T. Blackman Jr., Jeff Petersen

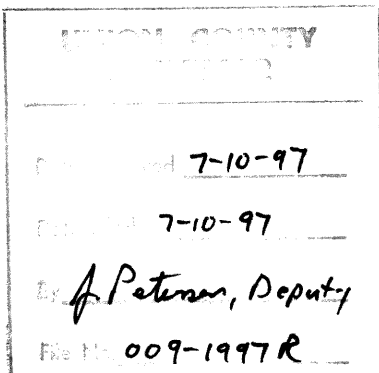
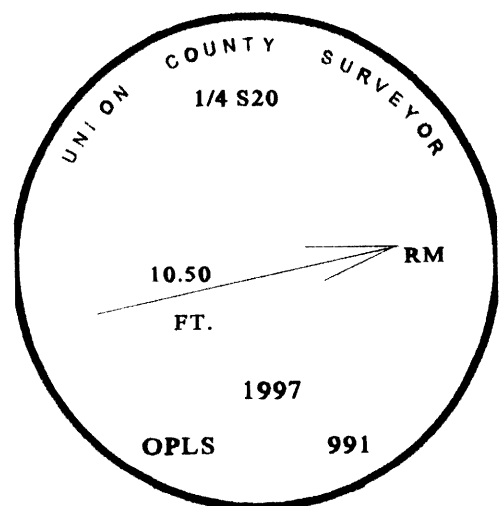
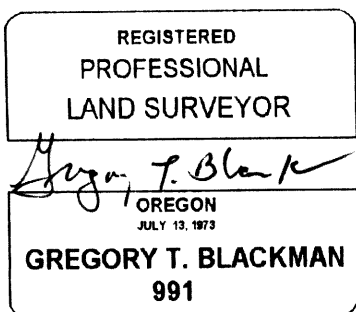

I used a steel tape and magnetic compass in the establishment of the new accessories. I used 18° East declination, the distances are to the X on the bearing objects and to the center of the aluminum cap on the rebar.