

R-1

CERTIFIED RECORD OF LAND CORNER MONUMENTATION

History of original corner establishment:

Corner originally established by John H. Stone under GLO contract number 235 dated July 6, 1875. Surveyor General record states:

Set stone 24x10x7 as per instructions for corner to secs 19, 24, 25 and 30

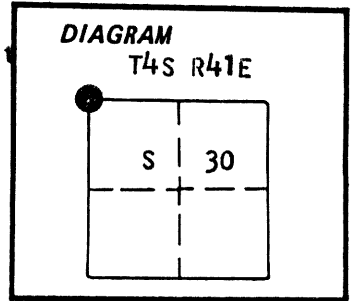

No record of subsequent remonumentation found in the county records.

Description of corner evidence found:

Stone 25"x10"x6" marked with grooves, under fence jack. Corner is harmonious with topo calls to the North and South.

See map of survey number 31-86 filed in the office of the Union County Surveyor

Description of monument and accessories established to perpetuate the

original location of this corner: At stone position, I set a 2 1/2"x30" aluminum pipe with aluminum cap marked as shown, 30 inches in the ground and raised a small mound of stone around cap, from which:

A 3 1/2"x2 1/2"x1' high rock outcrop bears S 7° E, 147.82 feet, marked X B0.

A 4.7'x4.3'x1 foot high shiny black rock outcrop bears S 86° W, 38.44 feet, marked X B0.

Set steel fence post approximately 5 feet south with a 54-9 sign attached.

Corner set: 9/19/86

Witness: Greg Blackman, Rick Robinson

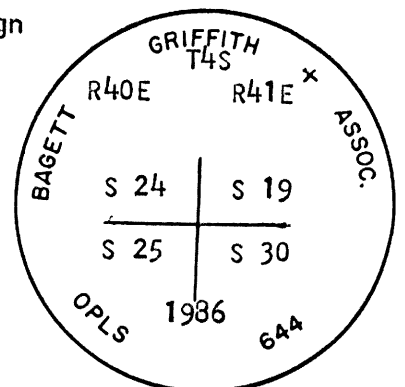

REGISTERED PROFESSIONAL LAND SURVEYOR

Duane I. Griffith
OREGON
JULY 10, 1964
DUANE I. GRIFFITH
644

Brass washer marked OPLS 644 nailed to BT blaze. Used steel tape and magnetic compass with 20° East declination. Distances to the BTs are to a 50d spike set in right side of tree when facing tree, unless otherwise stated.

Office of..... County of.....
State of..... I hereby certify that the within instrument was filed in this office for record on the..... day of....., 19.....

(COUNTY OFFICIAL)

UNION COUNTY SURVEYOR

(DEPUTY)

Form R6-7100-57 (9/71)

Date Received 10-20-86

☆ U.S. GOVERNMENT PRINTING OFFICE - 1983-793-276

Date Filed 10-27-86

By G. LANGLITZ, DEPUTY

File No. 253-86 R

R-1

VI 23

HORIZONTAL CONTROL DATA

UNION COUNTY, OREGON

OREGON STATE PLANE, NORTH ZONE (3601)

STA NAME: 201025

SECTION CORNER COMMON TO SECTIONS 19, 30, 24 AND 25, RANGES 40 AND 41

TWP. 4 S. RGE. 40/41 E.

GEODETIC COORD: NAD 83(91)

DATE TIED: OCTOBER 22, 2010

LAT: 45 ° 11 ' 39.78965 " N

SURVEYOR: RICK G. ROBINSON
OPLS 2219

LONG: 117 ° 44 ' 53.03643 " W

FIRM: BAGETT, GRIFFITH, & BLACKMAN
2006 ADAMS AVENUE
LAGRANDE, OR 97850
(541) 963-6092

SP. COOR: NAD 83(91)

N: 569043.302 INT FT.

E: 8911357.602 INT FT.

TYPE: GPS

THETA: 1 ° 57 ' 5.9 "

ORDER: SECOND CLASS: 1

SCALE FACTOR: 0.999894683

ELEV: 3752.44 US FT.

ELEV: DATUM: NGVD 29

COMMENTS:

Corner is 2 1/2" aluminum pipe with aluminum cap marked as shown

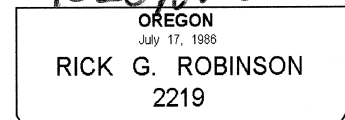
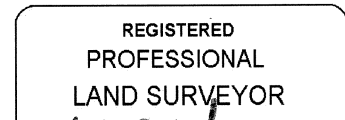
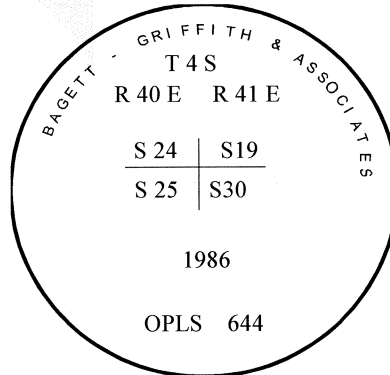

Renewal Date: December 31, 2010

1 METER = 3.280833333... US FEET = 39.37 INCHES

1 METER = 3.280839895 INT'L FEET OR 1 INCH = 2.54 CM

TO CALCULATE ELEVATION FACTOR (IN THE NORTH AMERICAN CONTINENT)

DIVIDE 20,906,000 BY (20,906,000 + ELLIPSOID ELEV. IN FEET)