

Index File No. V-1

History of original corner establishment:

In 1881 under GLO Contract No. 397, J. Cooper set post 5 1/2 ft. long, 4 ins. square, 24 ins. in ground on south hillside for cor. to secs. 25,30,31 and 36 marked: T5S S30 on N.E., R36E S31 on SE, R35E S36 on SW and S25 on NW faces with 1 notch on S and 5 notches on N edges from which:

- A Pine 20" in dia. bears N28°E 192 lks dist marked T5S R36E S30 BT;
- A Pine 26" in dia. bears N21°W 265 lks dist marked T5S R35E S25 BT;

Remonumentation by J. Voelz, LS 381, 1969 per Union Co. Records:

A Pine 33" in dia. bears N28°E 192 lks dist with scribe and in good condition. In Section 25 found a down log with scribe.

At the position of the corner I set a 2" galv. pipe 30" long with a bronze cap on top and 8" plate welded to bottom. The pipe set to a depth of 15" and raised a stone mound.

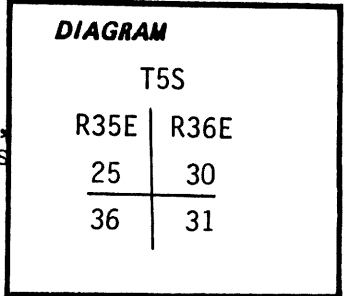

Description of corner evidence found:

(Continued on Page 2 of 2 pages)

Found: A 2 1/2" pipe with brass cap stamped:

Pipe is set 15" in ground with mound of stone to cap.

A Pond. Pine 33° Dia. Dead bearing N28°E 126.7 ft., with visible scribing "R3 E S 0".

A Pond. Pine 30° dia. (alive) bearing S67°E 109.8 ft., with healed over blaze.

A Pond. Pine 26" dia. (alive) bears S36°W 26.5 ft., with healed over blaze.

A Pond. Pine 24" dia. (alive) bears N80°W 324.4 ft., with healed over blaze.

A down snag (P. Pine) rolled out of position, lies in the S25 with visible scribing 35E S25.

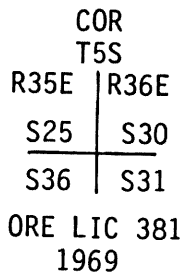

Description of monument and accessories I established to perpetuate the original location of this corner:

We marked new BT's as follows:

A Pond. Pine 28" dia. bears N54°E 179.6 ft., scribed T5S R36E S30 BT.

Attached brass washer stamped LS 1099 to foot blaze of new BT. Attached signs and painted old and new BT's per Standard Specifications for Cadastral Surveys, USFS Region 6, Oct., 1979.

Compass Declination: 19° E

I hereby certify the above described corner monument and/or accessories was established on August 26, 1982.

Witnesses: Rodger Orton
Glen Wagoner
R. Scott

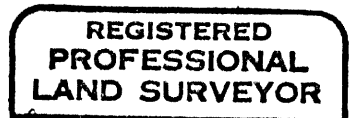

Office of... Surveyor... County of... Union... State of... Oregon... I hereby certify that the within instrument was filed in this office for record on the... 4... day of... OCTOBER... 1982... Howard L. Perry... (COUNTY OFFICIAL)... by Gary L. Langlitz... (DEPUTY)

UNION COUNTY SURVEYOR

Received _____
GPO 799-509

Date Filed _____

By _____

File No. 608-84R

Index File No. V-1

History of original corner establishment:

(Continued from Page 1)

I stamped the disk:

From the corner the original bearing tree is:

A Pine 33" in dia. bears N28°E 192 lks dist.

I set the additional bearing trees:

A Pine 20" in dia. bears S67°E 109.8 ft. dist. marked T5S R36E S31BT;

A Pine 15" in dia. bears S36°W 26.5 ft. dist. marked T5S R35E S36 BT;

A Pine 14" in dia. bears N80°W 324.4 ft. dist marked T5S R35E S25 BT; I set a steel fence post with USFS sign 54-4 attached. USFS bearing tree signs were placed on the bearing trees shoulder high facing the corner. Distance measured to center of trees and marked with a scribe.

COR
T5S
R35E R36E
S25 S30
S36 S31
ORE LIC 381
1969

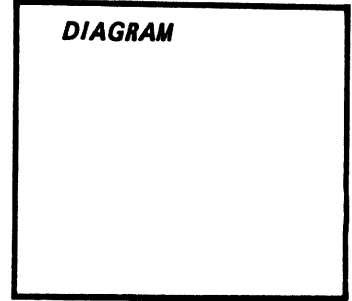

Description of corner evidence found:

Description of monument and accessories I established to perpetuate the original location of this corner:

Office of..... County of.....
State of....., I hereby certify that the within instrument was filed in this office
for record on the..... day of....., 19.....

..... by

(COUNTY OFFICIAL)

(DEPUTY)

UNION COUNTY
SURVEYOR

Received _____

☆ GPO—798-276

Date Filed _____

By _____

File No. 658-84 R

83-69A

CERTIFIED RECORD OF LAND CORNER MONUMENTATION

76
1
V-25

History of original corner establishment:

The original survey made by General Land Office contract survey 1882. The original notes state:

Set a post from which;

A pine 20" in diam bears N28°E 192 lks dist marked T5S R36E S30BT;
A pine 26" in diam bears N21°W 265 lks dist marked T5S R35E S25BT;

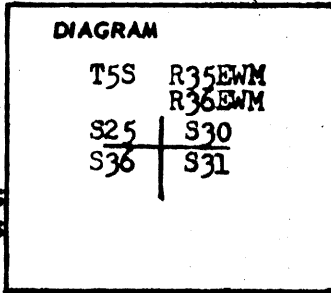

Description of corner evidence found:

A pine 33" in diam bears N28°E 192 lks dist with scribe and in good condition. In section 25 found a down log with scribe.

REGISTERED
OREGON
LAND SURVEYOR

James G. Voelz
MAY 4 1969
JAMES G. VOELZ
381

Description of monument and accessories I established to perpetuate the original location of this corner

At the position of the corner I set a 2" galvanized pipe 30" long with a bronze cap on top and 8" plate welded to bottom. The pipe set to a depth of 15" and raised a stone mound.

I stamped the disk

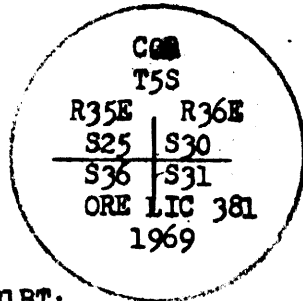

From the corner the original bearing tree is;

A pine 33" in diam bears N28°E 192 lks dist.

I set the additional bearing trees;

A pine 20" in diam bears ~~N28°E~~ 109.8 ft. dist marked T5S R36E S31BT;

A pine 15" in diam bears S36°W 26.5 ft dist marked T5S R35E S36BT;

A pine 14" in diam bears N80°W 324.4 ft. dist marked T5S R35E S25BT; I set a steel fence post with USFS sign 54-4 attached. USFS bearing tree signs were placed on the bearing trees shoulder high facing the corner. Distance measured to center of trees and marked with a scribe.

Office of.....County surveyor..... County of.....UNION.....

State of.....Oregon....., I hereby certify that the within instrument was filed in this office
for record on the 15 day of Sept. 1969, at 2:00 o'clock P.M. (Signed)

County surveyor
(COUNTY OFFICIAL)

by

James G. Voelz
SURVEYOR

UNION COUNTY
SURVEYOR

Date Received _____

Date Filed _____

By _____

File No. 657-84R