

J-15

R623

Form 9600-9
(December 1979)
(formerly 9100-6)

UNITED STATES
DEPARTMENT OF THE INTERIOR
BUREAU OF LAND MANAGEMENT

ORIGINAL

23

FIELD NOTES
OF THE

REMONUMENTATION OF CERTAIN ORIGINAL CORNER POINTS,

TOWNSHIP 5 SOUTH, RANGE 38 EAST,

Multiple horizontal lines for notes.

Of the WILLAMETTE Meridian,
in the State of OREGON

EXECUTED BY

Scott R. McIntyre, Cadastral Surveyor

Under special instructions dated July 13, 19 79, approved July 17, 1979

_____, which provided for the surveys included under U.S. Survey/Group
Number 1000, and assignment instructions dated July 30, 19 82

Survey commenced August 20, 19 82

Survey completed August 31, 19 82

UNION COUNTY
SURVEYOR

Date Received 2-2-84

Date Filed 2-28-84

By G. LANGUTZ, DEPUTY

File No. 814-84 R

Remonumentation of Certain Original Corner Points,
T. 5 S., R. 38 E., Willamette Meridian, Oregon

DRAWING

At the corner point

Set an aluminum post, 28 ins. long, 2 1/2 ins. diam., 23 ins. in the ground, with aluminum cap mkd.

T 5 S R 38 E
1/4 S 15
S 22
1982

from which new bearing trees

A ponderosa pine, 5 ins. diam., bears S. 3° E., 56 1/2 lks. dist., mkd. 1/4 S22 BT.

A fir, 8 ins. diam., bears N. 22° W., 33 lks. dist., mkd. 1/4 S15 BT.

Deposit corner stone and set a steel fence post alongside aluminum post.

The 1/4 sec. cor. of secs. 10 and 15, monumented with the original basalt stone, 12 x 8 x 6 ins., firmly set 4 ins. in the ground, no marks visible, from which the remains of an original bearing tree:

A root hole, bears S. 48° W., 8 lks. dist., with a decayed larch alongside, size indeterminate, with illegible scribe marks visible.

At the corner point

Set an aluminum post, 28 ins. long, 2 1/2 ins. diam., 22 ins. in the ground, with aluminum cap mkd.

T 5 S R 38 E
1/4 S 10
S 15
1982

from which new bearing trees

A fir, 23 ins. diam., bears N. 17° E., 25 lks. dist., mkd. 1/4 S10 BT.

A larch, 8 ins. diam., bears S. 30° E., 14 lks. dist., mkd. 1/4 S15 BT.

Deposit corner stone and set a steel fence post alongside aluminum post.

The cor. of secs. 28, 29, 32, and 33, determined from the remains of the original bearing trees:

A larch, 25 ins. diam., bears S. 50° W., 26 lks. dist., with scribe marks S 32 visible on open blaze. (Record, S. 55° W.)

A sawed pine stump, 45 ins. diam., bears N. 36° W., 67 lks. dist., no marks visible. (Record, N. 40° W.)

At the corner point

Set an aluminum post, 28 ins. long, 2 1/2 ins. diam., 15 ins. in the ground, to solid rock, in a mound of stone, 1/2 st. base, to top, with aluminum cap mkd.

UNION COUNTY
SURVEYOR

Date Received 2-2-84

Date Filed 2-28-84

By G. LANGLITZ, DEPUTY

File No. 814-84 R

PAGE 2/2

CERTIFIED RECORD OF LAND CORNER MONUMENTATION

HISTORY OF ORIGINAL CORNER ESTABLISHED:

Corner originally established by W. B. Barr under GLO contract number 388 dated May 7, 1881. Surveyor General field notes state:

Marked basalt rock 12x8x6 for 1/4 sec. corner, from which:

A Tamarack 12 in. diam bears S48°W 8 lks dist

A Pine 2 in. diam bears N70°W 70 lks dist

Corner perpetuated by Scott R. McIntyre under special instructions Group number 1000 for the remonumentation of certain original corners in Township 5 South, Range 38 East dated July 13, 1979. Record states: The 1/4 sec. cor. of secs. 10 and 15, monumented with the original basalt stone, 12x8x6 ins., firmly set 4 ins. in the ground, no marks visible, from which the remains of an original bearing tree:

A root hole, bears S. 48° W., 8 lks. dist. with a decayed larch alongside, size indeterminate, with illegible scribe marks visible.

At the corner point set an aluminum post, 28 ins. long, 2 1/2 ins. diam., 22 ins. in the ground, with aluminum cap mkd.

from which new bearing trees:

A fir, 23 ins. diam., bears N. 17° E., 25 lks. dist., mkd. 1/4 S10 BT.

A larch, 8 ins. diam., bears S. 30° E., 14 lks. dist., mkd. 1/4 S15 BT.

Deposit corner stone and set a steel fence post alongside aluminum post.

T 5 S R 38 E J-15

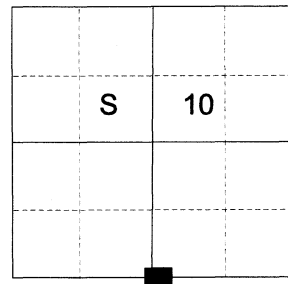

DESCRIPTION OF CORNER EVIDENCE FOUND:

Found a 2 1/2" aluminum pipe with 3" aluminum "Department of the Interior, Bureau of Land Management" cap marked as shown below, 6" above ground, from which:

A 24" x 6' uprooted Fir stump bears North a dist. of 14 ft., dead, down and moved for fence construction, with scribes visible on partially healed blaze.

A 12" Western Larch bears South 30° East, a dist. of 9.24 ft., alive and vigorous with healed blaze.

SEE SURVEY 035-2020

DESCRIPTION OF MONUMENT AND ACCESSORIES I ESTABLISHED TO PERPETUATE THE ORIGINAL LOCATION OF THIS CORNER:

From the aluminum pipe monument:

NEW BEARING OBJECTS:

A 12" Douglas Fir bears North 10° East a dist. of 20.60 ft., marked 1/4 S10 BT.

A 6" Douglas Fir bears South 54° West a dist. of 16.20 ft., marked 1/4 S15 BT.

A 4" Western Larch bears North 47° West a dist. of 36.20 ft., marked 1/4 S10 BT.

A steel fence post is approx. 0.5 North of the aluminum cap.

I hereby certify that the corner was perpetuated on August 28, 2020.

Witness: Kyle A. Tucker

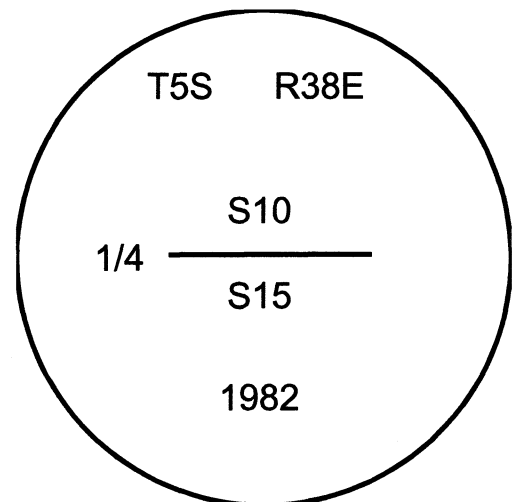

Renewal Date: June 30, 2021

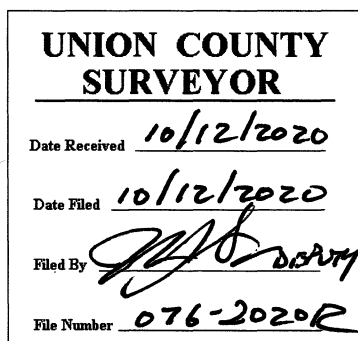

I used a steel tape and magnetic compass in the establishment of the new accessories. I used 14° East declination, the distances are to a 60d spike driven into the right side of the root crown of the bearing trees. A brass washer marked OPLS 83571 is attached to the BT blaze of the new bearing trees.