

CERTIFIED RECORD OF LAND CORNER MONUMENTATION
UNION COUNTY, OREGON

HISTORY OF ORIGINAL CORNER ESTABLISHED

Corner originally established by David Thompson under GLO Contract No. 103, dated September 1863. Surveyor General record states:

Set post for 1/4 Sec corner in mound of Earth with charred stake.

DESCRIPTION OF CORNER EVIDENCE FOUND:

None
See Union County Survey Number 012-2015

DESCRIPTION OF MONUMENT AND ACCESSORIES I ESTABLISHED TO PERPETUATE THE ORIGINAL LOCATION OF THIS CORNER:

At the position determined by survey, I set 20" copper clad monument with a 2 1/2" brass cap marked as shown below 26" in the ground. From which:

NEW BEARING OBJECTS:

A 5/8" x 30" iron rod with a 1 1/2" aluminum cap bears North 32°44' East, a distance of 44.36 feet, marked UNION COUNTY SURVEYOR NE RP.
A 5/8" x 30" iron rod with a 1 1/2" aluminum cap bears South 30°23' East, a distance of 52.12 feet, marked UNION COUNTY SURVEYOR SE RP.
A 5/8" x 30" iron rod with a 1 1/2" aluminum cap bears South 21°05' West, a distance of 48.86 feet, marked UNION COUNTY SURVEYOR SW RP.
A 5/8" x 30" iron rod with a 1 1/2" aluminum cap bears North 1°05' West, a distance of 38.86 feet, marked UNION COUNTY SURVEYOR NW RP.

I hereby certify that this corner was monumented on February 17, 2015.

Witness: Thomas J. Kopp

T 6 S R 39 E N-07

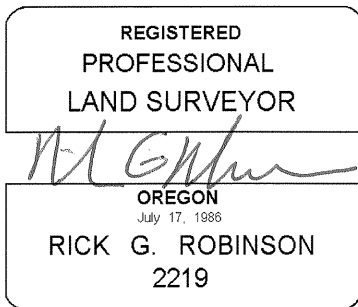
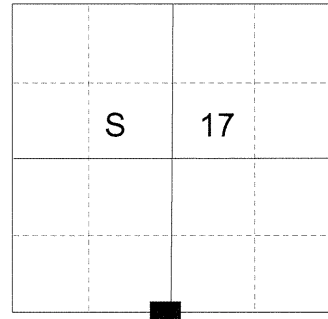

Renewal Date: December 31, 2016

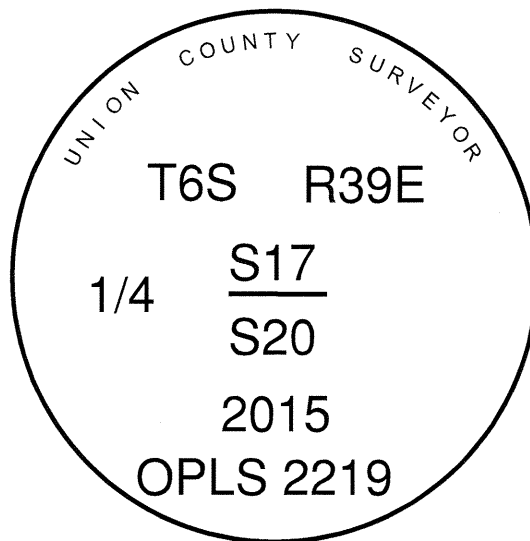

UNION COUNTY SURVEYOR

Date Received 2/25/15

Date Filed 2/25/15

Filed By [Signature]

File Number 069-2015R

Bearing and distance to the accessories were determined by GPS observation with a Leica GS-14 unit. The Basis of Bearing is that of Union County Survey Number 012-2015.

HORIZONTAL CONTROL DATA
UNION COUNTY, OREGON
OREGON STATE PLANE, NORTH ZONE (3601)

STA NAME: 201510

1/4 SECTION CORNER COMMON TO SECTIONS 17 AND 20

TWP. 6 S. RGE. 39 E.

GEODETIC COORD: NAD 83(91)

DATE TIED: February 18, 2015

LAT: 45 ° 2 ' 8.29215 " N

SURVEYOR: RICK G. ROBINSON
OPLS 2219

LONG: 117 ° 57 ' 46.40853 " W

FIRM: BAGETT, GRIFFITH, & BLACKMAN
2006 ADAMS AVENUE
LAGRANDE, OR 97850
(541) 963-6092

SP. COOR: NAD 83(91)

N: 509383.490 INT FT.

E: 8857826.638 INT FT.

TYPE: GPS

THETA: 1 ° 47 ' 57.415354 "

ORDER: SECOND CLASS: 1

SCALE FACTOR: 0.999897269

ELEV: 3402.79 US FT.

ELEV: DATUM: NGVD 29

COMMENTS:

2 1/2" Aluminum monument in centerline
of Coughanhour Lane

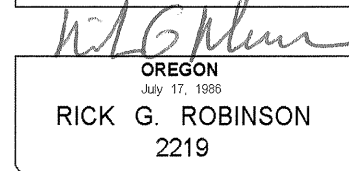
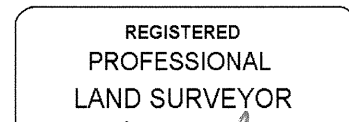
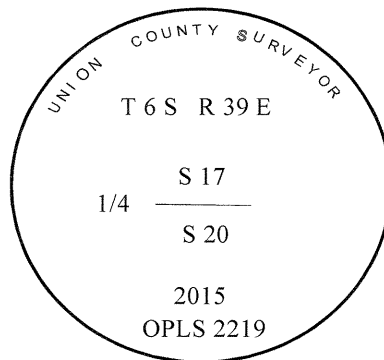

Renewal Date: December 31, 2016

1 METER = 3.280833333... US FEET = 39.37 INCHES

1 METER = 3.280839895 INT'L FEET OR 1 INCH = 2.54 CM

TO CALCULATE ELEVATION FACTOR (IN THE NORTH AMERICAN CONTINENT)

DIVIDE 20,906,000 BY (20,906,000 + ELLIPSOID ELEV. IN FEET)