

UNION COUNTY SURVEYOR

CERTIFIED RECORD OF LAND CORNER MONUMENTATION

HISTORY OF ORIGINAL CORNER ESTABLISHMENT:

Corner originally established by David P. Thompson, contract No. 103, dated September 3, 1863. Surveyor General record states:

Set post for 1/4 sec corner in mound of earth with charred stakes, pits, trenches, as per instructions.

Survey No. 064-1991 sets a 5/8" x 30" iron pin with plastic cap marked HANLEY ENGRS PLS 1206

Survey No. 066-1991 found 5/8" iron pin with plastic cap marked HANLEY ENGRS PLS 1206

Survey No. 023-1995 found 5/8" iron pin with plastic cap marked HANLEY ENGRS PLS 1206

T 6 S R 39 E P-17

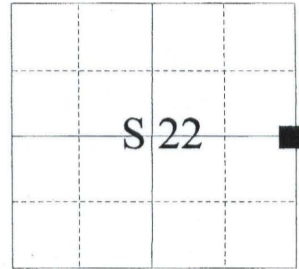

No record of subsequent monumentation found in Union County survey records. DESCRIPTION OF CORNER EVIDENCE FOUND:

Corner obliterated by river

See Survey No. 012-2001

DESCRIPTION OF MONUMENT AND ACCESSORIES I ESTABLISHED TO PERPETUATE THE ORIGINAL LOCATION OF THIS CORNER:

At a point bearing N 1°20'33" W, along the East line of Section 22, a distance of 30.00 ft. from the position established by Survey Nos. 012-2001 and 023-1995, I set a 2 1/2" x 30" aluminum monument, marked as shown below, 30" in the ground from which:

A 5/8" x 30" iron pin with 1 1/2" aluminum cap in a East-West fenceline bears N73°E, a distance of 33.34 feet, marked UNION COUNTY SURVEYOR NE RP.

A 5/8" x 30" iron pin with 1 1/2" aluminum cap bears S20°E, a distance of 7.09 feet, marked UNION COUNTY SURVEYOR SE RP.

A 5/8" x 30" iron pin with 1 1/2" aluminum cap bears S60°W, a distance of 7.11 feet, marked UNION COUNTY SURVEYOR SW RP.

A 5/8" x 30" iron pin with 1 1/2" aluminum cap bears N21°W, a distance of 7.75 feet, marked UNION COUNTY SURVEYOR NW RP.

I hereby certify that the corner was monumented on March 27, 2001. Witness: Norbert Volny and Gregory T. Blackman, Jr.

REGISTERED PROFESSIONAL LAND SURVEYOR
Gregory T. Blackman
OREGON
JULY 13, 1973
GREGORY T. BLACKMAN
991

Renewal Date: Dec. 31, 2001

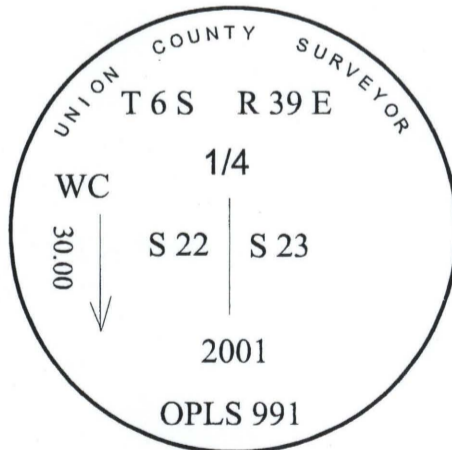

UNION COUNTY SURVEYOR
Date Received 3/30/01
Date Filed 3/14/01
Filed By R. ROBINSON, DEPUTY
File Number 027-2001 R

I used a Leica 530 GPS unit in the establishment of the new accessories. The Basis of Bearings is the same as that shown on Survey No. 012-2001. The distances are to the center of a 5/8"x30" rebar with 1 1/2" aluminum cap marked Union County Survey Marker.

**HORIZONTAL CONTROL DATA
UNION COUNTY, OREGON
OREGON STATE PLANE, NORTH ZONE (3601)**

STA NAME: 200143

QUARTER COMMON TO: 22 & 23

TWP. 6 S. RGE. 39 E.

GEODETIC COORD: NAD 83(91)

DATE TIED: 28 MARCH 2001

LAT: 45 ° 1 ' 41.60459 " N

SURVEYOR: GREGORY T. BLACKMAN
OPLS 991

LONG: 117 ° 54 ' 42.77496 " W

FIRM: BAGETT, GRIFFITH, & BLACKMAN
2006 ADAMS AVENUE
LAGRANDE, OR 97850
(541) 963-6092

SP. COOR: NAD 83(91)

N: 507100.410 INT FT.

E: 8871092.320 INT FT.

TYPE: GPS

THETA: 1 ° 50 ' 7.64829586 "

ORDER: SECOND CLASS: 1

SCALE FACTOR: 0.999897573

ELEV: US FT.

ELEV: DATUM: NGVD 29

COMMENTS:

No monument set, position falls in river.

REGISTERED
PROFESSIONAL
LAND SURVEYOR

Gregory T. Blackman
OREGON
JULY 13, 1973
GREGORY T. BLACKMAN
991

Renewal Date: Dec. 31, 2001

1 METER = 3.2808333333... US FEET = 39.37 INCHES

1 METER = 3.280839895 INT'L FEET OR 1 INCH = 2.54 CM

TO CALCULATE ELEVATION FACTOR (IN THE NORTH AMERICAN CONTINENT)

DIVIDE 20,906,000 BY (20,906,000 + ELLIPSOID ELEV. IN FEET)

HORIZONTAL CONTROL DATA

UNION COUNTY, OREGON

OREGON STATE PLANE, NORTH ZONE (3601)

STA NAME: 200143WC

WITNESS CORNER TO: 1/4 COMMON TO SEC 22 & 23

TWP. 6 S. RGE. 39 E.

GEODETIC COORD: NAD 83(91)

DATE TIED: 28 MARCH 2001

LAT: 45 ° 1 ' 41.90085 " N

SURVEYOR: GREGORY T. BLACKMAN
OPLS 991

LONG: 117 ° 54 ' 42.77132 " W

FIRM: BAGETT, GRIFFITH, & BLACKMAN
2006 ADAMS AVENUE
LAGRANDE, OR 97850
(541) 963-6092

SP. COOR: NAD 83(91)

N: 507130.406 INT FT.

E: 8871091.620 INT FT.

TYPE: GPS

THETA: 1 ° 50 ' 7.64829586 "

ORDER: SECOND CLASS: 1

SCALE FACTOR: 0.999897573

ELEV: 3233.90 US FT.

ELEV: DATUM: NGVD 29

COMMENTS:

Point has light obstructions, see obstruction sheet.

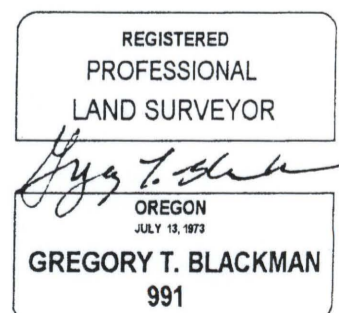
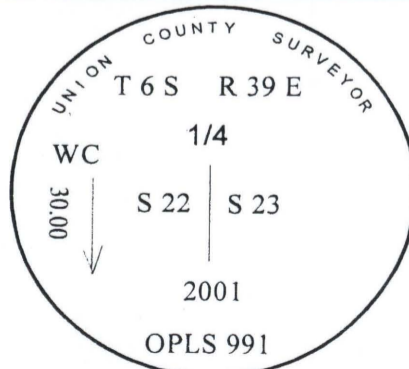

Renewal Date: Dec. 31, 2001

METER = 3.2808333333... US FEET = 39.37 INCHES
 1 METER = 3.280839895 INT'L FEET OR 1 INCH = 2.54 CM
 TO CALCULATE ELEVATION FACTOR (IN THE NORTH AMERICAN CONTINENT)
 DIVIDE 20,906,000 BY (20,906,000 + ELLIPSOID ELEV. IN FEET)