

RECOVERY NOTES

J-5 PROPERTY CORNER INVESTIGATION

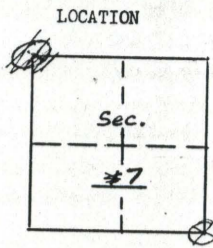

T. 65 R. 42E
 Mer. Wm State Oregon
 Forest W-W Dist. Union

LEGEND

- Corner searched-no evidence
- Corner or accessory found
- Corner marked by perm. mon.

DESCRIPTION OF FOUND CORNER

MATERIAL: Volcanic Rock SIZE: 14 x 12 x 8
 HEIGHT ABOVE GROUND: 10" CONDITION: Good
 MARKINGS: _____

DESCRIPTION OF FOUND ACCESSORIES

28" PP N 52° W 48 lvs "T65 R42E 5 7"
PP Rotten + down S 55° W 83 lvs "5 18"
PP Stump S 73° E 120 lvs "BT"

NOTE: Indicate full investigative details on back of form.

PHOTO IDENTIFICATION

Symbol & date ENW 7/64 Line or Roll 8 Exposure 223
 How Identified Pin Point Where filed Union R.D.

RECOVERED BY: Gildemeister
 DATE: 9/19/66 TITLE: Forester

Form R6-5680-180 (4/61)

HOW TO REACH CORNER

2 door
5 notes
to B.T.

on bench
N5 on east

7100-52 (3/68)

USDA-FOREST SERVICE GPO 940-117
 Index File No. J 5
 T. 65 R. 42E
 Merid. Wm N.F. Wm

CORNER RECORD (SEARCH)

(Ref. FSM 7151.4)

R.D. Union County Union State OR
 Tract or Survey No. _____

Cor. No. 7

Sec. 7

UNION COUNTY SURVEYOR

Date Received _____

Date Filed 12-23-87

By G. LANGLITZ, Deputy

File No. 398-87R

J-5

CERTIFIED RECORD OF LAND CORNER MONUMENTATION

J-5

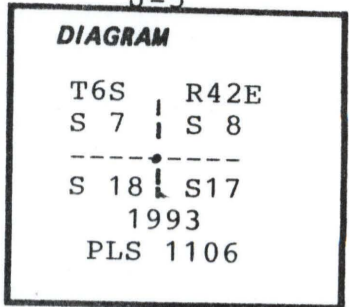

History of original corner establishment:
 Corner was originally established by W.B. BARR, U.S. Deputy Surveyor, under Contract No. 443, dated May 29, 1882. Surveyor General records state:
 Set a volcanic rock 14"X 12"X 8", 10 inches in the ground. Stone was marked with 5 notches on the north and 4 notches on the south, from which:
 A 18" pine bears N62°E-81 lks dist., scribed T6SR42E S8BT., A 14" pine bears S73°E-120 lks dist., scribed T6SR42ES17BT., A 18" pine bears S55°W-83 lks dist., scribed T6SR42ES18BT., A 26" pine bears N45°W-48 lks dist., scribed T6SR42ES7BT.

See Survey 052-1994
Description of corner evidence found:

Found a stone 13"X 10"X 7", 1/2" in the ground with 5 notches on the North and 4 notches on the south.
 A live 33" ponderosa pine bears N45°W-31.7 feet, scribed: T6SR42ES7, with open blaze and a bearing tree tag.
 A 12" stump bears S73°E-79.2 feet, scribed: T6SR42ES17 with bearing tree tag.
 A log with a bearing tree tag and a rotten stump hole bears S55°W-54.8 feet.

Description of monument and accessories | established to perpetuate the original location of this corner:

At the postion of the found stone:

Set a 2 1/2" X 30" aluminum pipe with a 2 1/2" aluminum cap, 24" in ground and surrounded with a mound of earth and stone. Deposited stone in hole along side of monument.

Attached sign 54-9 to steel fence post, set 3.0 feet North of monument.

New bearing trees established:

- A 14" ponderosa pine bears S 31 1/2° W - 4.1 feet, scribed: T6SR42ES18BT.
- A 23" ponderosa pine bears N 2 1/2° E - 32.6 feet, scribed: T6SR42ES8BT.
- A 23" douglas fir bears S 35 1/2° E - 23.7 feet, scribed: T6SR42ES17BT.

New bearing trees have a brass washer stamped "PLS 1106" nailed to face of blaze. Attached sign 54-3 & 54-9, painted face of blaze & a 6" red band around each bearing tree.

I hereby certify that the above corner monument was properly monumented to U.S.F.S standards by me on December 1, 1993.

Compass declination 18° East.

REGISTERED
 PROFESSIONAL
 LAND SURVEYOR

William R. Wells

OREGON
 JULY 22, 1977
 WILLIAM R. WELLS
 1106

renews 12-31-94

Office of..... County of.....
 State of..... I hereby certify that the within instrument was filed in this office
 for record on the..... day of.....

.....
 (COUNTY OFFICIAL)

| | |
|---------------------|-----------------------|
| 19 | |
| UNION COUNTY | |
| by | SURVEYOR |
| | (DEPUTY) |
| Date Received | <i>11/3/94</i> |
| Date Filed | <i>11/14/94</i> |
| By | <i>Guyon T. Blake</i> |
| File No | <i>146-1994K</i> |