

RECOVERY NOTES

PROPERTY CORNER INVESTIGATION

LOCATION

T. 65 R. 42E
Mer. Wm State Oregon
Forest W-W Dist. Union

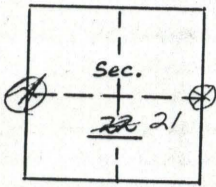

LEGEND

- Corner searched-no evidence
- ⊗ Corner or accessory found
- Corner marked by perm. mon.

P-13

DESCRIPTION OF FOUND CORNER

MATERIAL: Stake - No Evidence SIZE: _____
HEIGHT ABOVE GROUND: _____ CONDITION: _____
MARKINGS: _____

DESCRIPTION OF FOUND ACCESSORIES

30" PP with upper & lower blades
Needs cutting out for Actual Proof
down snag - scribed area face down
matches notes.

NOTE: Indicate full investigative details on back of form.

PHOTO IDENTIFICATION

Symbol & date ENW 7/64 Line or Roll 10 Exposure 60
How Identified _____ Where filed Union RD

DATE: 8/18/66 RECOVERED BY: Goldman
TITLE: Forester

Form R6-5680-180 (4/61)

USDA-FOREST SERVICE GPO 940-117
Index File No. P-13
T. 65 R. 42E R.D. _____

CORNER RECORD (SEARCH)
(Ref. FSM 7151.4)
County _____

Tract or Survey No. _____
Cor. No. _____

HOW TO REACH CORNER

FS-7100-52 (3/68)

UNION COUNTY SURVEYOR

Received _____

to Filed 12-23-87

By G. LANGLITZ, DEPUTY

File No. 511-87R

P-13

CERTIFIED RECORD OF LAND CORNER MONUMENTATION

P-13

History of original corner establishment:

40.00 Set stake 4 ft. long 4 ins. in diam. 24 ins in the ground, for $\frac{1}{4}$ corner Sec. corner marked $\frac{1}{4}$ on the West face, from which:

- A pine, 20 ins. diam., bears S.49°W., 26 lks. dist. mkd. $\frac{1}{4}$ S BT.
- A pine, 8 ins. diam., bears N.55°E., 87 lks. dist. mkd. $\frac{1}{4}$ S BT.

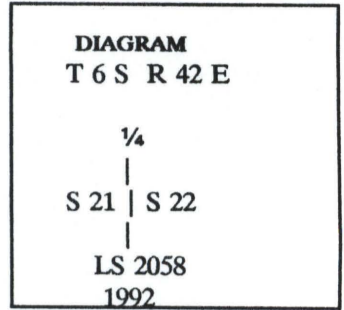

Description of corner evidence found:

Description of monument and accessories I established to perpetuate the original location of this corner:

No evidence of original monument or accessories found. Set a 3" diam. U.S.F.S aluminum capped pipe, 30" long, with magnet, 22" in ground at proportional position with mound of stone to cap, from which:

- A pine, 12" diam., bears N.35°25'W., 33.56', scribed " $\frac{1}{4}$ S21 BT".
- A pine, 8" diam., bears N.71°00'E., 30.37', scribed " $\frac{1}{4}$ S22BT".
- A pine, 14" diam., bears S.39°15'E., 58.51', scribed " $\frac{1}{4}$ S22 BT".
- A pine, 12" diam., bears S.37°00'W., 50.80', scribed " $\frac{1}{4}$ S21 BT".

**UNION COUNTY
SURVEYOR**

Date Received 8/10/94

Date Filed 10/23/94

By [Signature]

File No. 040-1994R

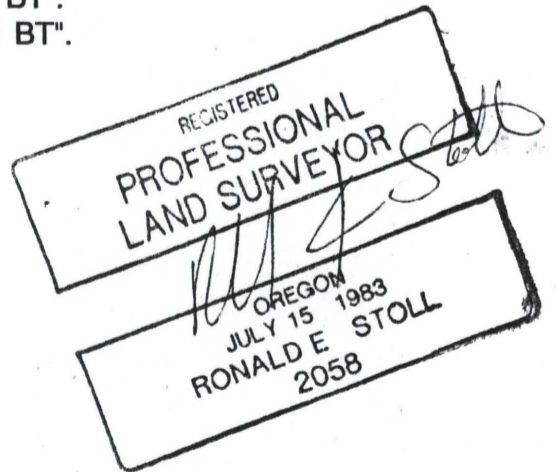

Office of _____ County of _____
 State of _____ I hereby certify that the within instrument was filed in this office
 for record on the ____ day of _____, 19____
 _____ by _____
 (COUNTY OFFICIAL) (DEPUTY)

AA

P-13