

V-11 LAND CORNER RECORD

1. T 6 S R 12 E No. V-11 Cor. 1/4 Mer. Wm State Oregon (Rectangular) N. F. Wallman - Whitman Dist. Union

2. Corner Status

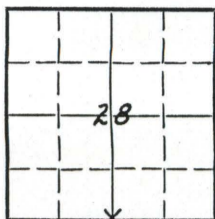

3. Original Description Vol. Page Where Recorded

4. Description of Corners:
Basalt Rock 12 x 8 x 7 8 inches in ground
1/4 on North Face

5. Investigation Notes:

28" DF N 31° E 27 IKs

Pine BT and corner rock evidently destroyed in construction of irrigation ditch.

DF BT located on South bank of ditch.

7. Photo Identification

Photo No. _____

Ident. By: _____

8. Plane Coordinate Position Data

State _____ Zone _____

X _____

Y _____

Estab. By _____

Field Book No. _____

Where Filed _____

9. Evaluation

Authentic _____

Needs Verif. _____ Monument _____

Re-estab. _____ Survey _____

Land Status _____

6. Signed N. F. Wallman Title TMA

Date 10/12/62

**UNION COUNTY
SURVEYOR**

Date Received _____

Date Filed 12-23-87

By G. LANGLITZ, Deputy

File No. 421-87R

V-11

RECORD OF LAND CORNER MONUMENTATION

NORTH 1/4 CORNER SECTION 33, T. 6 S., R. 42 E., W.M.

ORIGINALLY ESTABLISHED BY: William B. Barr, U.S. Deputy Surveyor

CONTRACT NUMBER: 443

CONTRACT DATE: May 29, 1882

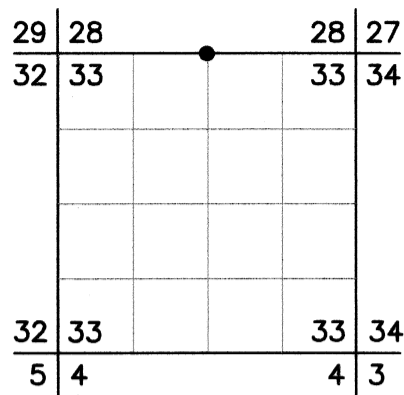

ORIGINAL DESCRIPTION: Set basalt rock 12x8x7 ins., 8 inches in ground for 1/4 Sec. corner, marked 1/4 on the North face, from which
 a pine 5 in diam bears S14°W 22 lks dist marked 1/4 S B.T.
 a fir 12 in diam bears N81°E 27 lks dist marked 1/4 S B.T.

EVIDENCE FOUND: I found the remains of the original northeast bearing tree, which is a sawn Douglas-fir stump, approximately 40 inches in diameter and 1.5 feet tall. At a point 6 inches out from the pith, I removed the outer wood to reveal the pitched-over lower blaze and scribing "BT" visible. There is no trace of the corner stone or the southwest bearing tree, as both fall within the prism of an irrigation ditch and have been destroyed. I reestablish the 1/4 corner at G.L.O. record bearing and distance from the found remains of the bearing tree.

DESCRIPTION OF MONUMENTS AND ACCESSORIES SET AND METHODS USED:

The corner point falls in the irrigation ditch, where it is impracticable to set a monument. Therefore, I establish a witness corner East, 25.00 feet from the true corner position, where I set a standard USFS 2½"x30" aluminum pipe with attached 3¼" aluminum cap, 29" in the ground. Raised a 2 ft. diameter mound of stone around the monument to top of cap. Cap is marked as shown below.

From which, **I SCRIBE NEW BEARING TREES:**

- ▶ A Douglas-fir 17" dbh bears S.84°E., 18.26 ft. marked X in upper blaze and BT in lower blaze
- ▶ A ponderosa pine 10" dbh bears S.27°W., 36.63 ft. marked X in upper blaze and BT in lower blaze
- ▶ A Douglas-fir 17" dbh bears N.88°40'W., 45.0 ft. marked X in upper blaze and BT in lower blaze

Also from which, **I SET A NEW REFERENCE POINT:**

- ▶ A 5/8"x 24" iron pin bears N.60°55'E., 39.51 ft., with attached 2" aluminum cap marked RP 1 2022 PLS 69454

CORNER MONUMENT MARKED:

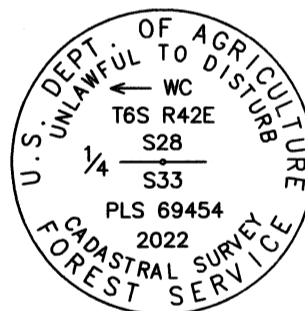

Painted a 6 inch red band around each bearing tree, and also painted blazes red and attached USFS 54-3 and 54-9 signs. Used RTK GPS to measure bearings to accessories. Bearings are geodetic, derived by GPS observation at the corner. Distance to each bearing tree was measured with a steel tape to a 60d nail driven in the side-center at the root crown of the tree, with an attached 1½" aluminum washer stamped PLS 69454. Also set an aluminum guard post southwesterly, with USFS 54-9 sign attached.

RESTORATION BY, STAMP AND DATE:

Work Performed August 1, 2022 by:

Jason L. Hatfield, PLS
 Daniel B. Lee

USDA FOREST SERVICE
 NORTHEAST OREGON LAND ZONE
 1550 Dewey Avenue, Suite A
 Baker City, OR 97814
 (541) 523-1283

UNION COUNTY SURVEYOR	
Date Received	12/14/22
Date Filed	12/14/22
By	<i>[Signature]</i>
File No.	039-2022R

REGISTERED PROFESSIONAL LAND SURVEYOR
<i>[Signature]</i>
OREGON NOVEMBER 30, 2007 JASON L. HATFIELD #69454
EXPIRES: 6/30/2023