

The  
 McWHIRTER ADDITION,  
 to  
 La Grande,  
 Union County, Oregon.

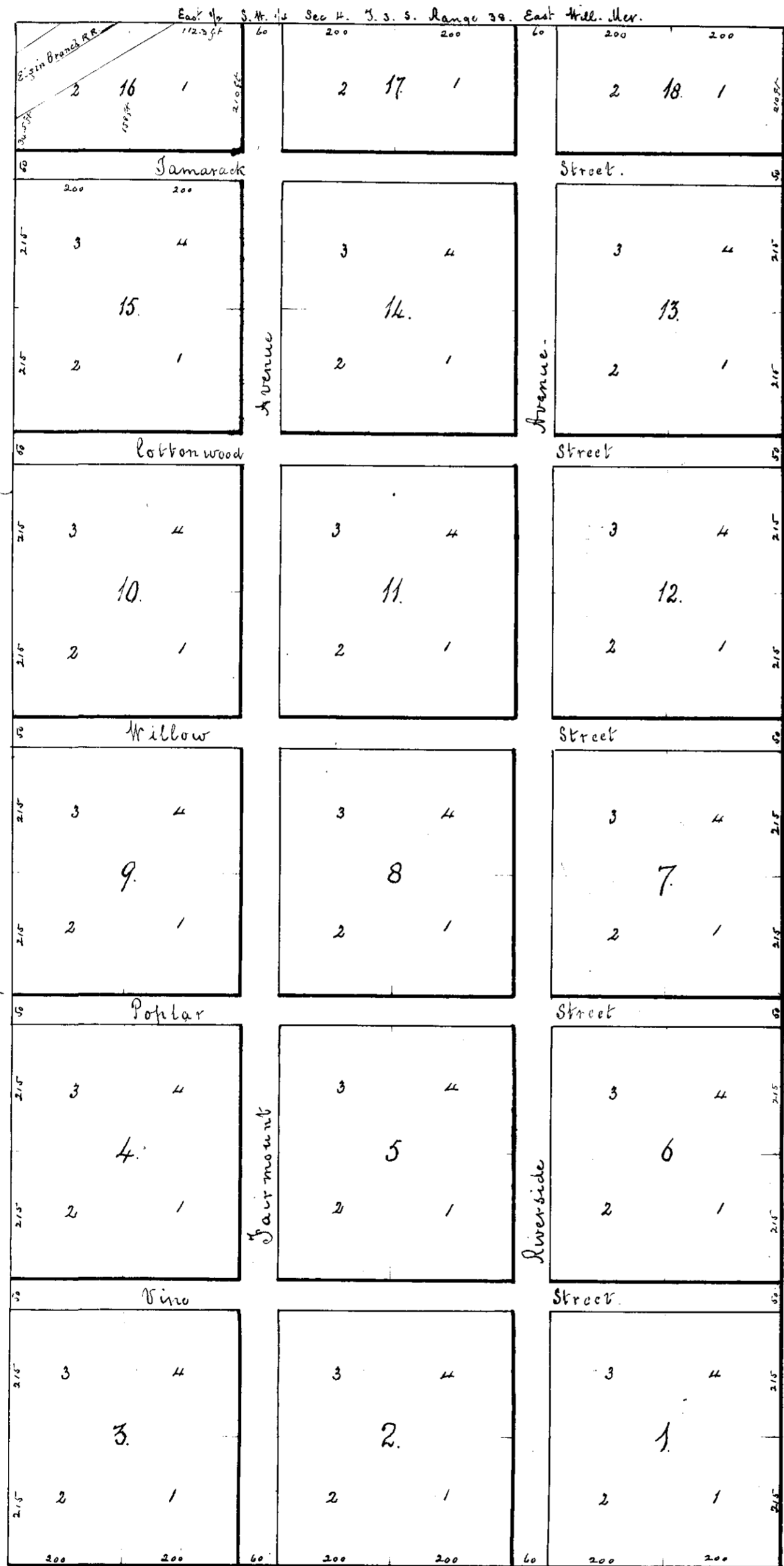

We J. A. McWhirter & Kate E. McWhirter his wife the owners of the land embraced within this Plat the same being the East half of the South West qr. of Section 4 in Township Three (3) South of Range thirty eight (38) East Willamette Meridian in Union County Oregon do hereby acknowledge as our voluntary act and deed the said plat with its described lots blocks and street survey and measurement as therein indicated and as McWhirter Addition to La Grande, Oregon and we dedicate as public easement the said streets so therein named. Done this November 14th 1890  
 In presence of  
 J. A. McWhirter  
 Kate E. McWhirter  
 J. C. Williams - C. H. Finn

Personally appeared before me the undersigned a Notary Public for the State of Oregon the within named J. A. McWhirter and Kate E. McWhirter his wife who acknowledged the foregoing instrument as their voluntary act and deed, the wife examined separate and apart from her husband. Dated this November 14th 1890.  
 C. H. Finn  
 Notary Public for Oregon

All streets running North and South are 60 feet wide, and all streets running East and West are 50 feet wide. All blocks are 400 x 450 feet except the fractional tier on the North.  
 J. L. Curtis, Surveyor.

Recorded November 17th 1890 @ 1 o'Clock P.M.  
 John S. Elliott, Recorder  
 By C. F. Bill, Deputy