

Timber Crest Estates

A Subdivision situated in the North Half of Section 14,
Township 3 South, Range 40 East of the Willamette Meridian
Union County, Oregon.

BASIS OF BEARING

Solar observation taken at the Southwest corner of Section 15, Township 3 South, Range 40 East of the Willamette Meridian.

Microfilm Number 20064205T
Plat Cabinet Number C 825-826

SCALE: 1"=200'

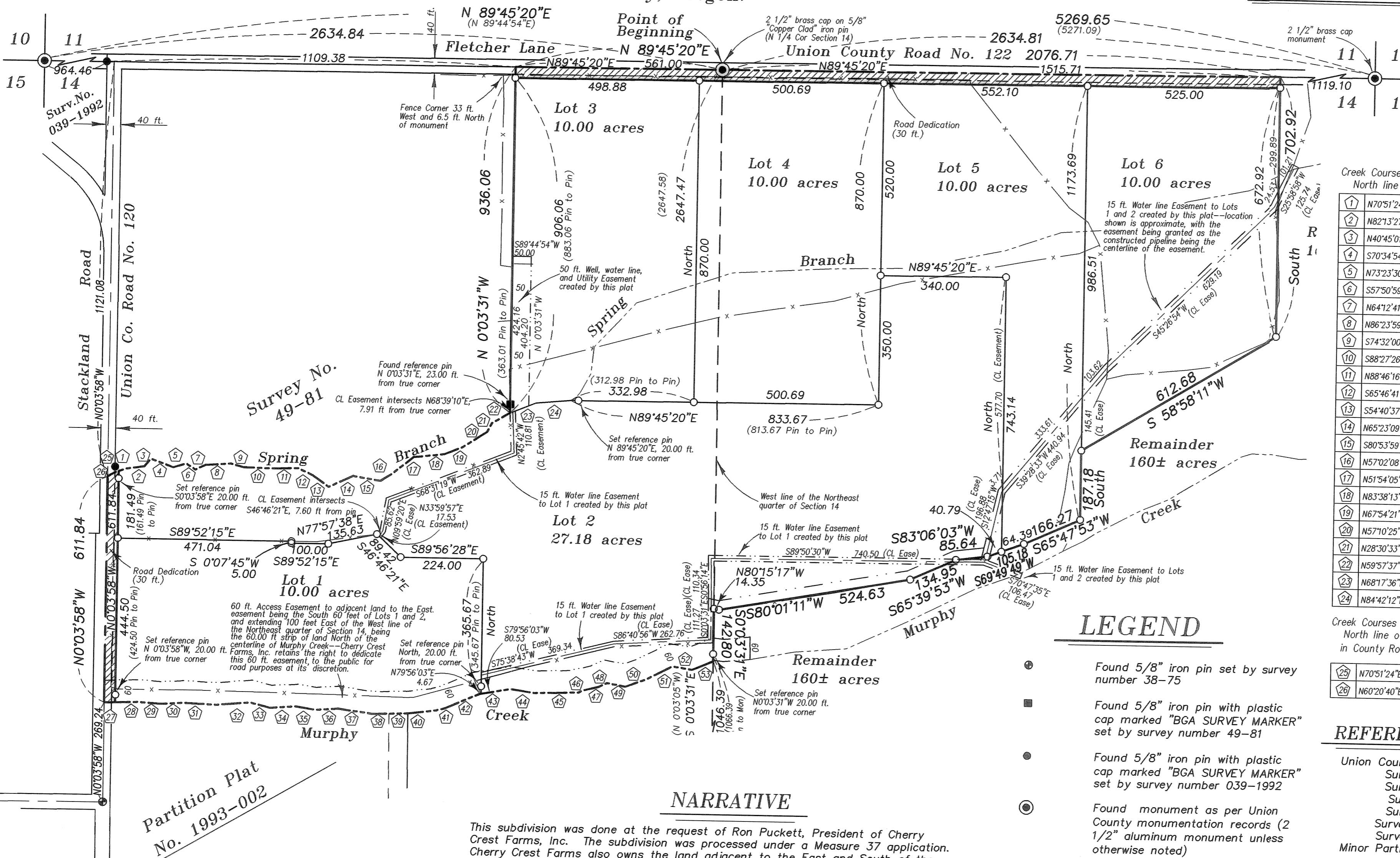

Creek Courses along the North line of Lot 2

1	N70°51'24"E	20.21
2	N82°13'27"E	50.21
3	N40°45'01"E	27.21
4	S70°34'54"E	64.73
5	N73°23'30"E	36.54
6	S57°50'59"E	29.49
7	N64°12'41"E	30.11
8	N86°23'59"E	69.81
9	S74°32'00"E	34.56
10	S88°27'26"E	74.12
11	N88°46'16"E	74.55
12	S65°46'41"E	43.47
13	S54°40'37"E	53.28
14	N65°23'09"E	72.77
15	S80°53'59"E	76.33
16	N57°02'08"E	36.77
17	N51°54'05"E	74.69
18	N83°38'13"E	83.35
19	N67°54'21"E	52.42
20	N57°10'25"E	78.10
21	N28°30'33"E	28.55
22	N59°57'37"E	55.20
23	N88°17'36"E	75.66
24	N84°42'12"E	95.08

Creek Courses along the South line of Lots 1 & 2

25	S88°39'57"W	64.87
26	N86°05'58"W	60.21
27	S86°11'23"W	57.20
28	N87°28'55"W	90.56
29	S85°10'25"W	92.85
30	N76°26'53"W	56.47
31	S86°23'15"W	70.54
32	N81°17'39"W	52.32
33	S86°27'13"W	62.84
34	N82°24'46"W	94.37
35	S88°14'28"W	45.08
36	S88°14'28"W	50.91
37	S83°04'18"W	75.70
38	S75°14'34"W	27.95
39	S66°34'06"W	99.53
40	S79°56'03"W	85.20
41	N81°40'48"W	65.48
42	S88°22'36"W	121.63
43	S54°27'03"W	9.55
44	S76°19'40"W	46.41
45	S64°46'21"W	25.15
46	N79°42'18"W	51.13
47	S69°26'11"W	58.87
48	S62°55'01"W	80.07
49	N81°13'32"W	53.68
50	S67°15'33"W	61.41

Creek Courses along the North line of Lot 2 in County Road R/W

25	N70°51'24"E	10.58
26	N60°20'40"E	23.00

Creek Course along the South line of Lot 1 in County Road R/W

27	S88°39'56"W	30.01
----	-------------	-------

LEGEND

- Found 5/8" iron pin set by survey number 38-75
- Found 5/8" iron pin with plastic cap marked "BGA SURVEY MARKER" set by survey number 49-81
- Found 5/8" iron pin with plastic cap marked "BGA SURVEY MARKER" set by survey number 039-1992
- Found monument as per Union County monumentation records (2 1/2" aluminum monument unless otherwise noted)
- () Record information of survey number 40-79
- x — Existing fence line
- - - - - Easement line
- - - - - Centerline
- - - - - Creek
- ▨ Area to be dedicated to the public

NARRATIVE

This subdivision was done at the request of Ron Puckett, President of Cherry Crest Farms, Inc. The subdivision was processed under a Measure 37 application. Cherry Crest Farms also owns the land adjacent to the East and South of the subdivision. I use survey number 010-2001 to subdivide Section 14. This differs slightly from survey number 40-79, which was the first survey to subdivide the section. The North line of the Westerly portion of Lot 2 is the center of the Spring Branch as called for by deed and documented by survey number 49-81. The Southerly line of that portion of Lots 1 and 2 within the Northwest quarter of Section 14 is the centerline of Murphy Creek, as called for by deed and documented by Minor Partition Plat Number 1993-02. The West line of Lots 1 and 2 is the centerline of Stackland Road, documented by survey numbers 49-81 and Partition Plat Number 1993-02. The North line of Lots 3, 4, 5 and 6 is the North line of Section 14, which is also the centerline of Fletcher Lane. This subdivision dedicates a 30 ft. strip of land along the North line of Section 14, and the Easterly portion of Stackland Road. I place the dividing lines of the interior lots at the direction of Mr. Puckett. The easements shown were also created at his direction. Cherry Crest Farms, Inc. intends to retain the right to dedicate to the public the 60 ft. easement along Murphy Creek as shown. I find no unusual conditions on this subdivision.

SURVEYOR'S EXACT COPY STATEMENT

I, Rick G. Robinson, registered Oregon Surveyor No. 2219, do hereby certify that I am the Surveyor who prepared the Plat of TIMBER CREST ESTATES and that the annexed tracing is an exact copy of said Subdivision Plat as the same is on file in UNION COUNTY Cabinet Number C 825-826 of the Plat Records of UNION COUNTY, and said exact copy is submitted as per O.R.S. 92.120.

Rick G. Robinson
Rick G. Robinson, OPLS 2219

REFERENCE MATERIAL

- Union County Monumentation Records
 - Survey Number 38-75
 - Survey Number 40-79
 - Survey Number 5-80
 - Survey Number 49-81
 - Survey Number 039-1992
 - Survey Number 010-2001
- Minor Partition Plat Number 1993-02
- Partition Plat Report Number 06-17463 prepared by Eastern Oregon Title, Inc. dated May 12, 2006

REGISTERED
PROFESSIONAL
LAND SURVEYOR

Rick G. Robinson

OREGON
JULY 17, 1986
RICK G. ROBINSON
2219

Renewal Date: Dec. 31, 2006

Timber Crest Estates

Microfilm Number 20064205T
Plat Cabinet Number 825-826

A Subdivision situated in the North Half of Section 14,
Township 3 South, Range 40 East of the Willamette Meridian
Union County, Oregon.

SURVEYOR'S CERTIFICATE

I, Rick G. Robinson, OPLS 2219, hereby certify that I have correctly platted the land represented on the attached plat of TIMBER CREST ESTATES in accordance with O.R.S. Chapter 92, said subdivision being situated in the North half of Section 14, Township 3 South, Range 40 East of the Willamette Meridian, the exterior of which being more particularly described as follows,

Beginning at the North quarter corner of said Section 14,

Thence; North 89°45'20" East, along the North line of said Section 14, a distance of 1515.71 feet,

Thence; South, a distance of 702.92 feet,

Thence; South 58°58'11" West, a distance of 612.68 feet,

Thence; South, a distance of 187.18 feet,

Thence; South 65°47'53" West, a distance of 166.27 feet,

Thence; South 69°49'49" West, a distance of 105.18 feet,

Thence; South 83°06'03" West, a distance of 85.64 feet,

Thence; South 65°39'53" West, a distance of 134.95 feet,

Thence; South 80°01'11" West, a distance of 524.63 feet,

Thence; North 80°15'17" West, a distance of 14.35 feet, to the East line of the Northwest quarter of said Section 14,

Thence; South 0°03'31" East, along said East line, a distance of 142.80 feet, to the centerline of Murphy Creek,

Thence along said centerline the following courses:

S67°15'33"W, a distance of 61.41 feet,
N81°13'32"W, a distance of 53.68 feet,
S62°55'01"W, a distance of 80.07 feet,
S69°26'11"W, a distance of 58.87 feet,
N79°42'18"W, a distance of 51.13 feet,
S64°46'21"W, a distance of 25.15 feet,
S76°19'40"W, a distance of 46.41 feet,
S54°27'03"W, a distance of 9.55 feet,
S88°22'36"W, a distance of 121.63 feet,
N81°40'48"W, a distance of 65.48 feet,
S79°56'03"W, a distance of 85.20 feet,
S66°34'06"W, a distance of 99.53 feet,
S75°14'34"W, a distance of 27.95 feet,
S83°04'18"W, a distance of 75.70 feet,
S88°14'28"W, a distance of 95.99 feet,
N82°24'46"W, a distance of 94.37 feet,
S86°27'13"W, a distance of 62.84 feet,
N81°17'39"W, a distance of 52.32 feet,
S86°23'15"W, a distance of 70.54 feet,
N76°26'53"W, a distance of 56.47 feet,
S85°10'25"W, a distance of 92.85 feet,
N87°28'55"W, a distance of 90.56 feet,
S86°11'23"W, a distance of 57.20 feet,
N86°05'58"W, a distance of 60.21 feet,
S88°39'57"W, a distance of 94.88 feet, to the centerline of Stackland Road (Union County Road Number 120),

Thence; North 0°03'58" West, along said centerline, a distance of 611.84 feet, to the centerline of a spring branch,

Thence along said centerline the following courses:

N60°20'40"E, a distance of 23.00 feet,
N70°51'24"E, a distance of 30.79 feet,
N82°13'27"E, a distance of 50.21 feet,
N40°45'01"E, a distance of 27.21 feet,
S70°34'54"E, a distance of 64.73 feet,
N73°23'30"E, a distance of 36.54 feet,
S57°50'59"E, a distance of 29.49 feet,
N64°12'41"E, a distance of 30.11 feet,
N86°23'59"E, a distance of 69.81 feet,
S74°32'00"E, a distance of 34.56 feet,
S88°27'26"E, a distance of 74.12 feet,
N88°46'16"E, a distance of 74.55 feet,
S65°46'41"E, a distance of 43.47 feet,
S54°40'37"E, a distance of 53.28 feet,
N65°23'09"E, a distance of 72.77 feet,
S80°53'59"E, a distance of 76.33 feet,
N57°02'08"E, a distance of 36.77 feet,
N51°54'05"E, a distance of 74.69 feet,
N83°38'13"E, a distance of 83.35 feet,
(Continued next column)

SURVEYOR'S CERTIFICATE (Cont.)

(Continued from previous column)

N67°54'21"E, a distance of 52.42 feet,
N57°10'25"E, a distance of 78.10 feet,
N28°30'33"E, a distance of 28.55 feet,
N59°57'37"E, a distance of 55.20 feet, to a point 561 feet (34 rods) West of the East line of the Northwest quarter of said Section 14,

Thence; North 0°03'31" West, parallel with said East line, a distance of 936.06 feet, to the North line of said Section 14,

Thence; North 89°45'20" East, along the North line of said Section 14, a distance of 561.00 feet, to the Point of Beginning of this description.

Said tract containing 79.04 Acres, (including County Road Right of Way)

Said tract subject to the rights of the public to that portion of land lying within the rights of way of Fletcher Lane (County Road Number 122), and Stackland Road (County Road Number 120).

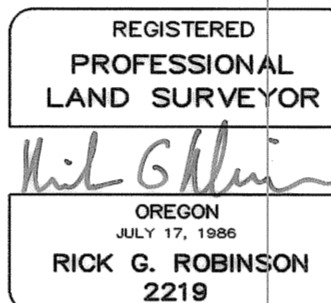

Rick G. Robinson, OPLS 2219
Bagett-Griffith & Blackman
2006 Adams Avenue
LaGrande, Oregon 97850



Renewal Date: Dec. 31, 2006

DECLARATION

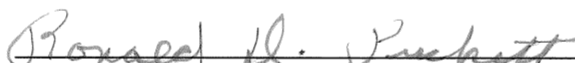
Know all people by these presents that CHERRY CREST FARMS, INC., an Oregon Corporation, is the owner of the land within this subdivision, said land being more particularly described in the accompanying Surveyor's Certificate, and has caused the same to be subdivided into the lots shown on the annexed map, and does hereby donate, dedicate, and convey to public use forever, the land within Fletcher Lane and Stackland Road, and do also hereby create the easements for the uses and with the restrictions, as depicted on the annexed map, in accordance with the provisions of O.R.S. Chapter 92. In witness whereof, CHERRY CREST FARMS, INCORPORATED, pursuant to the bylaws of said corporation, has authorized these presents to be signed by its President.



RONALD D. PUCKETT, President
CHERRY CREST FARMS, INCORPORATED

ACKNOWLEDGMENT

State of Oregon
SS

County of Union

Know all these people by these presents, on this 7th day of June, 2006, before me a Notary Public in and for said State and County, personally appeared RONALD D. PUCKETT, President of CHERRY CREST FARMS, INC., an Oregon Corporation, who being duly sworn, did say that he is the identical person named in the foregoing instrument, and that said instrument was executed freely and voluntarily.

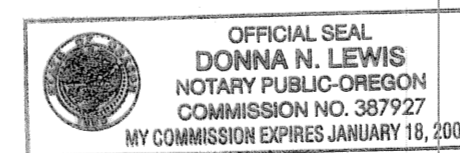

Notary Public for
the State of Oregon



Notarial Seal

SURVEYOR'S EXACT COPY STATEMENT

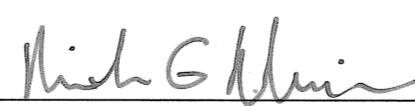
I, Rick G. Robinson, registered Oregon Surveyor No. 2219, do hereby certify that I am the Surveyor who prepared the Plat of TIMBER CREST ESTATES and that the annexed tracing is an exact copy of said Subdivision Plat as the same is on file in UNION COUNTY Cabinet Number 825-826 of the Plat Records of UNION COUNTY, and said exact copy is submitted as per O.R.S. 92.120.

Rick G. Robinson, OPLS 2219

APPROVALS

Union County Surveyor

Examined and recommended for approval as per O.R.S. Chapter 92 this 7th day of June, 2006.

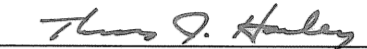
by 
Thomas J. Hanley, Baker County Surveyor
for the Union County Surveyor

Union County Planning Department

Approved this 14th day of August, 2006.

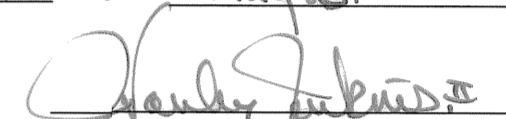
Hanley Jenkins, II
Union County Planning Director

Union County Assessor / Tax Collector

I hereby certify that pursuant to O.R.S. 92.095, all ad valorem taxes and all special assessments, fees and other charges required by law to be placed upon the 2005-2006 tax roll which became a lien on the land within this subdivision, or will become a lien during the tax year but not certified to the tax collector for collection have been paid.

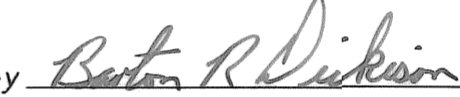
by 
Linda L. Hill, Union County Assessor/Tax Collector

UNION COUNTY COMMISSION

Approved this 16th day of August, 2006.

Steve McClure

John E. Lamoreau

Colleen MacLeod

FILING STATEMENT

Union County Clerk

State of Oregon
County of Union

I do hereby certify that the attached subdivision plat was received for record on the 16th day of August, 2006, at 9:20 o'clock A.M., and recorded in Plat Cabinet No. 825-826 Union County records. Microfilm Number 20064205T

R. Nellie Bogue Hibbert
Union County Clerk, by 