

# BASIS OF BEARING

Forward bearing as published by the U.S.C.  
and G.S. from  $\Delta$  COLLEGE to  $\Delta$  VALLEY  
Dated 1946.

SCALE: 1" = 30'

## LEGEND

- Found 5/8" iron pin with plastic cap marked BGA SURVEY MARKER, set by Survey Number 24-85
- Found lead plug with brass screw in curb for references to centerline as per Survey Number 028-2005
- Found 1/2" pipe set by survey number 35
- ▲ Found 5/8" iron pin with plastic cap marked BGA SURVEY MARKER, set by Partition Plat 1992-20
- ⊙ Found 2 1/2" brass cap set by Survey Number 028-2005
- Set 5/8"x30" iron pin with plastic cap marked BGB SURVEY MARKER
- ( ) Record measurement as per Partition Plat 1992-20
- Centerline
- Ⓜ Manhole

## REFERENCE MATERIAL

1922 remonumentation of La Grande  
Plat of Arnolds Addition  
Plat of Arnold and Dray's Addition  
Survey Number 35  
Survey Number 24-85  
Survey Number 09-89  
Survey Number 028-2005  
Partition Plat Number 1992-20

DEED REFERENCES  
Microfilm Document Number 20180620  
Microfilm Document Number 20180621

## NARRATIVE

This survey was done at the request of James McMahan, owner of the land within. The purpose of this survey is to monument the ownership of his land. I find monuments as shown and accept them in place unless otherwise noted. The common line was adjusted by a previous lot line adjustment. I find monuments of Partition Plat 1992-020 harmonious with platted measurements. Missing monuments I place at record bearing and distance. I place the adjusted line at 30 foot offset from the original parcel line. I find no unusual conditions with this survey.

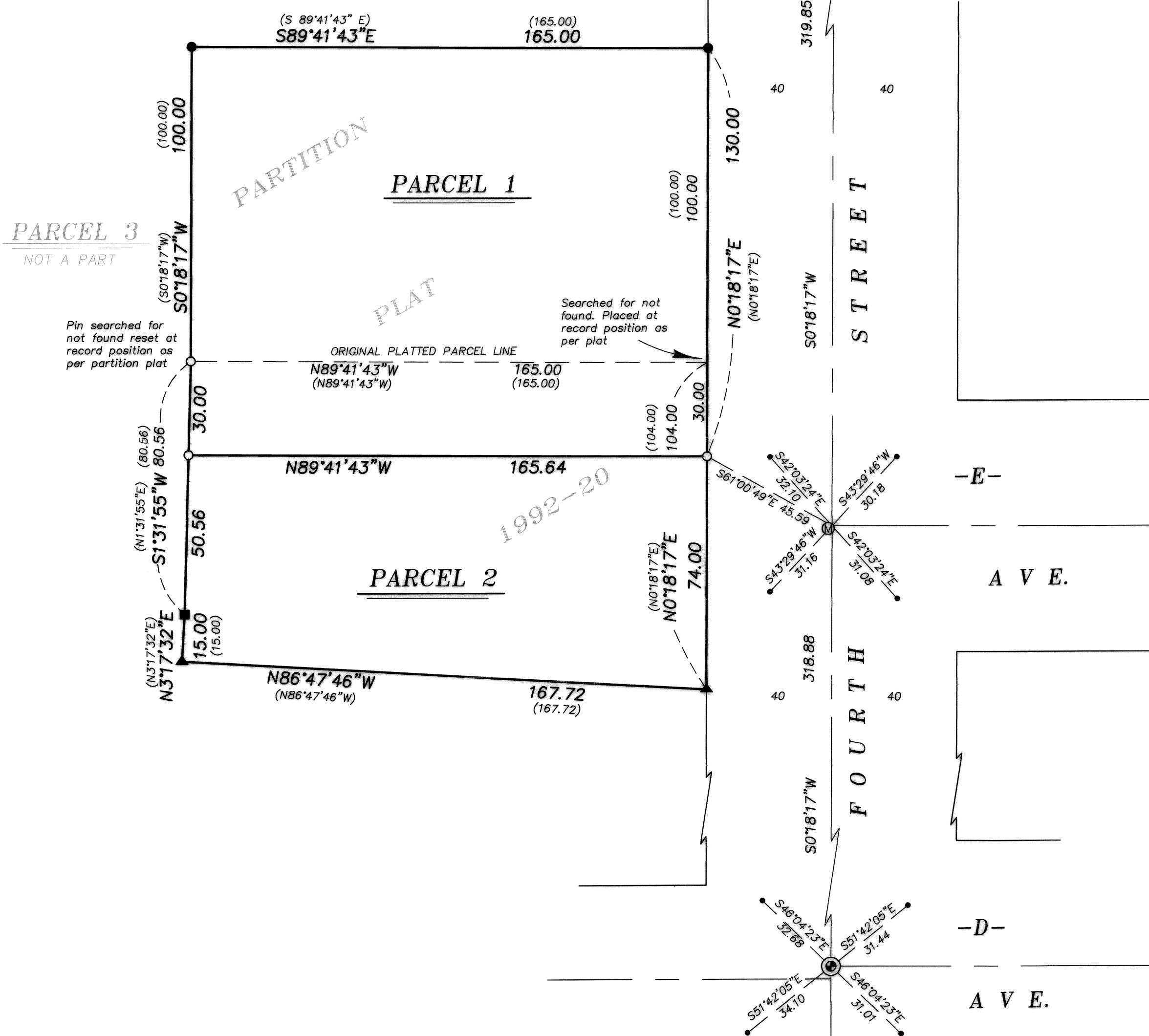

REGISTERED  
PROFESSIONAL  
LAND SURVEYOR

OREGON  
JUNE 2, 2010  
JEFFREY S. HSU  
83571

Renewal Date: June 30, 2019

UNION COUNTY  
SURVEYOR

Date Received 6/26/18  
Date Filed 6/26/18  
By J. S. H.  
File No. 026-2018

**BAGETT, GRIFFITH & BLACKMAN**  
2006 Adams Avenue, LaGrande, Oregon  
Map of Survey  
Adjusted line between Parcels 1 and 2 of Partition 1992-20.  
Situated in the NE 1/4 of the SE 1/4 of Section 7,  
Township 3 South, Range 38 East of the Willamette Meridian,  
City of La Grande

UNION COUNTY, OREGON

SURVEYED FOR	James McMahan
SURVEYED BY	J. S. H.
Scale: 1" = 30'	Drawn by: J. S. H. June 2018

SURVEY NUMBER 026-2018