

CERTIFIED RECORD OF LAND CORNER MONUMENTATION

History of original corner establishment:

NA

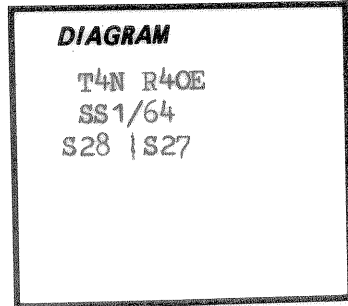

Description of corner evidence found:

NA

Description of monument and accessories I established to perpetuate the original location of this corner:

Set 2 1/2" X 30" Alum. pipe and cap with a magnet
 Marked: 10" Larch S47W 9.4' scribed SS1/64S28BT
 10" Larch S73E 4.0' scribed SS1/64S27BT

Stamped: T4N R4OE
 SS1/64
 S28 | S27
 1991
 LS 896

UNION COUNTY SURVEYOR
Date Received <u>1-21-92</u>
Date Filed <u>1-22-92</u>
By <u>Larry D. Bishop</u> Narrative Drawer
File No. <u>1/19</u>

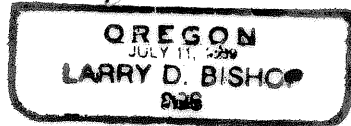
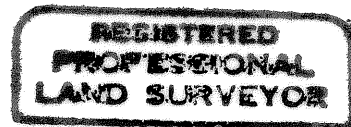

Office of..... County of.....
 State of....., I hereby certify that the within instrument was filed in this office
 for record on the..... day of....., 19.....
 by
 (COUNTY OFFICIAL) (DEPUTY)