

THIS MAP WAS PREPARED FOR ASSESSMENT PURPOSE ONLY

0 50 100 200 Feet

S.E. 1/4 N.E. 1/4 SEC. 15 T.1N. R.39E. W.M.  
UNION COUNTY  
1" = 100'

01N39E15AD  
ELGIN

CANCELLED:  
200  
200A1  
401  
500  
600  
700  
701  
1201  
1701

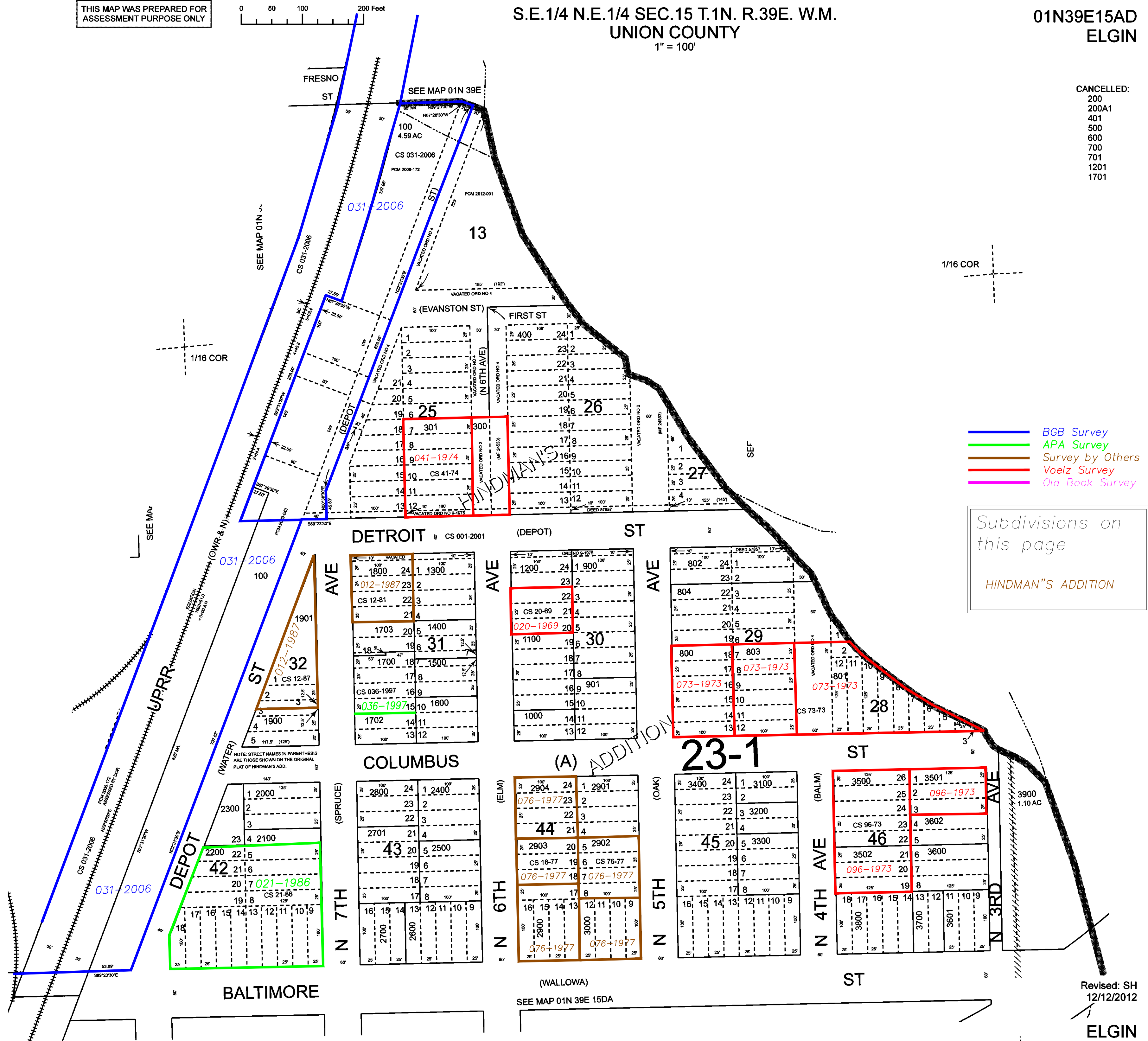

- BGB Survey
- APA Survey
- Survey by Others
- Voelz Survey
- Old Book Survey

Subdivisions on this page

HINDMAN'S ADDITION

Revised: SH  
12/12/2012

ELGIN  
01N39E15AD