

GEODETIC CONTROL DATA

OREGON STATE PLANE, NORTH ZONE (3601)
UNION COUNTY, OREGON

STA. NAME: 9914

SECTION CORNER:

GEODETIC COOR: NAD 83(91)

SEC 14 | 13

LAT: 45:23'02.92752" N

SEC.23 : 24 TWP.2 S. RGE. 38 E

UNION COUNTY, OREGON

LONG: 118:00'51.63064" W

DATE TIED: JULY, 1999

SURVEYOR: WALTER L. CASWELL
PLS 737

SP. COOR: NAD 83(91)

N: 635970.146 INT.FT

FIRM: EAGLE GPS SURVEY CORP
6110 SW LOMBARD AVE.
BEAVERTON, OR. 97008-4736
(503) 643-1073

E: 8840624.660 INT.FT.

THETA: 1:45'46.058"

TYPE: GPS

SCALE FACTOR: 0.999901635

ORDER: SECOND CLASS: 1

ELEV: 2724.53 U.S.FT.

ELEV. DATUM: NGVD 1929(1947)

DIRECTIONS "TO REACH":

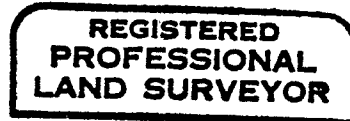

Albert Hertel 10-14-99

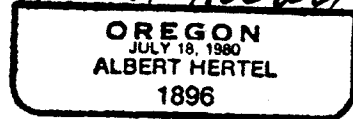

EXPIRES: 06/30/01

1 METER = 3.280833... U.S. FEET = 39.37 INCHES EXACTLY
1 METER = 3.280839895 INTL. FEET OR 1 INCH = 2.54CM. EXACTLY
TO CALCULATE ELEVATION FACTOR (IN THE NORTH AMERICAN CONTINENT)
DIVIDE 20,906,000 BY (20,906,000 + ELLIPSOID ELEV. IN FEET)

JOB 99-005

SHEET 36 OF 63

UNION COUNTY SURVEYOR

CERTIFIED RECORD OF LAND CORNER MONUMENTATION

HISTORY OF ORIGINAL CORNER ESTABLISHMENT:

Corner originally established by David P. Thompson under GLO contract Number 103, dated September 3rd, 1863. Surveyor General record states:

Set post for corner to secs 13,14,23,24 in mound of earth with pits trench charred stake as per instructions:

T 2 S R 38 E N - 21

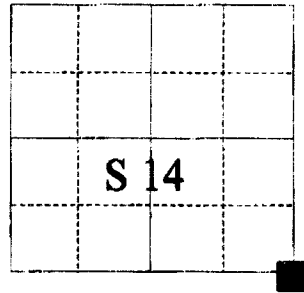

DESCRIPTION OF CORNER EVIDENCE FOUND:

No evidence remaining
SEE MINOR PARTITION for Koza, dated 12-99.

DESCRIPTION OF MONUMENT AND ACCESSORIES I ESTABLISHED

TO PERPETUATE THE ORIGINAL LOCATION OF THIS CORNER:

At the position of an ancient fence corner, I set a 2½" x 30" Aluminum pipe with cap marked as shown below, 42" in the ground from which:

A 5/8"x 30" iron rebar with aluminum cap bears N 54°18' E distance of 7.46 feet, marked NE RP, set 42" in the ground.

A 5/8"x 30" iron rebar with aluminum cap bears S 25°51' E, a distance of 10.32 feet, marked SE RP, set 42" in the ground.

A 5/8"x30" iron rebar with aluminum cap bears S 30°25'W, a distance of 11.90 feet, marked SW RP, set 42" in the ground.

A 5/8" x 30" iron rebar with aluminum cap bears N 59°29" W, a distance of 8.74 feet, set 42" in the ground.

I hereby certify that the corner was monumented on May 5, 1999.

Witness: Gregory T. Blackman, Jr. and Norbert Volney

REGISTERED
PROFESSIONAL
LAND SURVEYOR

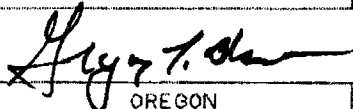

OREGON
JULY 13, 1973
GREGORY T. BLACKMAN
991

Renewal Date: Dec. 31, 1999

BAGETT - GRIFFITH & BLACKMAN

T2S R38E

S 14	S 13
S 23	S 24

1999
OPLS 991

**UNION COUNTY
SURVEYOR**

Date Received 8/24/00

Date Filed 8/24/00

Filed By R. Robison Deputy

File Number 017-2000R

I used a steel tape and magnetic compass in the establishment of the new accessories. I used 18° East declination. The distances are the center of each bearing object, unless otherwise noted above