

UNION COUNTY SURVEYOR

CERTIFIED RECORD OF LAND CORNER MONUMENTATION

HISTORY OF ORIGINAL CORNER ESTABLISHMENT:

Corner originally established by Rufus S. Moore under GLO contract Number 451, dated June 12, 1882. Surveyor General record states:

- Set basalt stone 15"x12"x5" with 2 notches on the South and 2 notches on the East: From Which: A 20" Pine bears N 70° E, 20 lks, marked T3S R35E S23 BT.
- A 7" Pine bears N 47° W, 31 lks. Marked T3S R35E S22 BT.
- A 9" Pine bears S 58° W, 30 lks. Marked T3S R35E S27 BT.
- A 10" Pine bears S 52°E, 36 lks. Marked T3S R35E S26 BT.

T 3 S R 35 E R - 17

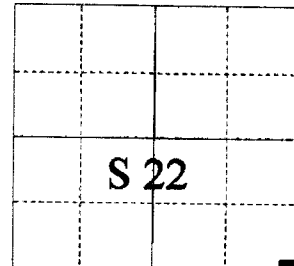

No record of subsequent monumentation found in Union County survey records.

DESCRIPTION OF CORNER EVIDENCE FOUND:

- Found 18"x13"x5" basalt stone marked with notches, at record position.
- Found badly rotted Pine stump, N 70°E, 20 lks.
- Found portions of SE BT lying on ground scribes visible, S 52°E, 36 lks.
- Found 7" Pine stump rotted, S 58°w, 30 lks., BT scribe visible

DESCRIPTION OF MONUMENT AND ACCESSORIES I ESTABLISHED

TO PERPETUATE THE ORIGINAL LOCATION OF THIS CORNER:

At record position and stone position, I set a 2½"x30" aluminum pipe with aluminum cap, marked as shown below, 26" in the ground and raised a stone mound with a 3 ft. Base to top of cap, Buried stone North of Cap, From which: A 5/8"x30" rebar with aluminum cap bears N 61°E, a distance of 13.20 feet, marked NE RP.

- A 14" Ponderosa Pine bears S 4°W, a distance of 317.20 feet marked X BT.
- A 19" Ponderosa Pine bears S 71°W, a distance of 301.20 feet, marked T3S R35E S27 BT
- A 7" Ponderosa Pine bears N 27°W, a distance of 153.80 feet, marked T3S R35E S22 BT

I hereby certify that the corner was monumented on October 16, 1998.
Witness: Gregory T. Blackman, Jr.

REGISTERED
PROFESSIONAL
LAND SURVEYOR

Gregory T. Blackman
OREGON
JULY 13, 1973
GREGORY T. BLACKMAN
991

Renewal Date: Dec. 31, 1999

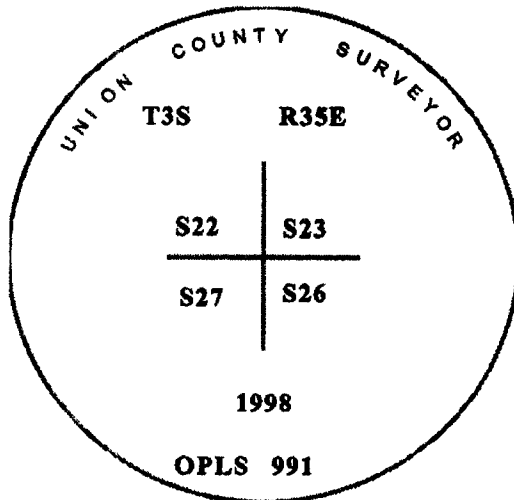

UNION COUNTY SURVEYOR

Date Received 10/20/98

Date Filed 10/20/98

Filed By R. Robinson, Deputy

File Number 089-1998K

I used a steel tape and magnetic compass in the establishment of the new accessories. I used 17° East declination. The distances are to a 60d spike driven into the root crown of the bearing tree. A brass washer marked OPLS 991 is attached to the BT blaze.

HORIZONTAL CONTROL DATA

UNION COUNTY, OREGON

OREGON STATE PLANE, NORTH ZONE (3601)

STA NAME: 2017007

SECTION CORNER COMMON TO SECTIONS 22, 23, 26 AND 27

TWP. 3 S. RGE. 35 E.

GEODETIC COORD: NAD 83(91)

DATE TIED: June 1, 2017

LAT: 45 ° 16 ' 54.98615 " N

SURVEYOR: RICK G. ROBINSON
OPLS 2219

LONG: 118 ° 24 ' 27.79287 " W

FIRM: BAGETT, GRIFFITH, & BLACKMAN
2006 ADAMS AVENUE
LAGRANDE, OR 97850
(541) 963-6092

SP. COOR: NAD 83(91)

N: 595856.290 INT FT.

E: 8740561.818 INT FT.

TYPE: GPS

THETA: 1 ° 29 ' 1.73597472 "

ORDER: SECOND CLASS: 1

SCALE FACTOR: 0.9998965294

ELEV: 3698.74 US FT.

ELEV: DATUM: NGVD 29

COMMENTS:

2 ½" aluminum monument marked as shown
4" exposed with mound of stone

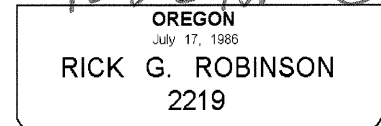
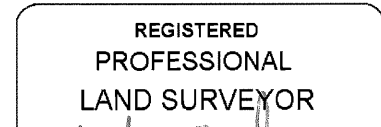
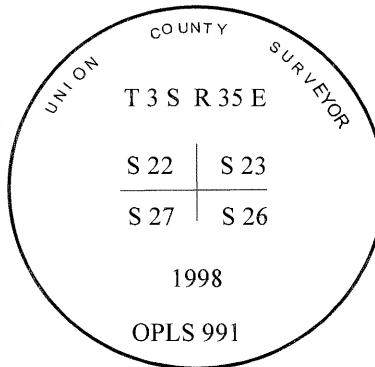

Renewal Date: December 31, 2018

1 METER = 3.2808333333... US FEET = 39.37 INCHES

1 METER = 3.280839895 INT'L FEET OR 1 INCH = 2.54 CM

TO CALCULATE ELEVATION FACTOR (IN THE NORTH AMERICAN CONTINENT)

DIVIDE 20,906,000 BY (20,906,000 + ELLIPSOID ELEV. IN FEET)