

RENEWAL

MONUMENT SET (PROCEDURE AND DESCRIPTION)

None  
\_\_\_\_\_  
\_\_\_\_\_  
\_\_\_\_\_  
\_\_\_\_\_  
\_\_\_\_\_  
\_\_\_\_\_  
\_\_\_\_\_  
\_\_\_\_\_  
\_\_\_\_\_  
\_\_\_\_\_

MONUMENT DETAIL

NEW ACCESSORIES

None  
\_\_\_\_\_  
\_\_\_\_\_  
\_\_\_\_\_  
\_\_\_\_\_  
\_\_\_\_\_  
\_\_\_\_\_  
\_\_\_\_\_  
\_\_\_\_\_  
\_\_\_\_\_  
\_\_\_\_\_

SKETCH OF MONUMENT, ACCESSORIES AND GENERAL AREA  
(IF NEEDED FOR CLARIFICATION)

LOCATION & COMMENTS

COMPASS DECLIN. May 6, 1985  
FIRM/AGENCY P. C. A.  
PARTY CHIEF N. Paullus  
WITNESSES Chet Saunders

SURVEYOR'S SEAL

REGISTERED  
PROFESSIONAL  
LAND SURVEYOR

*Norman J. Paullus*

OREGON  
JULY 17, 1901  
NORMAN J. PAULLUS JR.  
1952

**GOVERNMENT CORNER RESTORATION FORM**

CORNER NUMBER

TOWNSHIP 3 S, RANGE 38 E, SECTION(S) 7

G-3

COUNTY Union STATE Oregon DATE May 7, 1985

<b>UNION COUNTY SURVEYOR</b>	
Date Received	<u>6-11-85</u>
Date Filed	<u>6-17-85</u>
By	<u>G. LANGLITZ, DEPUTY</u>
File No.	<u>39-85R</u>

**CORNER DESIGNATION**

T3S, R38E

1/4 | 57

REFERENCES TO PRIOR RECORDS Modelaire Heights II Addition to La Grande

- REFER TO SURVEY NO. \_\_\_\_\_
- \_\_\_ CONDITION REPORT ONLY
- \_\_\_ NOT FOUND
- \_\_\_ RENEWED
- \_\_\_ SURVEYED IN

**THIS SPACE RESERVED FOR USE OF COUNTY SURVEYOR**

**MONUMENT(S) FOUND: (CONDITION AND SOURCE)**

2 1/2" pipe with brass cap off of the N. E. corner of residence at 708 Modelaire Drive. Set by plat of Modelaire Heights II addition to the City of La Grande. Good condition.

**MONUMENT DETAIL**

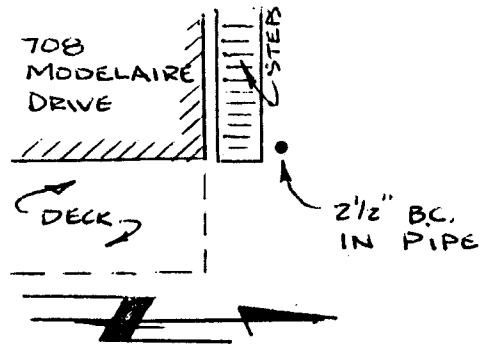

**ACCESSORIES FOUND: (CONDITION AND SOURCE)**

None

# HORIZONTAL CONTROL DATA

OREGON STATE PLANE, NORTH ZONE (3601)

LaGRANDE & ISLAND CITY, UNION COUNTY OREGON

STA. NAME: 9629

CENTER QUARTER

SEC. 7 TWP.3S, RGE.38E, W.M.

DATE FD.: MARCH, 1996

SURVEYOR: WALTER L. CASWELL  
PLS 737

FIRM: EAGLE GPS SURVEY CORP  
6110 S.W. LOMBARD AVE.  
BEAVERTON, OR. 97008  
(503) 643-1073

TYPE: GPS

ORDER: SECOND CLASS: 2

GEODETIC COOR: NAD 83(91)

LAT: 45°19'06.63243" N

LONG: 118°06'24.57311" W

SP. COOR: NAD 83(91)

N: 611332.412 INT.FT.

E: 8817582.885 INT.FT.

THETA: 1°41'49.940"

SCALE FACTOR: 0.999897991

ELEV: 2968.810 US.FT.

ELEV. DATUM: NGVD 29

\*\*\*\*\*  
DIRECTIONS "TO REACH"

*AMGUDG*

REGISTERED  
PROFESSIONAL  
LAND SURVEYOR

*Walter L. Caswell*

OREGON  
JULY 8, 1968  
WALTER L. CASWELL  
737

EXPIRES 12/31/97

1 meter = 3.280833... U.S. Feet = 39.37 inches exactly  
1 meter = 3.280839895 Intl. Feet or 1 inch = 2.54cm. exactly  
To Calculate Elevation Factor (in the North American Continent)  
Divide 20,906,000 by (20,906,000 + Ellipsoid Elev. in Feet)

JOB 96-007  
SHEET 46 OF 66

**HORIZONTAL CONTROL DATA**  
**UNION COUNTY, OREGON**  
**OREGON STATE PLANE, NORTH ZONE (3601)**

STA NAME: 9629

CENTER QUARTER 7

TWP. 3 S. RGE. 38 E.

GEODETIC COORD: NAD 83(91)

DATE TIED: MARCH 1996

LAT: 45 ° 19 ' 6.63243 " N

SURVEYOR: WALTER L. CASWELL  
PLS 737

LONG: 118 ° 6 ' 24.57311 " W

FIRM: EAGLE GPS SURVEY CORP  
6110 SW LOMBARD AVE.  
BEAVERTON, OR. 97008-4736  
(503) 643-1073

SP. COOR: NAD 83(91)

N: 611332.412 INT FT.

E: 8817582.885 INT FT.

TYPE: GPS

THETA: 1 ° 41 ' 49.940282 "

ORDER: SECOND CLASS: 2

SCALE FACTOR: 0.9998979909

ELEV: 2968.81 US FT.

ELEV: DATUM: NGVD 29

**COMMENTS:**

This sheet has been edited. The original coordinates came from an eccentric station and the convergence angle was applied the wrong way.

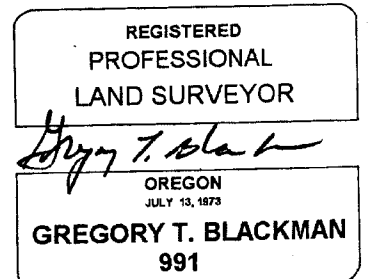

1 METER = 3.2808333333... US FEET = 39.37 INCHES

1 METER = 3.280839895 INT'L FEET OR 1 INCH = 2.54 CM

TO CALCULATE ELEVATION FACTOR ( IN THE NORTH AMERICAN CONTINENT)

DIVIDE 20,906,000 BY (20,906,000 + ELLIPSOID ELEV. IN FEET)