

CERTIFIED RECORD OF LAND CORNER MONUMENTATION

**HISTORY OF ORIGINAL CORNER ESTABLISHMENT:**

Corner was not set in the original survey.

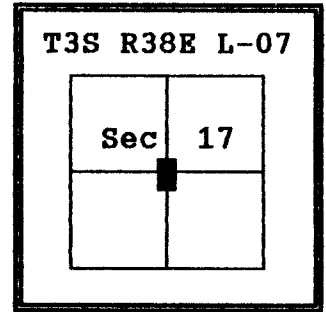

DIAGRAM

No record of subsequent monumentation found in Union County survey records.

**DESCRIPTION OF CORNER EVIDENCE FOUND:**

Not applicable.

See Map of Survey No. 022-1993.

**DESCRIPTION OF MONUMENT AND ACCESSORIES I ESTABLISHED TO PERPETUATE THE ORIGINAL LOCATION OF THIS CORNER:**

At position determined by survey, I set a 2 1/2" x 36" aluminum pipe with aluminum cap marked as shown, 33" in the ground in water valve box, from which:

A 5/8" x 30" rebar bears N 36° E, 10.18 feet, with 2" aluminum cap marked "UNION COUNTY SURVEYOR NE RP

A 5/8" x 30" rebar bears S 44° E, 10.50 feet, with 2" aluminum cap marked "UNION COUNTY SURVEYOR SE RP

A 5/8" x 30" rebar bears S 41° W, 55.81 feet, with 2" aluminum cap marked "UNION COUNTY SURVEYOR SW RP

A 5/8" x 30" rebar bears N 76° W, 41.86 feet, with 2" aluminum cap marked "UNION COUNTY SURVEYOR NW RP

I hereby certify that the above corner point was perpetuated as hereon described on June 24, 1993.

Witnesses: Jim Bennett  
Pete Crabtree

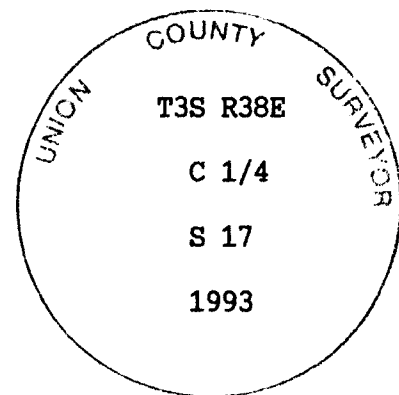

REGISTERED  
PROFESSIONAL  
LAND SURVEYOR

OREGON  
JULY 10, 1964  
DUANE I. GRIFFITH  
644

**UNION COUNTY SURVEYOR**

---

Date Received 6-30-93

Date Filed 6-30-93

By R. ROBINSON, DEPUTY

File No. 021-1993R

I used a steel tape and magnetic compass in the establishment of new accessories. I used 18° East magnetic declination and the distances are to the center of the caps on the rebar.

# HORIZONTAL CONTROL DATA

UNION COUNTY, OREGON  
OREGON STATE PLANE, NORTH ZONE (3601)

STA. NAME: 9316

CENTER SECTION

SEC.17 TWP. 3 S. RGE.38 E.

DATE SET: OCT. 1993

SURVEYOR: WALTER L. CASWELL  
PLS 737

FIRM: EAGLE GPS SURVEY CORP  
13545 NW SCIENCE PARK DR  
PORTLAND, OR. 97229  
(503) 643-1073

TYPE: GPS

ORDER: SECOND CLASS: 1

*CORNER  
MOVED  
SEE SURVEY  
NO. 020-2000  
AND MON.  
RECORDED  
009-2000R*

GEODETTIC COOR: NAD 83(91)

LAT: 45°18'14.50376" N

LONG: 118°05'11.04734" W

SP. COOR: NAD 83(91)

N: 606211.720 INT.FT.

E: 8822991.678 INT.FT.

THETA: 1°42'42.083"

SCALE FACTOR: 0.999897364

ELEV: 2950.60 US.FT.

ELEV. DATUM: NGVD 29

\*\*\*\*\*  
DIRECTIONS "TO REACH": FROM THE INTERSECTION OF HIGHWAY 82 AND ADAMS AVENUE IN LA GRANDE, HEAD SOUTH-EAST ON ADAMS AVENUE (U.S. 30), TOWARD UNION, TAKE A RIGHT ON CHERRY STREET AND GO ONE BLOCK. THEN TURN RIGHT ON WASHINGTON AVENUE AND GO ABOUT HALF A BLOCK BEFORE TAKING A SHARP LEFT TURN ONTO 12TH STREET. TRAVELING SOUTH ON 12TH STREET YOU WILL COME TO THE INTERSECTION WITH GEKELER LANE. THERE IS A MORMON CHURCH ON THE NORTH-WEST CORNER OF THE INTERSECTION. CONTINUE SOUTH ON 12TH STREET 0.55 MI TO THE CORNER. THE STATION IS A 5/8" IRON ROD WITH A 2 1/2" ALUMINUM CAP.

REGISTERED  
PROFESSIONAL  
LAND SURVEYOR

*Walter L. Caswell*

OREGON  
JULY 8, 1966  
WALTER L. CASWELL  
737

EXPIRES 12/31/95

1 METER = 3.280833333333... U.S. FEET = 39.37 INCHES  
1 METER = 3.280839895 INT'L FEET OR 1 INCH = 2.54 CM.  
TO CALCULATE ELEVATION FACTOR (IN THE NORTH AMERICAN CONTINENT)  
DIVIDE 20,906,000 BY (20,906,000 + ELLIPSOID ELEV. IN FEET)  
SHEET 17 OF 37

**HISTORY OF ORIGINAL CORNER ESTABLISHMENT:**

Corner set by Survey No. 022-1993

At position determined by survey, I set a 2½" x 36" aluminum pipe with aluminum cap marked as shown, 33" in the ground in water valve box, from which:

- A 5/8" x 30" rebar bears N 36° E, 10.18 feet, with 2" aluminum cap marked "UNION COUNTY SURVEYOR NE RP
- A 5/8" x 30" rebar bears S 44° E, 10.50 feet, with 2" aluminum cap marked "UNION COUNTY SURVEYOR SE RP
- A 5/8" x 30" rebar bears S 41° W, 55.81 feet, with 2" aluminum cap marked "UNION COUNTY SURVEYOR SW RP
- A 5/8" x 30" rebar bears N 76° W, 41.86 feet, with 2" aluminum cap marked "UNION COUNTY SURVEYOR NW RP

T 3 S R 38 E L - 07

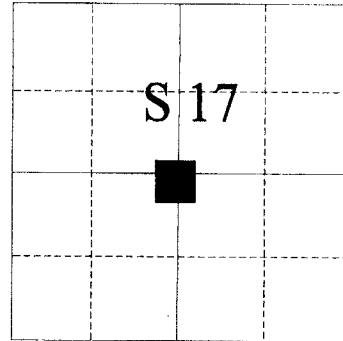

No record of subsequent monumentation found in Union County survey records.

**DESCRIPTION OF CORNER EVIDENCE FOUND:**

Found monument set by Survey No. 022-1993 away from true position as noted in Survey No. 020-2000

See Survey No. 020-2000

**DESCRIPTION OF MONUMENT AND ACCESSORIES I ESTABLISHED TO PERPETUATE THE ORIGINAL LOCATION OF THIS CORNER:**

At position determined by Survey No. 020-2000 I set a 2½" x 30" aluminum pipe with brass cap marked as shown, 32 inches in the ground in a water valve box, from which:

- A 5/8" x 30" rebar bears N 51°E, 7.90 feet, with 2" aluminum cap marked "UNION COUNTY SURVEYOR NE RP
- A 5/8" x 30" rebar bears S 43°E, 12.78 feet, with 2" aluminum cap marked "UNION COUNTY SURVEYOR SE RP
- A 5/8" x 30" rebar bears S 25°E, 39.80 feet, with plastic cap marked "BGA SURVEY MARKER"
- A 5/8" x 30" rebar bears N 85°W, 41.35 feet, with 2" aluminum cap marked "UNION COUNTY SURVEYOR NW RP"

I hereby certify that the above corner point was perpetuated as hereon described on April 4, 2000

Witnesses:

Norbert W. Volny, Gregory T. Blackman II

REGISTERED  
PROFESSIONAL  
LAND SURVEYOR

OREGON  
JULY 13, 1973  
GREGORY T. BLACKMAN  
991

Renewal Date: Dec. 31, 2001

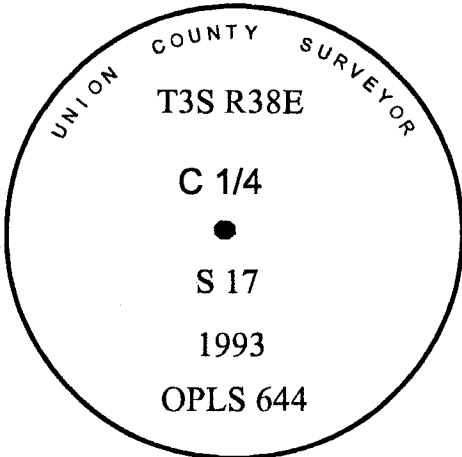

**UNION COUNTY SURVEYOR**

Date Received 8/9/00

Date Filed 8/10/00

Filed By R. ROBINSON Deputy

File Number 009-2000R

I used a steel tape and magnetic compass in the establishment of new accessories. I used 18° East magnetic declination and the distances are to the center of aluminum or plastic cap.

# HORIZONTAL CONTROL DATA

## UNION COUNTY, OREGON

### OREGON STATE PLANE, NORTH ZONE (3601)

STA NAME: 200909

CENTER QUARTER OF SECTION 17

TWP. 3 S RGE. 38 E.

GEODETIC COORD: NAD 83(91)

DATE TIED: March 12, 2009

LAT: 45 ° 18 ' 14.53410 " N

SURVEYOR: RICK ROBINSON  
OPLS 2219

LONG: 118 ° 5 ' 11.04832 " W

FIRM: BAGETT, GRIFFITH, & BLACKMAN  
2006 ADAMS AVENUE  
LAGRANDE, OR 97850  
(541) 963-6092

SP. COOR: NAD 83(91)

N: 606214.790 INT FT.

E: 8822991.517 INT FT.

TYPE: GPS

THETA: 1 ° 42 ' 42.1 "

ORDER: SECOND CLASS: 1

SCALE FACTOR: 0.999897364

ELEV: 2950.25 US FT.

ELEV: DATUM: NGVD 29

VOID  
MONUMENT  
RESET

**COMMENTS:**

Located in water valve box off East edge of oil of 12th Street, North of a gravel driveway and just West of the edge of a landscaped area

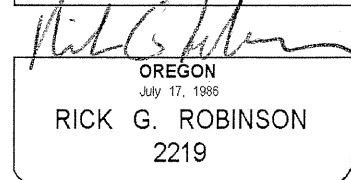
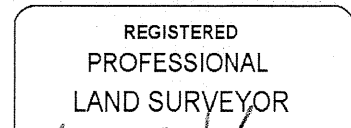
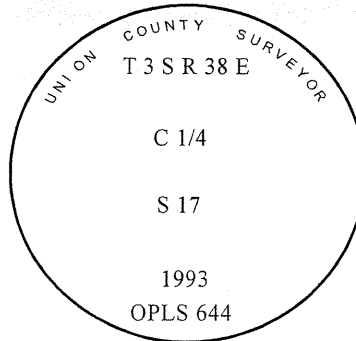

Renewal Date: December 31, 2010

1 METER = 3.2808333333... US FEET = 39.37 INCHES

1 METER = 3.280839895 INT'L FEET OR 1 INCH = 2.54 CM

TO CALCULATE ELEVATION FACTOR ( IN THE NORTH AMERICAN CONTINENT)

DIVIDE 20,906,000 BY (20,906,000 + ELLIPSOID ELEV. IN FEET)

**CERTIFIED RECORD OF LAND CORNER MONUMENTATION**

**HISTORY OF ORIGINAL CORNER ESTABLISHMENT:**

Corner originally set by Survey No. 022-1993.  
County monumentation record 021-1993R states:

At position determined by survey, I set a 2½" x 36" aluminum pipe with aluminum cap marked as shown, 33" in the ground in water valve box, from which:  
A 5/8" x 30" rebar bears N 36° E, 10.18 feet, with 2" aluminum cap marked "UNION COUNTY SURVEYOR NE RP"  
A 5/8" x 30" rebar bears S 44° E, 10.50 feet, with 2" aluminum cap marked "UNION COUNTY SURVEYOR SE RP"  
A 5/8" x 30" rebar bears S 41° W, 55.81 feet, with 2" aluminum cap marked "UNION COUNTY SURVEYOR SW RP"  
A 5/8" x 30" rebar bears N 76° W, 41.86 feet, with 2" aluminum cap marked "UNION COUNTY SURVEYOR NW RP"

T 3 S R 38 E L - 07

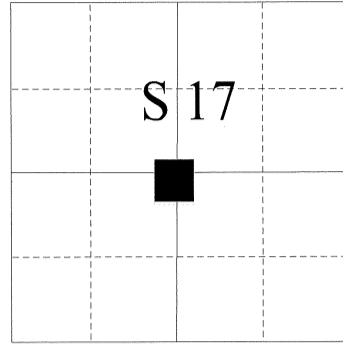

Corner reestablished by Survey Number 020-2000.  
County monumentation record 009-2000R states:

At position determined by Survey No. 020-2000 I set a 2½" x 30" aluminum pipe with brass cap marked as shown, 32 inches in the ground in a water valve box, from which:  
A 5/8" x 30" rebar bears N 51°E, 7.90 feet, with 2" aluminum cap marked "UNION COUNTY SURVEYOR NE RP"  
A 5/8" x 30" rebar bears S 43°E, 12.78 feet, with 2" aluminum cap marked "UNION COUNTY SURVEYOR SE RP"  
A 5/8" x 30" rebar bears S 25°E, 39.80 feet, with plastic cap marked "BGA SURVEY MARKER"  
A 5/8" x 30" rebar bears N 85°W, 41.35 feet, with 2" aluminum cap marked "UNION COUNTY SURVEYOR NW RP"

Corner was statically observed by GPS and incorporated in Union County GPS network as Station 200909, March 12, 2009.

**DESCRIPTION OF CORNER EVIDENCE FOUND:**

Construction along 12<sup>th</sup> Street removed all traces of the corner monument.

Found 5/8" iron pin South 28° East, a distance of 39.80 feet with yellow plastic cap marked BGA SURVEY MARKER from true corner point position.

See Survey Number 029-2010

**DESCRIPTION OF MONUMENT AND ACCESSORIES I ESTABLISHED**

**TO PERPETUATE THE ORIGINAL LOCATION OF THIS CORNER:**

At GPS network position, I set a 5/8" x 30" copperclad iron rod with 2 ½" brass cap, marked as shown, 33 in. in the ground, in a monument box, from which:

A brass screw in lead plug bears North 45°37'56" East, a distance of 4.59 feet, with brass washer marked OPLS 2219.

A brass screw in lead plug bears South 62°22'02" East, a distance of 3.66 feet, with brass washer marked OPLS 2219.

A brass screw in lead plug bears South 29°12'51" West, a distance of 54.30 feet, with brass washer marked OPLS 2219.

A brass screw in lead plug bears North 64°26'49" West, a distance of 29.24 feet, with brass washer marked OPLS 2219.

I hereby certify that the above corner point was monumented as hereon described on December 8, 2010

Witnesses: Jeff Hsu, Gregory T. Blackman Jr.

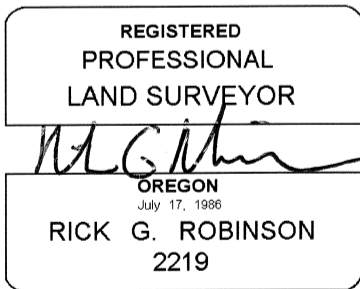

Renewal Date: December 31, 2012

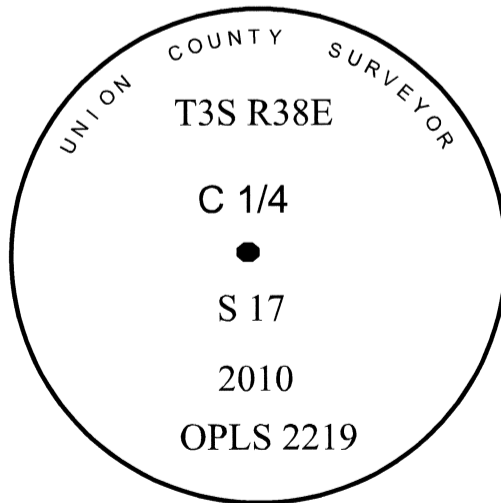

UNION COUNTY SURVEYOR  
Date Received 12/20/10  
Date Filed 1/17/11  
Filed By [Signature]  
File Number 041-2062

I used a Leica 1200 series RTK GPS and a Leica 1100 Total Station in the establishment of the accessories. Basis of bearing is as per Survey Number 029-2010, as filed in the Office of the Union County Surveyor. Measurement to the 5/8" iron pin was done by magnetic compass and steel tape. Magnetic declination is 15° East.

**HORIZONTAL CONTROL DATA**  
**UNION COUNTY, OREGON**  
**OREGON STATE PLANE, NORTH ZONE (3601)**

STA NAME: 201410

CENTER 1/4 CORNER OF SECTION 17

TWP. 3 S. RGE. 38 E.

GEODETIC COORD: NAD 83(91)

DATE TIED: May 14, 2014

LAT: 45 ° 18 ' 14.53583 " N

SURVEYOR: RICK G. ROBINSON  
OPLS 2219

LONG: 118 ° 5 ' 11.04657 " W

FIRM: BAGETT, GRIFFITH, & BLACKMAN  
2006 ADAMS AVENUE  
LAGRANDE, OR 97850  
(541) 963-6092

SP. COOR: NAD 83(91)

N: 606214.968 INT FT.

E: 8822991.636 INT FT.

TYPE: GPS

THETA: 1 ° 42 ' 42.0842712 "

ORDER: SECOND CLASS: 1

SCALE FACTOR: 0.9998973639

ELEV: 2950.42 US FT.

ELEV: DATUM: NGVD 29

**COMMENTS:**

Corner falls near East curb on 12th street in monument box

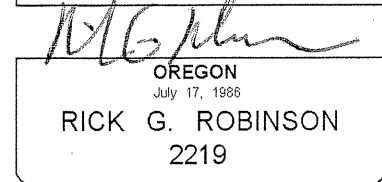
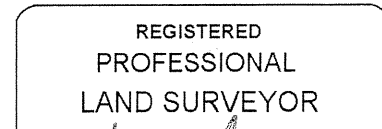
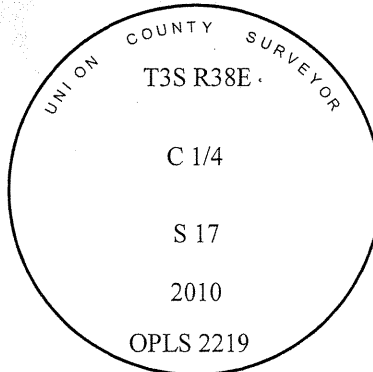

Renewal Date: December 31, 2014

1 METER = 3.280833333... US FEET = 39.37 INCHES

1 METER = 3.280839895 INT'L FEET OR 1 INCH = 2.54 CM

TO CALCULATE ELEVATION FACTOR ( IN THE NORTH AMERICAN CONTINENT)

DIVIDE 20,906,000 BY (20,906,000 + ELLIPSOID ELEV. IN FEET)