

CERTIFIED RECORD OF LAND CORNER MONUMENTATION

HISTORY OF ORIGINAL CORNER ESTABLISHMENT:

Corner originally established by Timothy W. Davenport under GLO contract Number 102, dated July 20th, 1863. Surveyor General record states: "Set post corner to secs 25, 36, 30 + 31 made mound of earth and drove charred stake as per inst"

Old Book Survey 4 Page 7 dated April 7th, 1887 by J.W. Kimbrell states, "Intersect west boundary at corner to sec 30=31=25+36..."

Oregon State Highway Dept. DRG. No. 6B-19-2, dated February 1946 states, "fence cor"

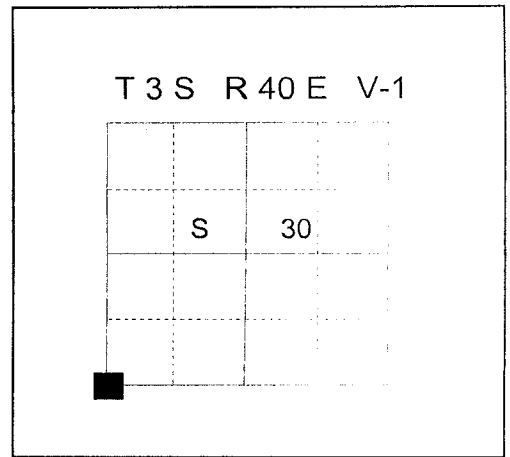

No record of subsequent monumentation found in Union County Survey Records.

DESCRIPTION OF CORNER EVIDENCE FOUND:

NONE

See Survey No. 003-2003

DESCRIPTION OF MONUMENT AND ACCESSORIES I ESTABLISHED

TO PERPETUATE THE ORIGINAL LOCATION OF THIS CORNER:

At an ancient fence corner I set a 2 1/2"x30" aluminum monument 30" in the ground, from which;

NEW BEARING OBJECTS:

- A 5/8"x30" iron pin with 1 1/2" aluminum cap in a fence line bears North, a distance of 10.20 feet, marked UNION COUNTY SURVEYOR NE RP
- A 5/8"x30" iron pin with 1 1/2" aluminum cap in a fence line bears East, a distance of 9.71 feet, marked UNION COUNTY SURVEYOR SE RP
- A 5/8"x30" iron pin with 1 1/2" aluminum cap in a fence line bears South, a distance of 7.50 feet, marked UNION COUNTY SURVEYOR SW RP
- A 5/8"x30" iron pin with 1 1/2" aluminum cap bears North 78° West, a distance of 10.90 feet, marked UNION COUNTY SURVEYOR NW RP

I hereby certify that the corner was monumented on December 10, 2002.

Witness: Norbert Volny, Gregory T. Blackman Jr.

REGISTERED
PROFESSIONAL
LAND SURVEYOR

Gregory T. Blackman
OREGON
JULY 13, 1973
GREGORY T. BLACKMAN
991

Renewal Date: December 31, 2003

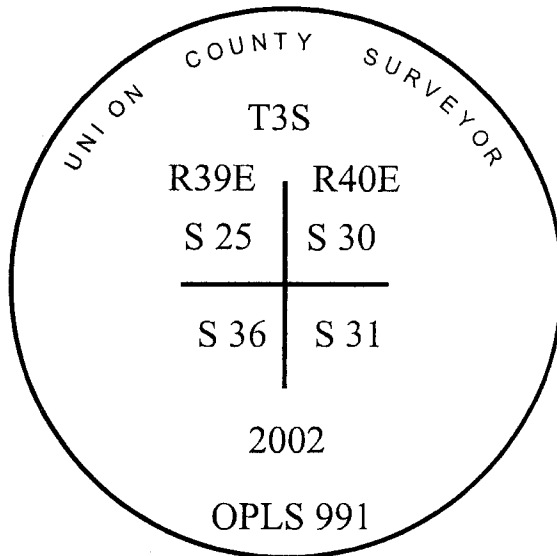

UNION COUNTY SURVEYOR

Date Received 2/18/03

Date Filed 2/18/03

Filed By R. ROBINSON, DEPUTY

File Number 006-2003R

I used a steel tape and magnetic compass in the establishment of the new accessories. I used 18° East declination. The distances to the accessories are to the center of the aluminum cap.

HORIZONTAL CONTROL DATA

UNION COUNTY, OREGON

OREGON STATE PLANE, NORTH ZONE (3601)

STA NAME: 200206

CORNER COMMON TO: 25,30,31,&36

TWP. 3 S. RGE. 39&40 E.

GEODETIC COORD: NAD 83(91)

DATE TIED: DEC. 2002

LAT: 45 ° 16 ' 4.28671 " N

SURVEYOR: GREGORY T. BLACKMAN
OPLS 991

LONG: 117 ° 52 ' 13.90998 " W

FIRM: BAGETT, GRIFFITH, & BLACKMAN
2006 ADAMS AVENUE
LAGRANDE, OR 97850
(541) 963-6092

SP. COOR: NAD 83(91)

N: 594764.285 INT FT.

E: 8878934.402 INT FT.

TYPE: GPS

THETA: 1 ° 51 ' 53.2186772 "

ORDER: SECOND CLASS: 1

SCALE FACTOR: 0.999896075

ELEV: 2693.36 US FT.

ELEV: DATUM: NGVD 29

COMMENTS:

Corner is a 2 ½" aluminum monument
near the East side of a fence corner

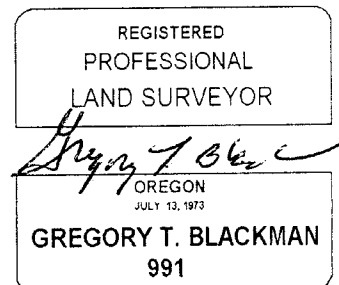
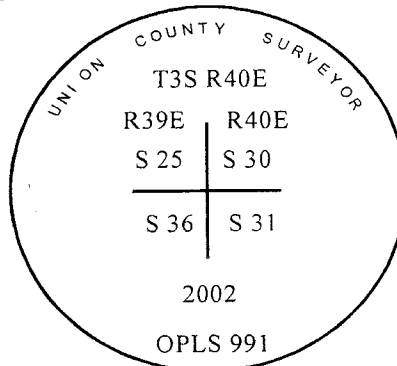

Renewal Date: December 31, 2003

1 METER = 3.2808333333... US FEET = 39.37 INCHES

1 METER = 3.280839895 INT'L FEET OR 1 INCH = 2.54 CM

TO CALCULATE ELEVATION FACTOR (IN THE NORTH AMERICAN CONTINENT)

DIVIDE 20,906,000 BY (20,906,000 + ELLIPSOID ELEV. IN FEET)