

CERTIFIED RECORD OF LAND CORNER MONUMENTATION

History of original corner establishment:

Corner not established in original survey

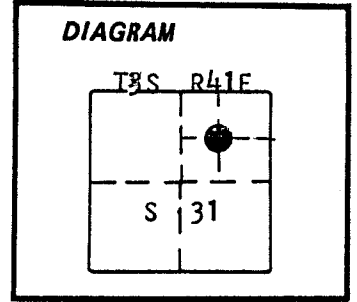

Description of corner evidence found:  
NONE

**UNION COUNTY  
SURVEYOR**

---

Date Received 10-20-86

Date Filed 10-27-86

By G. LANGRISH, DEPUTY

File No. 227-86 R

See map of survey number 29-86 filed in the office of the Union County Surveyor  
Description of monument and accessories I established to perpetuate the  
original location of this corner: At position determined by survey, I set a 2 1/2"x30"  
aluminum pipe with aluminum cap marked as shown, 28 inches in the ground from  
which:

A 9 inch Douglas Fir bears N 17° E, 10.32 feet, marked NE 1/16 S 31 BT.

An 8 inch White Fir Bears S 46° E, 5.66 feet marked X BT.

Set a steel fence post approximately 5 feet South with a 54-9 sign attached.

Corner set; 9/11/86

Witness: Greg Blackman, Rick Robinson

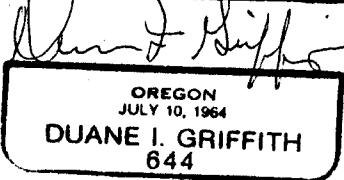
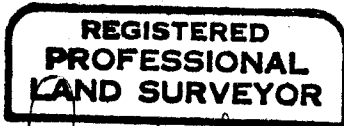
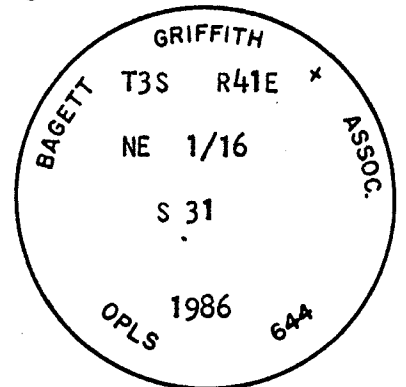

Brass washer marked OPLS 644 nailed to BT blaze. Used steel tape and magnetic compass with 20° East declination. Distances to the BTs are to a 50d spike set in right side of tree when facing tree, unless otherwise stated.

Office of..... County of.....  
 State of....., I hereby certify that the within instrument was filed in this office  
 for record on the..... day of....., 19.....  
 ..... by .....  
 (COUNTY OFFICIAL) (DEPUTY)

**CERTIFIED RECORD OF LAND CORNER MONUMENTATION**

**History of original corner establishment:**

Corner originally established me on Union County survey number 29-86. My remonumentation record states:

At position determined by survey, I set a 2½"x30" aluminum pipe with aluminum cap marked as shown, (markings shown below) 28 inches in the ground, from which;

A 9 inch Douglas Fir bears N17°E, 10.32 feet, marked NE1/16 S31 BT  
An 8 inch White Fir bears S46°E, 5.66 feet, marked X BT

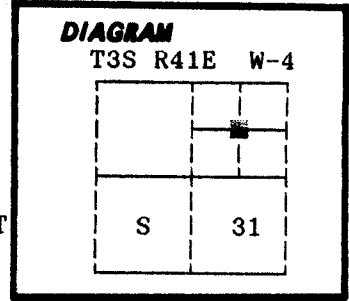

Corner set: 9/11/86  
Witness: Greg Blackman, Rick Robinson

Set a steel fencepost approximately 5 feet South with a 54-9 sign attached

No record of subsequent monumentation found in Union County survey records.

**Description of corner evidence found:**

Found the corner monument and accessories as stated above.

Due to an error in placing the proportioned South ¼ corner of Section 31 on Union County Survey Number 29-86, I rebreak Section 31 and move the monument as per Union County Survey Number 24-88. The new ties to the accessories are shown below.

UNION COUNTY SURVEYOR	
Date Received	<u>8-9-88</u>
Date Filed	<u>8-24-88</u>
By	<u>G. LANGLITZ, DEPUTY</u>
File No.	<u>91-88R</u>

**Description of monument and accessories I established to perpetuate the**

**original location of this corner:** At position determined by Union County Survey Number 24-88, I reset the above described monument 28 inches in the ground, from which;

New ties to the existing bearing trees:  
A 9 inch diameter Douglas Fir bears N19°E, 10.43 feet marked NE1/16 S31 BT  
A 8 inch diameter White Fir bears S46°E, 5.93 feet marked X BT

I hereby certify that the above corner point was perpetuated as hereon described on July 22, 1988.

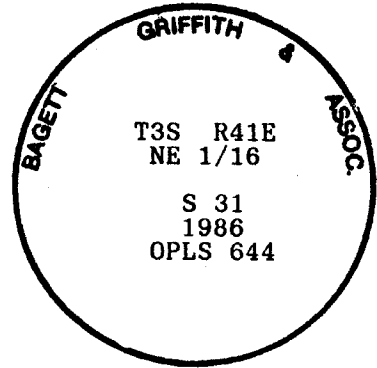

I used a steel tape and magnetic compass in the relocation of the existing accessories. I used 20° magnetic declination. The distances are to a 50d spike driven in the right side of the root crown.

Office of..... County of.....  
State of....., I hereby certify that the within instrument was filed in this office  
for record on the..... day of....., 19.....  
..... by .....  
(COUNTY OFFICIAL) (DEPUTY)