

CERTIFIED RECORD OF LAND CORNER MONUMENTATION

History of original corner establishment: Corner established by Rufus S. Moore under General Land office contract no. 451, dated June 12, 1882. Surveyor General Records states: Set a basalt stone 16" x 12" x 6", 11 inches in the ground for 1/4 section corner marked 1/4 on N face and raised a mound of stone alongside. Pits impracticable.

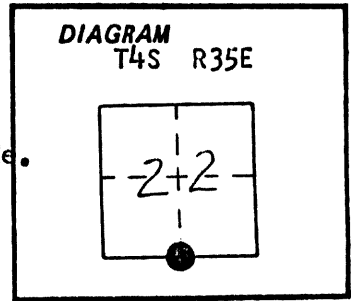

No record of subsequent remonumentation was found in County Records.

Description of corner evidence found:

Found marked stone of called size in small mound of stone.

UNION COUNTY SURVEYOR	
Date Received	<u>12-5-85</u>
Date Filed	<u>12-6-85</u>
By	<u>GLAUGHER, DEPUTY</u>
File No.	<u>168-85R</u>

See map of survey dated November 1985.

Description of monument and accessories established to perpetuate the original location of this corner: In place of stone, I set a 2 1/2" x 30" aluminum pipe with aluminum cap marked as shown, 20 inches in the ground with surrounding mound of stone, from which:

A 5/8" x 30" iron pin with plastic cap marked BGA Survey Marker bears S18°E, 11.06 feet

A 5/8" x 30" iron pin with plastic cap marked BGA Survey Marker bears West, 4.08 feet

Buried stone North

Set steel fence post approximately 5 feet East with 54-4 and 54-2 signs attached.

Set steel fence post approximately 5 feet West with 54-2 sign attached.

Corner set 10/19/85

Witness: Greg Blackman, Rick Robinson

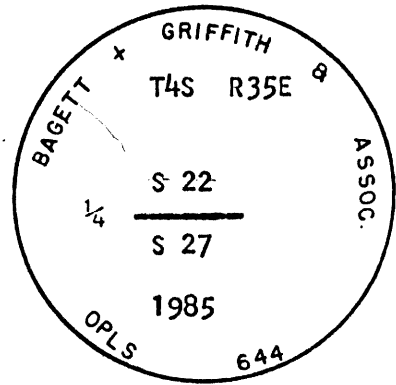

*Duane I. Griffith*



Brass washer nailed to RT blaze. Used steel tape and magnetic compass with 20° East declination. Measured to 50d spike set in right side of tree when facing tree, unless otherwise stated.

Office of..... County of.....  
State of....., I hereby certify that the within instrument was filed in this office  
for record on the..... day of....., 19.....

..... by .....  
(COUNTY OFFICIAL) (DEPUTY)

**CERTIFIED RECORD OF LAND CORNER MONUMENTATION**

**HISTORY OF ORIGINAL CORNER ESTABLISHED:**

Corner originally established by Rufus Moore under GLO contract number 451 dated June 12th, 1882. Surveyor General field notes state:

Set a basalt stone 16x12x6, 11 inches in the ground for 1/4 section corner marked 1/4 on N. face, and raised a mound of stone alongside, pits impracticable.

In 1985 Duane Griffith found the stone. Union County Monumentation Record 168-85R states: Found marked stone of called size in small mound of stone. In place of stone, I set a 2 1/2" x 30" aluminum pipe with aluminum cap marked as shown, 20" in the ground with surrounding mound of stone, from which:

A 5/8" x 30" iron pin with plastic cap marked BGA Survey Marker bears S18°E, 11.06 feet.

A 5/8" x 30" iron pin with plastic cap marked BGA Survey Marker bears WEST, 4.08 feet.

Buried stone NORTH

Set steel fence post approx. 5 ft. East with 54-4 and 54-2 signs attached.  
Set steel fence post approx. 5 ft. West with 54-4 and 54-2 signs attached.

T 4 S R 35 E R-15

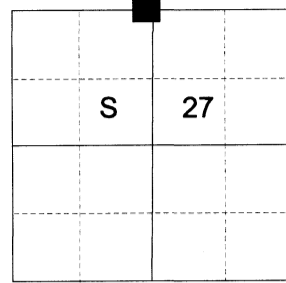

**DESCRIPTION OF CORNER EVIDENCE FOUND:**

Found a 2 1/2" aluminum pipe, 6" above ground, with 2 1/2" aluminum cap marked as shown below with 2 ft. diam. mound of stone, from which:

A 5/8" iron pin bears South 18° East a dist. of 11.05 ft., 1" above ground with no cap.  
A 5/8" iron pin bears West a dist. of 4.05 ft., with yellow plastic cap marked BGA SURVEY MARKER. Falls on East edge of fence post.

Falls 0.5 ft. North of East/West bearing fence line.  
Fence posts with yellow signs fall 4' West and 5' East.

**DESCRIPTION OF MONUMENT AND ACCESSORIES I ESTABLISHED TO PERPETUATE THE ORIGINAL LOCATION OF THIS CORNER:**

From the aluminum pipe monument:

**NEW BEARING OBJECTS:**

A 5/8" x 30" iron pin bears North 37°29' East a dist. of 28.69 ft., with 1 1/2" aluminum cap marked NE RP.

A 5/8" x 30" iron pin bears North 31°17' West a dist. of 27.62 ft., with 1 1/2" aluminum cap marked NW RP.

I hereby certify that the corner was perpetuated on December 11, 2020.

Witness: Kyle A. Tucker

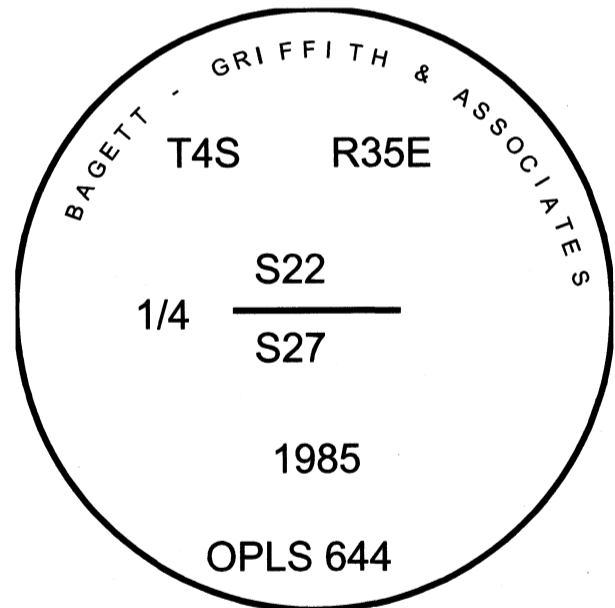

Renewal Date: June 30, 2021

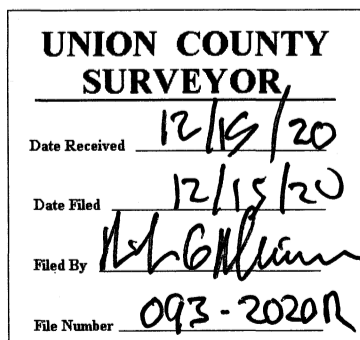

I used a Leica GS18 with RTK in the establishment of the new accessories. Basis of Bearing is derived from the Oregon Coordinate Reference System Pendleton-LaGrande. The distances and bearings are to the center of the aluminum caps.

**HORIZONTAL CONTROL DATA**  
**UNION COUNTY, OREGON**  
**OREGON STATE PLANE, NORTH ZONE (3601)**

STA NAME: 2020056

QUARTER CORNER COMMON TO SECTIONS 22 AND 27

TWP. 4 S RGE. 35 E.

GEODETIC COORD: NAD 83(91)

DATE TIED: December 11, 2020

LAT: 45 ° 11 ' 47.45192 " N

SURVEYOR: RICK G. ROBINSON  
OPLS 2219

LONG: 118 ° 24 ' 51.78522 " W

FIRM: BAGETT, GRIFFITH, & BLACKMAN  
2006 ADAMS AVENUE  
LAGRANDE, OR 97850  
(541) 963-6092

SP. COOR: NAD 83(91)

N: 564677.407 INT FT.

E: 8739650.951 INT FT.

TYPE: GPS

THETA: 1 ° 28 ' 44.7209309 "

ORDER: SECOND CLASS: 1

SCALE FACTOR: 0.9998946998

ELEV: 4077.61 US FT.

ELEV: DATUM: NGVD 29

**COMMENTS:**

2 1/2" aluminum pipe with 2 1/2" aluminum cap  
marked as shown.

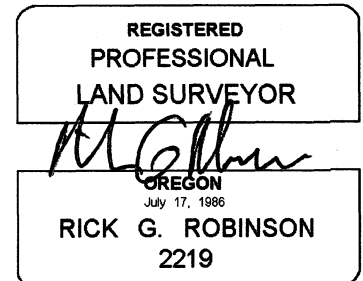
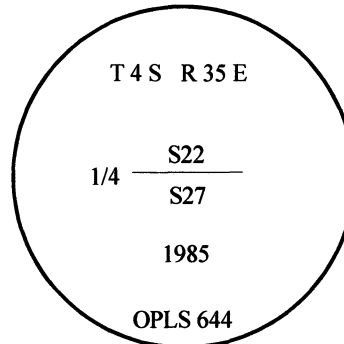

Renewal Date: December 31, 2020

1 METER = 3.280833333... US FEET = 39.37 INCHES

1 METER = 3.280839895 INT'L FEET OR 1 INCH = 2.54 CM

TO CALCULATE ELEVATION FACTOR ( IN THE NORTH AMERICAN CONTINENT)

DIVIDE 20,906,000 BY (20,906,000 + ELLIPSOID ELEV. IN FEET)