

for Thos. J. Chas McConnell April 8 1887

I Commenced at the Sp corner to T3854 S Ranges 39 & 40 E and Sec 1=6=31 & 36 a Stone said to be placed by Willis Stiff a former County Surveyor but there being no record kept of his work I Test the correctness by running to known corners and find it to be all right.

from this corner I run East on J.P. line var 20° E

- 40 00 Set Temporary 1/4 sec corner The original corner being out of place
- 60 50 Set Temporary 1/8 corner
- 80 35 Intersect 35 lks South of corner to Sec 5=6=31 & 32

from which I run S 89° 50' W

- 20 08 3/4 Set Stone 6 x 9 x 20 inches for 1/8 cor
- 40 17 1/2 Set Stone 9 x 12 x 20 for 1/4 sec corner between Sec 6 & 31
- 80 35 The corner to Sec 1=6=31 & 36

The corner to Sec 5=6=31 & 36 thence North var. 20° E

- 20 00 Set Temporary 1/8 corner
- 40 00 Set Temporary 1/4 sec corner The original corner being out of place
- 60 00 Set Temporary 1/8 corner
- 80 05 Intersect 165 lks West of corner to Sec 29=30=31 & 32 from which I run S 11 1/4° W var. 20° E

- 20 01 1/4 Set Stone 6 x 10 x 22 in for 1/8 cor
- 40 02 1/2 Set Stone 8 x 9 x 23 " for 1/4 sec corner bet Sec 31 & 32
- 60 03 3/4 Set Stone 8 x 8 x 16 " for 1/8 corner
- 80 05 The corner to Sec 5=6=31 & 32 a Post in Mid. of Stone

The corner to Sec 29=30=31 & 32 thence West var 20° E

- 20 00 Set Temporary 1/8 corner
- 40 00 Set Temporary 1/4 sec corner The old corner being out of place
- 82 75 Intersect West boundary at corner to Sec. 30=31=25 & 36 from which

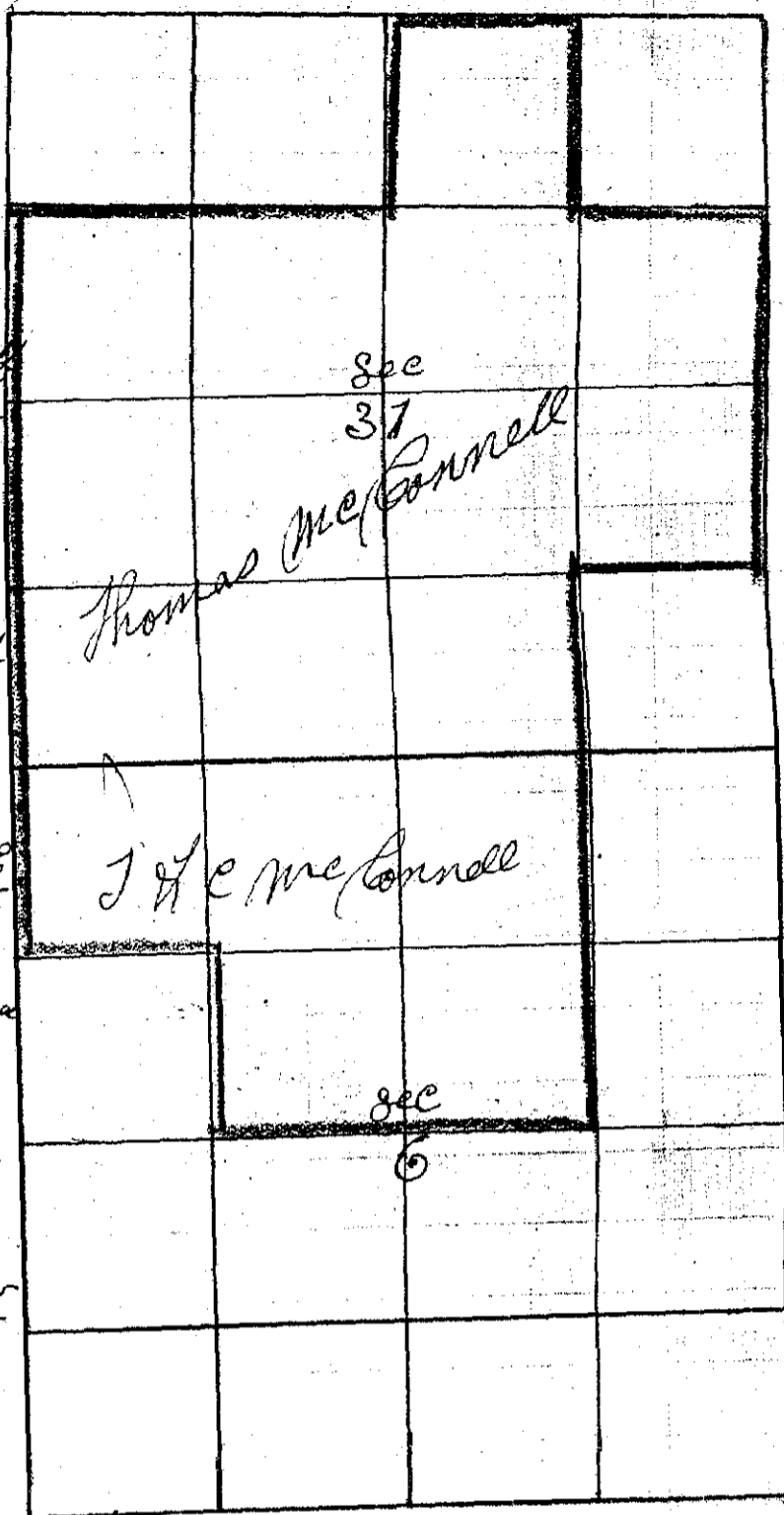

CHAINS.	LINKS.	
		<u>East on line var 20° E</u>
41	37	Set Stone 8 x 10 x 25 inches for 1/4 Sec corner bet Sec 30 & 31
61	96	Set Stone 8 x 9 x 20 " for 1/8 corner
82	75	The corner to Sec 29 = 30 = 31 & 32
		The corner to Sec 30 = 31 = 25 & 36
		<u>Thence South var 20° 15' E</u>
20	00	Set Temporary 1/8 corner
40	00	Set Temporary 1/4 Sec corner. The original corner being out of place
80	35	The corner to Sec 1 = 6 = 31 & 36
		<u>from which I run North on line</u>
40	17 1/2	Set Stone 6 x 10 x 22 " for 1/4 Sec corner bet Sec 31 & 36
60	26	Set Stone 8 x 9 x 18 for 1/8 corner
80	35	The corner to Sec 30 = 31 = 25 & 36
		The 1/4 Sec corner bet Sec 31 & 36
		<u>Thence East through center Sec 31</u>
40	00	Set Temporary Center Sec 31
81	25	Intersect East Boundary Sec 31 10 Mts South of 1/4 Sec corner
		The 1/4 Sec. corner bet Sec 30 & 31
		<u>Thence South through center Sec 31</u>
20	09	Set Temporary 1/6 corner
40	21	Intersect E & W line 10 Mts East of Tempory Center
80	25	The 1/4 Sec corner bet Sec 6 & 31
		<u>from which I run North var 20° E</u>
40	12	The center
60	15	The center N 1/2 Sec 31 a Stone 6 x 8 x 19 inches
80	25	The 1/4 Sec corner bet Sec 30 & 31
		The center N 1/2 Sec 31
		<u>Thence East var 20° E</u>
20	25	Set Stone 7 x 9 x 20 in for center N. E. 1/4 Sec 31
40	50	The 1/8 corner on E Bdy. N. E. 1/4
		The 1/8 corner on North Boundary N. E. 1/4 Sec 31
		<u>Thence South var 20° E</u>
20	02	The center N. E. 1/4 Sec 31
40	04	The center E 1/2 Sec 31
60	06	Set Stone 8 x 6 x 20 inches for center S E 1/4 Sec 31
80	09	The 1/8 corner on South Boundary S E 1/4 Sec 31.

CLAIMS LKS.

The corner to Sec 5=6=31 & 32
 Thence South bet Sec 5 & 6 var. 20° E.

40 30 U.S. Field Notes found no corner set post for cone
 Thence West var 20° E

20 00 Set Temporary 1/16 corner
 40 00 Set Temporary Center Sec 6
 60 00 Set Temporary 1/16 corner
 78 44 Intersect 1/2 line on West boundary Sec 6 bet 1/4 Sec one bet Sec 1 & 6
 Thence East var 20° E

19 61 Set Stone 6 x 9 x 18 for 1/16 cone in Center W 1/2 Sec 6
 39 22 Set Stone 8 x 10 x 20 for center Sec 6
 58 83 Set Stone 6 x 9 x 18 for 1/16 cone in center E 1/2 Sec 6
 78 44 Post for 1/4 Sec cone bet Sec 5 & 6

The 1/4 Sec corner bet. Sec 1 & 6.
 Thence North on Guide Meridian var 20° E

20 00 Set Temporary 1/8 corner
 40 30 The corner to Sec 1=6=31 & 36
 from which I run South on line

20 15 Set Stone 6 x 10 x 22 inches for 1/8 corner
 40 30 The 1/4 Sec corner bet Sec 1 & 6

The 1/8 corner on West boundary NW 1/4 Sec 6
 Thence East var. 20° E

19 89 Set Stone 6 x 9 x 16 inches for 1/16 corner in center
 N W 1/4 Sec 6
 Thence South var 20° E

20 20 The 1/16 corner in center W 1/2 Sec 6

J. W. Kimball Deputy Co. Surveyor