

For Charles Noyes Aug the 5, 1887

CHAINS. ISS.

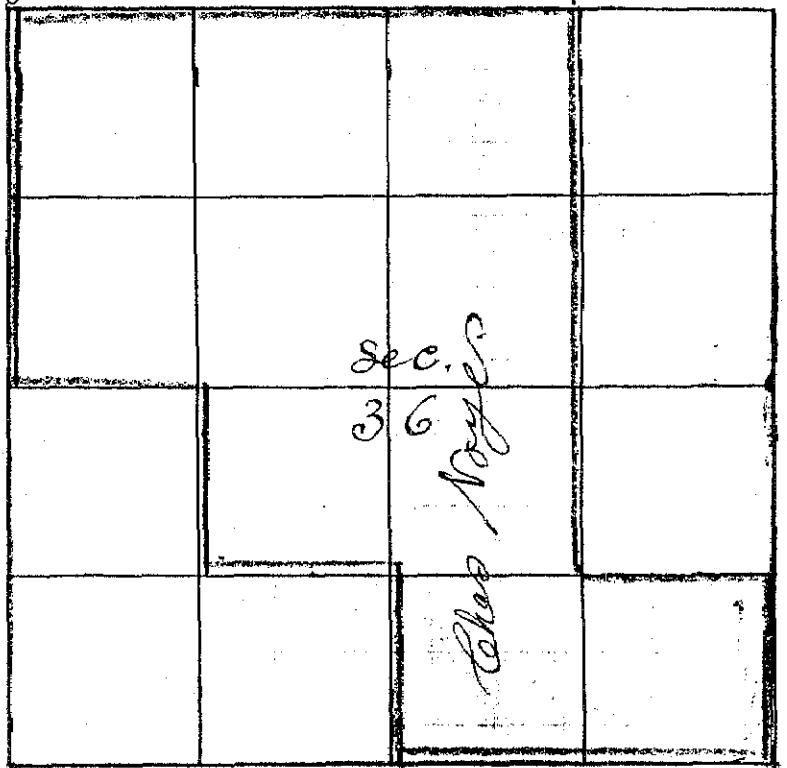

- I Commenced at the corner to
T^o 2 & 3 S Ranges 36 & 37 East
thence North bet Sec 3
31 & 36 Var. 20° E.
- 20 00 Set Temporary ¹/₈ corner
40 18 Intersect 21 lks west of the ¹/₄ Sec.
corner bet Sec 31 & 32
from which I run S 10' W
on true line Var 20° E
- 20 09 Set Post in Mound of Stone on South
Side of Steep Bluff from which
a Pine 14 inches dia brs N 78° W 125 lks dist.
" 18 " " " S 32° W 110 " "
- 23 00 Grande Round River 100 lks wide runs East
40 18 The corner to Sec 1-6 = 31 & 36
- The ¹/₄ Sec corner bet Sec 31 & 36
thence West on Random line through center Sec 36 Var 20° E
- 20 00 Set Temporary ¹/₁₆ corner
40 00 Set " ¹/₁₆ corner for center Sec 36
60 00 Set Temporary ¹/₁₆ corner
- 81 12 Intersect West Boundary 36 lks South of ¹/₄ Sec corner
bet Sec 35 & 36
- The ¹/₄ Sec corner bet Sec 25 & 36
thence South through center Sec 36 Var. 20° E
- 40 57 Intersect E & W line 22 lks west of center
60 00 Set Temporary ¹/₁₆ corner
- 81 13 The ¹/₄ Sec corner bet Sec 1 & 36
thence North on line
- 20 28 Set Post in Mound of Stone from which
a Pine 8 inches dia brs S 9° W 45 lks dist.
" 10 " " " N 86° 15' W 39 " "
- 40 57 The Center Set Post for center ¹/₁₆ corner
from which
a Pine 7 inches dia, brs N 52° 30' E 25 lks dist
" 14 " " " S 70° 45' W 10 " "
- 81 13 The ¹/₄ Sec corner bet Sec 25 & 36

The 1/4 Sec corner bet Sec 35 & 36

Thence S 89° 45' E

20 45 Set Post in Mound of Stone for 1/6 corner in center w 1/2 Sec 36
40 90 from which

a Pine 20 inches dia. bcs N 40° 30' W 90 lks dist.

" 3 " " " S 16° 45' E 42 " "

40 90 The center Sec 36

61 01 Set Post for 1/6 corner in center E 1/2 Sec 36 from which

a Pine 20 inches dia. bcs S 81° 30' E 19 lks dist.

" " " " S 85° W 75 " "

81 12 The 1/4 Sec corner bet Sec 31 & 36

The corner to Sec 25 = 36 = 30 & 31

Thence West bet Sec 25 & 36 var 20° E

ascend very steep Mountain Side Slopes to the N E

20 00 Set temporary 1/8 corner

40 06 The 1/4 Sec corner bet Sec 25 & 36

Thence East on line

20 03 Set Post in Mound of Stone for 1/8 corner from which

a Pine 14 inches dia. bcs S 41° W 110 lks dist.

" 13 " " " N 81° W 77 " "

40 06 The corner to Sec 25 = 36 = 30 & 31

The 1/8 corner on North Boundary N E 1/4 Sec 36

Thence South var 20° E

20 00 Set temporary 1/6 corner

41 04 The 1/6 corner in center E 1/2 Sec 36 from which

I run North var 20° E

20 52 Set Post in Mound of Stone from which

a Pine 8 inches dia. bcs N 18 1/4° W 44 lks dist.

" 7 " " " N 3 1/4° E 29 " "

The 1/4 Sec corner bet Sec 1 & 36

Thence East bet Sec 1 & 36

20 00 Set temporary 1/8 corner

40 77 The corner to Sec 1 = 6 = 31 & 31 from which I run West

20 38 1/2 Set Stake for 1/8 corner from which

a Pine 8 inches diameter bcs S 61° 45' E 45 lks dist.

" 7 " " " N 9° 45' W 25 " "

20 07 Set Stake for 1/6 corner in center S 8 1/4 Sec 36 from which

a Pine 9 inches diameter bcs S 14° E 100 lks dist.

" 7 " " " N 49 3/4° E 96 " "

40 14 The center E 1/2 Sec 36