

Township 4 South

Range 38 East W. M.

Union County, Oregon.

O. P. Goodall Oct. 27 1887

Commenced at the corner to
Sec 2=3=34 & 35 on the line bet 13884
South Range 38 E.

a Post in mound of Stone
thence East var 20° E

- 20 00 Set temporary 1/8 corner
- 40 02 the 1/4 sec corner bet Sec 2 & 35 -
- Set a stone marked 1/4
- thence west on line
- Set post for 1/8 corner
- the corner to Sec 2=3=34 & 35 -

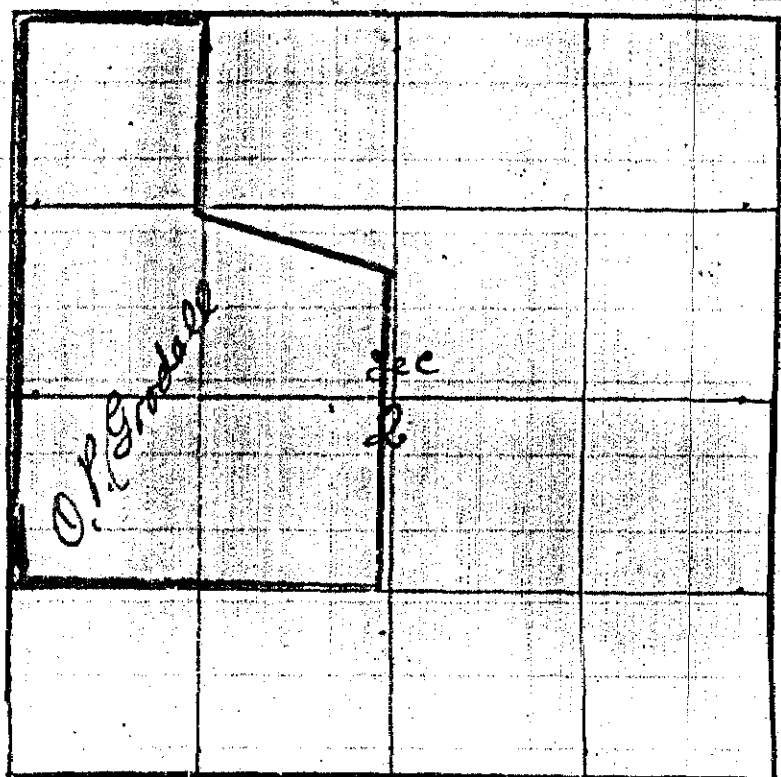

the 1/4 sec corner bet Sec 2 & 35 -

thence South through Sec 2 var 20° E

- 20 50 Set temporary 1/16 corner
- 40 50 Set temporary center Sec 2
- 60 00 Set temporary 1/16 corner

80 41 Intersect 30 lbs East of 1/4 sec corner bet Sec 2 & 11

Therefore the falling would be 7 1/2 lbs west to each 1/4 mile to line

the 1/4 sec corner bet Sec 2 & 3 a stone in mound of Stone

thence East through Sec 2 var 20° E

- 20 50 Set temporary 1/16 corner
- 40 50 Intersect 8 1/2 lbs line 20 lbs South of 1st Stake at center
- 80 18 the 1/4 sec corner bet Sec 1 & 2

Then started at the 1/4 sec corner bet Sec 2 & 11

thence North var 20° E

- 20 10 Set Post for 1/16 corner in center S 1/2 Sec 2
- 40 20 Set Post for center Sec 2
- 60 30 Set Post for 1/16 corner in center N 1/2 Sec 2

80 41 the 1/4 sec corner bet Sec 2 & 35 -

the corner to Sec 2=3=10 & 11

thence North var 21° E

- 20 50 Set temporary 1/8 corner
- 40 22 the 1/4 sec corner bet Sec 2 & 3

thence South

Set Post in mound of Stone for 1/8 corner

the 1/4 sec corner bet Sec 2 & 3

thence North var 20° E

Set Iron Bolt for 1/8 corner

the corner to Sec 2=3=34 & 35 -

the 1/8 corner on west side N W 1/4 Sec 2 thence East

Set Post for 1/16 corner for center N W 1/4 Sec 2

J. W. Kumbrell Dept. Co. Surveyor